



LEWGARS AVENUE, KINGSBURY, LONDON, NW9
OFFERS IN THE REGION OF £600,000 FREEHOLD

THREE BEDROOM END OF TERRACE BLANK CANVAS

Kingsbury | 020 8204 0000 | kingsbury@winkworth.co.uk

Winkworth

for every step...

winkworth.co.uk



An end of terrace blank canvas situated in a popular residential road Kingsbury nestled just off Slough Lane/ Church Lane. Making its appearance on the market for the first time in 33 years and ready for its new owners to put their personal modern mark on. Consisting of through lounge, a functional kitchen overlooking the garden, and a shower room on the ground floor. The upper-level hosts three well-proportioned bedrooms, and a family bathroom, whilst the front driveway allows off street parking for two cars. Considerable scope to extend (STPP), as well as a storage outbuilding in the garden. This house is positioned directly within the catchment area for reputable schools such as St Robert Southwell, Fryent Primary, Oliver Goldsmith Primary School and Kingsbury High. Kingsbury Station (Jubilee Line) and diverse range of amenities and places of worship are within walking distance. Stunning Fryent Country park lies a couple of minutes' wander away. Offered chain free. An internal viewing is a must to appreciate this property's potential and location at its entirety.



Winkworth

for every step...



Winkworth

for every step...

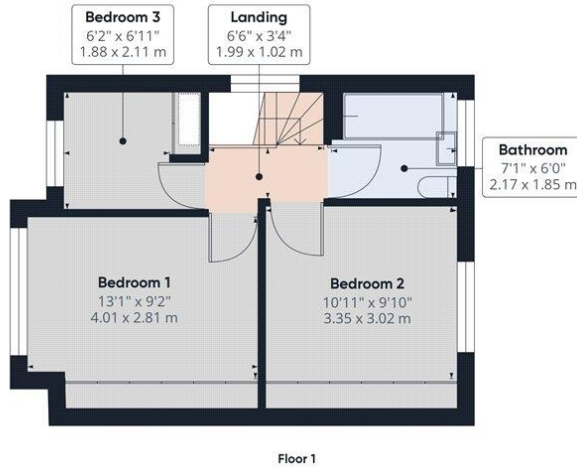
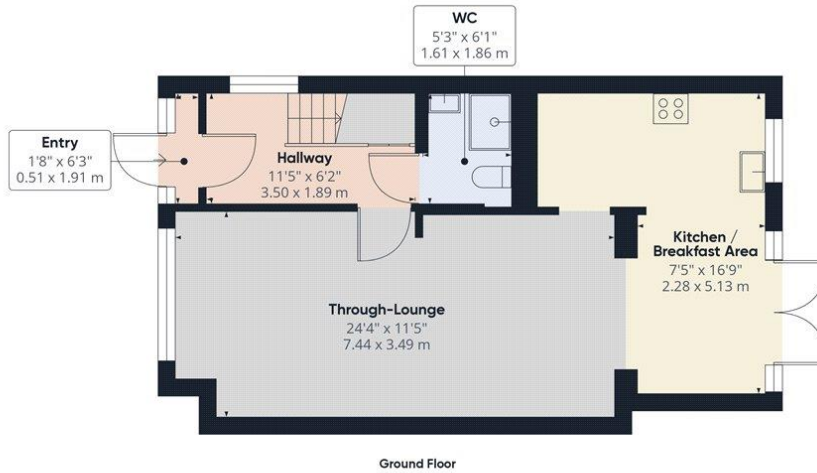

Approximate total area⁽¹⁾
 920.85 ft²
 85.55 m²

(1) Excluding balconies and terraces

While every attempt has been made to ensure accuracy, all measurements are approximate, not to scale. This floor plan is for illustrative purposes only.
 Calculations are based on RICS IPMS 3C standard.

GIRAFFE360

This floorplan is for illustration purposes only and is not to scale. The position and size of doors, windows, appliances and other features are approximate.

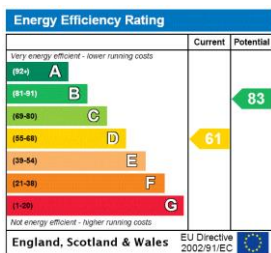

Tenure: Freehold

Council Tax Band: D

Where no figures are shown, we have been unable to ascertain the information. All figures that are shown were correct at the time of printing.

Kingsbury | 020 8204 0000 | kingsbury@winkworth.co.uk



for every step...

winkworth.co.uk

Winkworth wishes to inform prospective buyers and tenants that these particulars are a guide and act as information only. All our details are given in good faith and believed to be correct at the time of printing but they don't form part of an offer or contract. No Winkworth employee has authority to make or give any representation or warranty in relation to this property. All fixtures and fittings, whether fitted or not are deemed removable by the vendor unless stated otherwise and room sizes are measured between internal wall surfaces, including furnishings.