



BATHURST GARDENS, NW10
£2,100 PER MONTH UNFURNISHED

**SUPERBLY FINISHED GROUND FLOOR TWO
BEDROOM APARTMENT WITH GORGEOUS
LANDSCAPED GARDEN.**

Kensal & Queens Park | 0208 960 4947 | kensalrise@winkworth.co.uk

Winkworth

for every step...

winkworth.co.uk



DESCRIPTION:

Winkworth are delighted to offer back to the lettings market this beautiful ground floor garden flat. Comprises two spacious double bedrooms, large bay fronted reception with window shutters, modern kitchen and high spec shower room. The property has been tastefully decorated to the highest of standards and benefits with stunning hard wood flooring throughout. To the rear a south facing landscaped garden with patio area and access from both the rear bedroom and kitchen.

Surely one of the finest apartments currently on the market.

Council tax - (Band D)

Ward - Kensal Green

AT A GLANCE

- Recently fitted Howdens kitchen
- Hard wood flooring
- South facing landscape garden
- Two double bedrooms
- Bay fronted reception
- Wooden shutters
- Banham alarm system (additional cost)





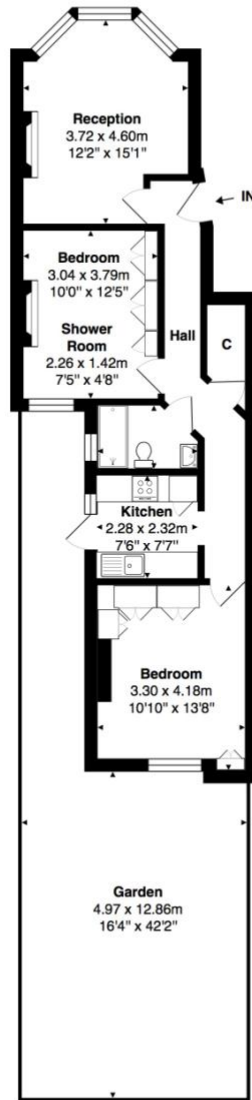

Ground Floor

Total Area: 61.5 m² ... 662 ft² (excluding garden)

All measurements are approximate and for display purposes only

This floorplan is for illustration purposes only and is not to scale. The position and size of doors, windows, appliances and other features are approximate.

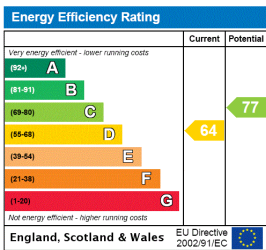

Kensal & Queens Park | 0208 960 4947 | kensalrise@winkworth.co.uk



for every step...

winkworth.co.uk

winkworth wishes to inform prospective buyers and tenants that these particulars are a guide and act as information only. All our details are given in good faith and believed to be correct at the time of printing but they don't form part of an offer or contract. No Winkworth employee has authority to make or give any representation or warranty in relation to this property. All fixtures and fittings, whether fitted or not are deemed removable by the vendor unless stated otherwise and room sizes are measured between internal wall surfaces, including furnishings.