



GROVE PARK, CAMBERWELL, LONDON, SE5
£400,000 LEASEHOLD

THIS SUPERB TOP FLOOR FLAT IS SITUATED WITHIN THIS BEAUTIFUL BUILDING ON GROVE PARK, JUST OFF CAMBERWELL GROVE.

DESCRIPTION:

The property is wonderfully bright and spacious and comprises a large double bedroom, separate modern kitchen, large separate reception room and a modern bathroom. There is also a communal garden and a bicycle shed and off street parking on a first come, first serve basis. The property couldn't be better located for easy access to the local bars and restaurants on Bellenden Road, Lordship Lane and Camberwell Grove. Transport links are provided via Denmark Hill or Peckham Rye with connections to the East London tube line.

AT A GLANCE

- Top Floor Flat
- One Double Bedroom
- Separate Kitchen
- Communal Garden
- Bicycle Shed
- Off Street Parking
- Chain Free
- Long Lease

Dulwich | 020 8299 2722 | dulwich@winkworth.co.uk

Tenure Leasehold | Council Tax Band C – London Borough of Southwark | Service Charge TBC | Ground Rent TBC

winkworth.co.uk

Winkworth

See things differently





Grove Park

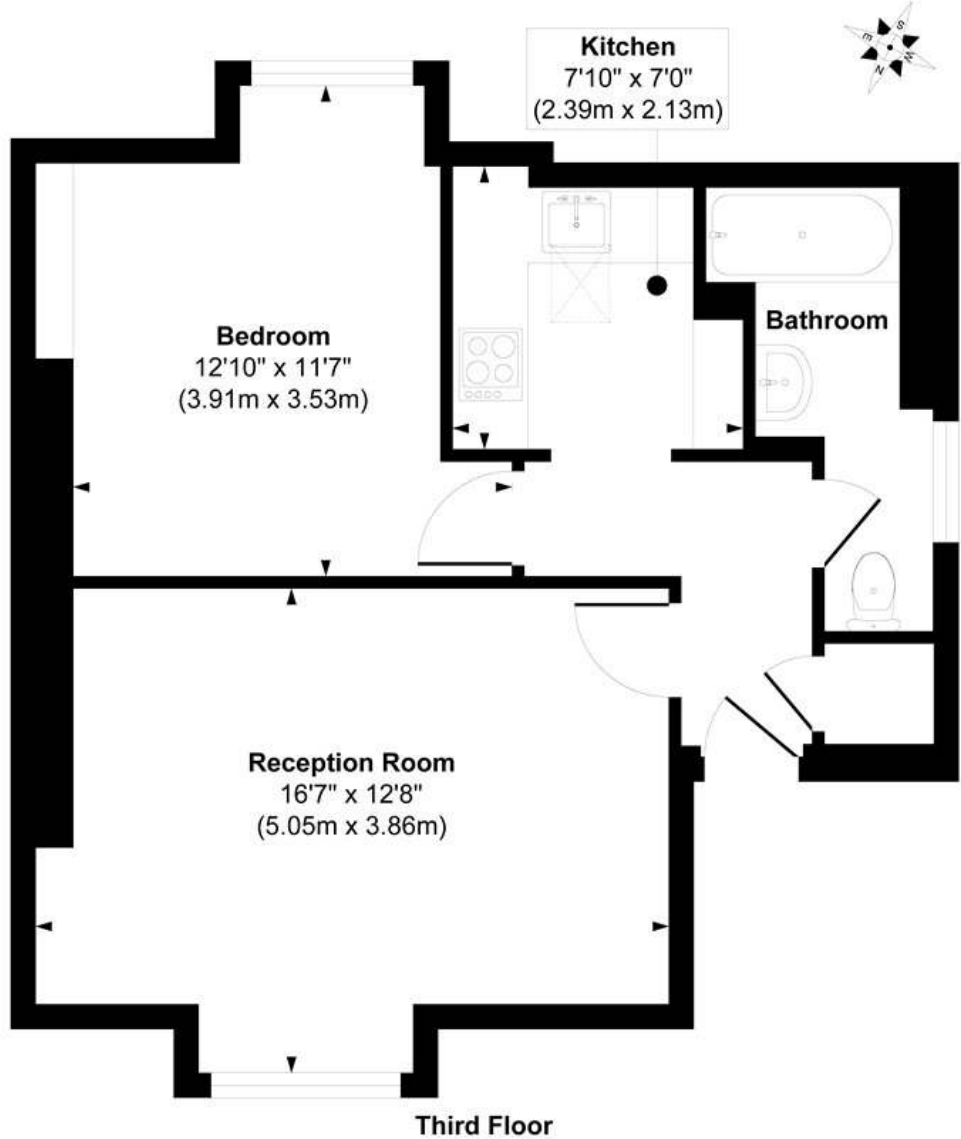

Approx. Gross Internal Floor Area 496 sq. ft / 46.00 sq. m
 Illustration for identification purposes only, measurements are approximate, not to scale.
 Produced by Elements Property

This floorplan is for illustration purposes only and is not to scale. The position and size of doors, windows, appliances and other features are approximate.

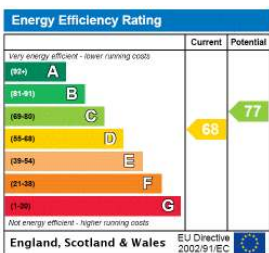

Dulwich | 020 8299 2722 | dulwich@winkworth.co.uk



winkworth.co.uk

See things differently

Winkworth wishes to inform prospective buyers and tenants that these particulars are a guide and act as information only. All our details are given in good faith and believed to be correct at the time of printing but they don't form part of an offer or contract. No Winkworth employee has authority to make or give any representation or warranty in relation to this property. All fixtures and fittings, whether fitted or not are deemed removable by the vendor unless stated otherwise and room sizes are measured between internal wall surfaces, including furnishings.