



Park Rise, KT22

£1,550 PER MONTH

UNFURNISHED

AT A GLANCE

- 2 bedrooms
- 2 bathrooms
- 1st Floor
- off street parking space
- close to town centre and station

Winkworth

for every step...



Energy Efficiency Rating		
	Current	Potential
Very energy efficient - lower running costs		
(92+) A		
(81-91) B		
(69-80) C	82	82
(55-68) D		
(39-54) E		
(21-38) F		
(1-20) G		
Not energy efficient - higher running costs		
England, Scotland & Wales	EU Directive 2002/91/EC	

PARK RISE, KT22

£1,550 PER MONTH
UNFURNISHED

PICTURES COMING SOON - Spacious first floor two bedroom apartment situated in a secure and central modern development. Located within close proximity to the town centre and mainline train station, this apartment offers space and light with a large entrance hallway, spacious family bathroom, open plan kitchen with integrated appliances, spacious living area, two well proportioned bedrooms with the master bedroom benefiting from an ensuit shower room. The apartment further benefits from allocated off-street parking to the rear of the development. Property is offered on an unfurnished basis and is available early November.

EPC Rating: B

Council Tax band D

HILL RISE COURT, PARK RISE, LEATHERHEAD, KT22

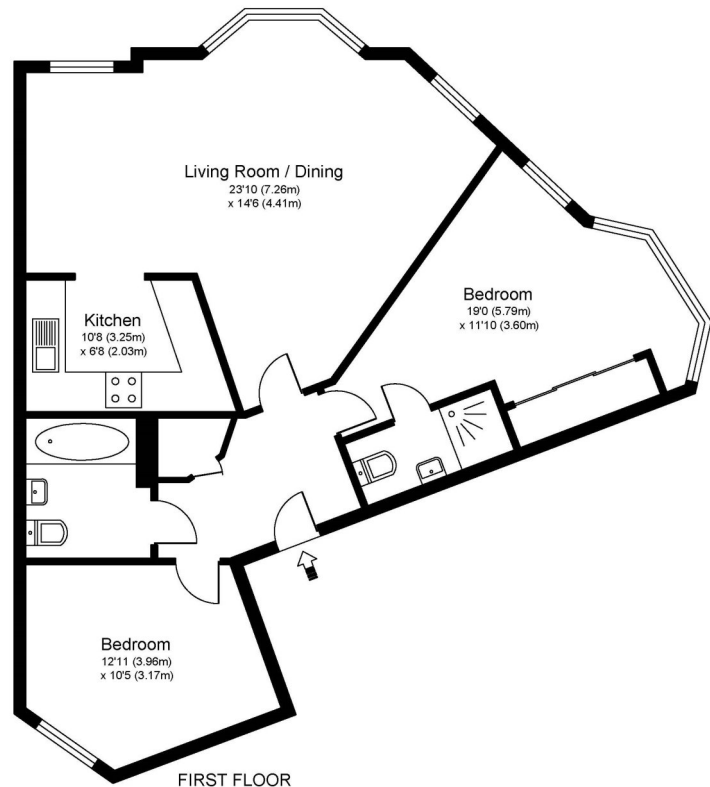

Approximate Gross Internal Floor Area: 72 m sq / 772 sq ft

Whilst every attempt has been made to ensure the accuracy of the floor plan contained here, measurements of doors, windows and rooms are approximate and no responsibility is taken for any error, omission or misstatements. These plans are not to scale and are for representation purposes only as defined by RICS Code of Measuring Practice and should be used as such by any prospective purchaser. Specifically no guarantee is given on total square footage of the property if quoted on this plan. Any figure given is for initial guidance only and should not be relied on as a basis of valuation.



Winkworth wishes to inform prospective buyers and tenants that these particulars are a guide and act as information only. All our details are given in good faith and believed to be correct at the time of printing but they don't form part of an offer or contract. No Winkworth employee has authority to make or give any representation or warranty in relation to this property. All fixtures and fittings, whether fitted or not are deemed removable by the vendor unless stated otherwise and room sizes are measured between internal wall surfaces, including furnishings.

Weybridge | 01932 854400 |
weybridge@winkworth.co.uk

winkworth.co.uk/weybridge

Winkworth

for every step...