



DORSET HOUSE, GLOUCESTER PLACE, MARYLEBONE, NW1
£625,000 LEASEHOLD

LOCATED ON THE FOURTH FLOOR, WITH A LONG LEASE, LIGHT AND WELL-PROPORTIONED ONE BEDROOM APARTMENT, IN THIS STRIKING AND HIGHLY SOUGHT AFTER, GRADE II ART DECO MARYLEBONE PORTERED BUILDING.

Paddington | 020 7467 5770 | paddington@winkworth.co.uk

Winkworth

for every step...

winkworth.co.uk



DESCRIPTION:

This apartment has a fabulous sense of arrival, as double entrance doors give access to the apartment. With a contemporary feel throughout with wooden floors, modern kitchen and bathroom, together with a well-proportioned south west facing bay fronted sitting room with an attractive fire place surround. Dorset House is situated in the heart of Marylebone and in close proximity to both Baker Street (about. 0.2 mile) and the popular Regent's Park (about. 0.2 mile). The nearest transport links include Marylebone Railway Station (about 0.2 mile) and Baker Street Underground Station (about 0.2 mile).

SERVICE CHARGE - ABOUT £6,500 PER ANNUM | GROUND RENT – ZERO | COUNCIL TAX BAND: D



Winkworth

for every step...

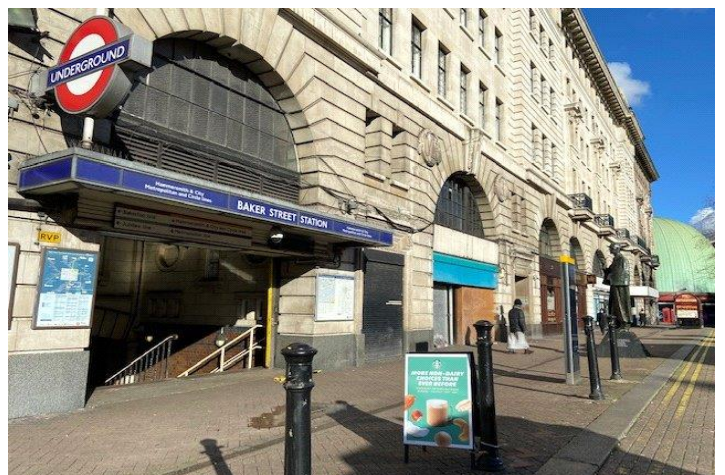

Winkworth

for every step...

Dorset House

Approximate Gross Internal Area
59.2 sq m / 637 sq ft

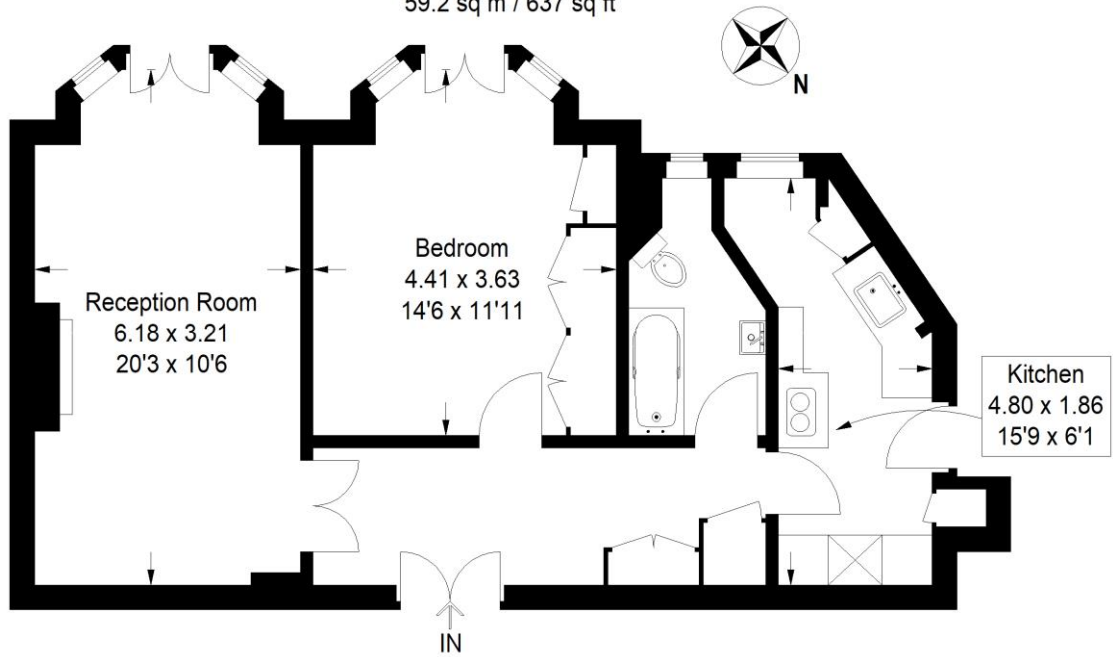

Fourth Floor

Illustration for identification purposes only, measurements are approximate, not to scale.
FloorplansUsketch.com © 2022 (ID 883684)

This floorplan is for illustration purposes only and is not to scale. The position and size of doors, windows, appliances and other features are approximate.

Paddington | 020 7467 5770 | paddington@winkworth.co.uk

Winkworth

for every step...

winkworth.co.uk

Winkworth wishes to inform prospective buyers and tenants that these particulars are a guide and act as information only. All our details are given in good faith and believed to be correct at the time of printing but they don't form part of an offer or contract. No Winkworth employee has authority to make or give any representation or warranty in relation to this property. All fixtures and fittings, whether fitted or not are deemed removable by the vendor unless stated otherwise and room sizes are measured between internal wall surfaces, including furnishings.