



**BOREHAM HOLT, HERTFORDSHIRE, WD6**

**£365,000 LEASEHOLD**

**A TWO DOUBLE BEDROOM, SECOND FLOOR FLAT  
SITUATED WITHIN WALKING DISTANCE TO  
ELSTREE & BOREHAMWOOD STATION**

**Borehamwood | 020 8953 8899 | borehamwood@winkworth.co.uk**



### DESCRIPTION:

This two double bedroom second floor flat is situated within walking distance to Elstree & Borehamwood train station & local amenities. Features include recently laid carpets throughout, neutral décor, fitted wardrobe space to the master bedroom, kitchen with freestanding oven and washing machine & bathroom with shower over bath. Available on a Chain Free basis, Viewings come highly recommended.

### AT A GLANCE

- 2 Bedrooms
- Entrance Hall
- Kitchen
- Reception Room
- Garage





Winkworth



Winkworth

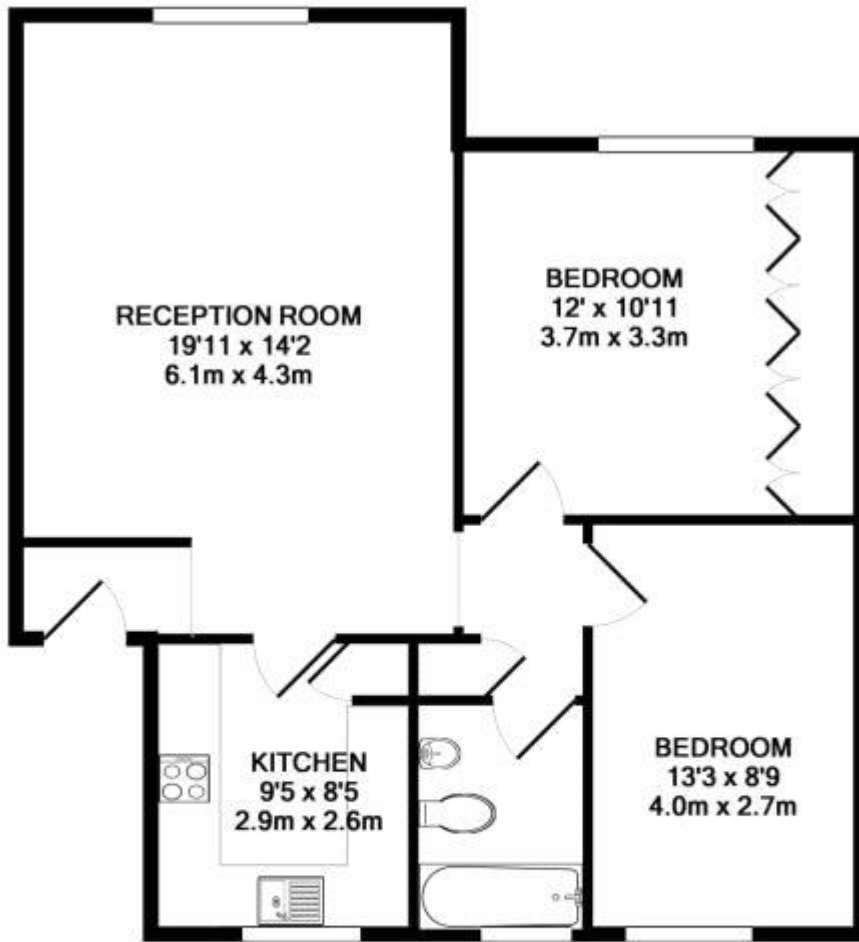

TOTAL APPROX. FLOOR AREA 700 SQ.FT. (65.0 SQ.M.)

Whilst every attempt has been made to ensure the accuracy of the floor plan contained here, measurements of doors, windows, rooms and any other items are approximate and no responsibility is taken for any error, omission, or mis-statement. This plan is for illustrative purposes only and should be used as such by any prospective purchaser. The services, systems and appliances shown have not been tested and no guarantee as to their operability or efficiency can be given.

Made with Metropix ©2016

This floorplan is for illustration purposes only and is not to scale. The position and size of doors, windows, appliances and other features are approximate.

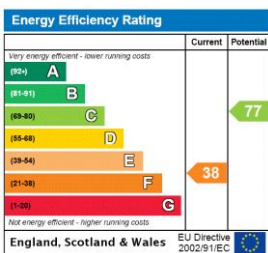

**Tenure:** Leasehold

**Term:** 949 year and 7 months

**Service Charge:** £0 per annum

**Ground Rent:** £ 0 Annually (subject to increase)

**Council Tax Band:** C

Where no figures are shown, we have been unable to ascertain the information. All figures that are shown were correct at the time of printing.