



ST. MARKS ROAD, WILTSHIRE, SP1  
£515,000 FREEHOLD

Winkworth





## 9 ST. MARKS ROAD, WILTSHIRE, SP1 3AY

**A well presented, three bed family home in a popular, residential location close to the city centre. Three bedrooms, residents parking, garden, conservatory and outside studio.**

This delightful period house has accommodation over four floors and is well presented throughout. The accommodation benefits from gas fired central heating and double glazing throughout. The lower ground floor comprises a generous open plan kitchen/dining room and a garden room leading directly to the rear garden. The house is entered at the front at ground level this comprises an entrance hall with stair to the first floor, a sitting room and a family room. The first floor includes a generous principle bedroom and a large bathroom off the landing and another stair leads up to the top floor there are two further, well proportioned bedrooms.

### AT A GLANCE

Entrance hall  
 Open plan kitchen, dining, conservatory  
 Sitting room  
 Dining room



Three double bedrooms  
 Family bathroom

Garden  
 Residents Parking

EPC Band D  
 Wiltshire Council Tax Band D  
 Gas central heating with double glazing  
 Mains drains  
 Ultrafast Broadband available (1800mp/s)  
 Mobile Coverage likely inside and out with EE limited with other providers



## LOCATION

This period property is located inside the city ring road, within this particularly sought after, tree lined residential road close to Wyndham Park and within walking distance of the city centre. Salisbury is a cathedral city with mainline rail connections to London and the south-west and excellent road links on major roads. The city has excellent shopping facilities including supermarkets and independent and brand name stores. There is a selection of schools in the private and state systems both at junior and senior levels and the boys and girls grammar schools have recently been noted within the top ten in the country. Leisure facilities include a variety of sports clubs and the Five Rivers leisure centre. There is a wide selection of restaurants and diners, two multi screen cinemas and two theatres. Twice weekly markets are held in the delightful central Square and many events are also held there throughout the year.



## DIRECTIONS

From our office in Castle Street proceed away from the city centre, and continue over the mini roundabout taking the first right turn into Wyndham Road. Follow the road to the top and bear right then left into St. Marks Road. Continue almost to the end and this property will be found on the right as indicated by the Winkworth For Sale board.

What3words: spin.dizzy.belly

EPC Band D

Wiltshire Council Tax Band D

Gas central heating with double glazing

Mains drains

Ultrafast Broadband available (1800mp/s)

Mobile Coverage likely inside and out with EE limited with other providers



BASEMENT

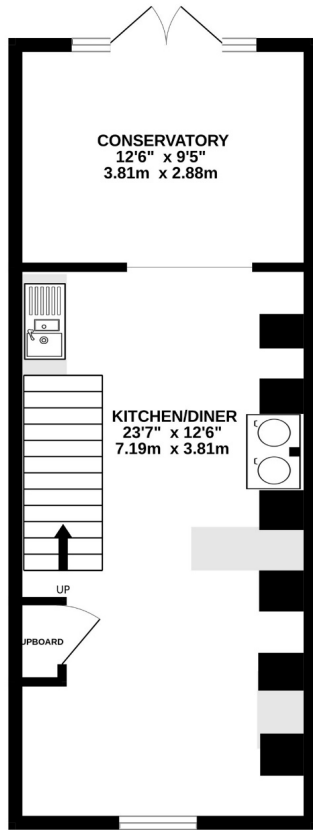

GROUND FLOOR

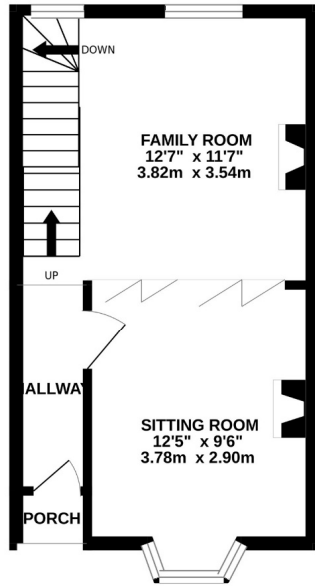

1ST FLOOR

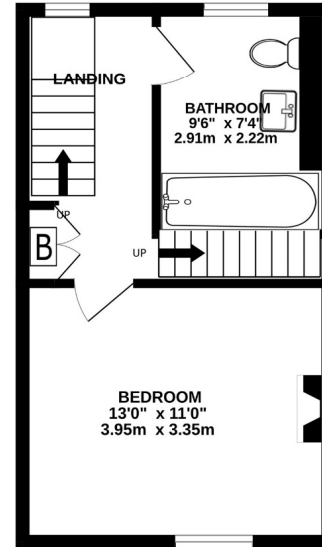

2ND FLOOR

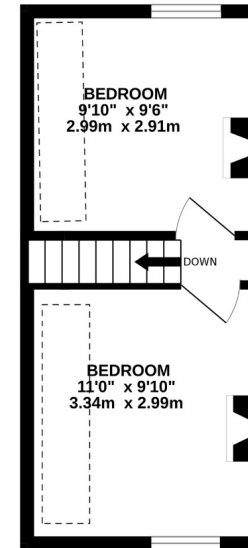

Made with Metropix ©2025

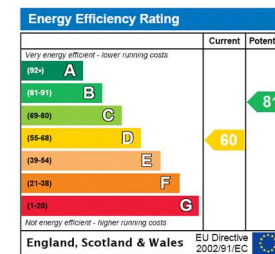

Salisbury | 01722 443 000 | salisbury@winkworth.co.uk

winkworth.co.uk

Winkworth wishes to inform prospective buyers and tenants that these particulars are a guide and act as information only. All our details are given in good faith and believed to be correct at the time of printing but they don't form part of an offer or contract. No Winkworth employee has authority to make or give any representation or warranty in relation to this property. All fixtures and fittings, whether fitted or not are deemed removable by the vendor unless stated otherwise and room sizes are measured between internal wall surfaces, including furnishings.

