



LOWER RICHMOND ROAD, SW15
£2,250 PER MONTH UNFURNISHED

An incredibly bright and spacious first and second floor flat on the popular Lower Richmond Road, Putney

Putney | 020 8877 1000 | putney@winkworth.co.uk

Winkworth

for every step...

winkworth.co.uk



DESCRIPTION:

Arranged across the top two floors of a period building this split-level flat extends two 770 sq ft.

It is presented in immaculate condition throughout having been redecorated and recarpeted throughout. Entered on the ground floor the large kitchen and reception room occupies the first floor benefitting from high ceilings and an abundance of natural light.

The top floor comprises two double bedrooms, both with built-in wardrobes, and two shower rooms.



ACCOMMODATION

2 Bedrooms, 1 Reception Room, 2 Bathrooms, Flat/Apartment, First Floor, Upper Floor without Lift, Residents Parking, Period, Town/City, Unfurnished, approx. 770 sq. ft.

Lower Richmond Road, SW15
Approx. Gross Internal Floor Area 770 sq. ft / 71.59 sq. m

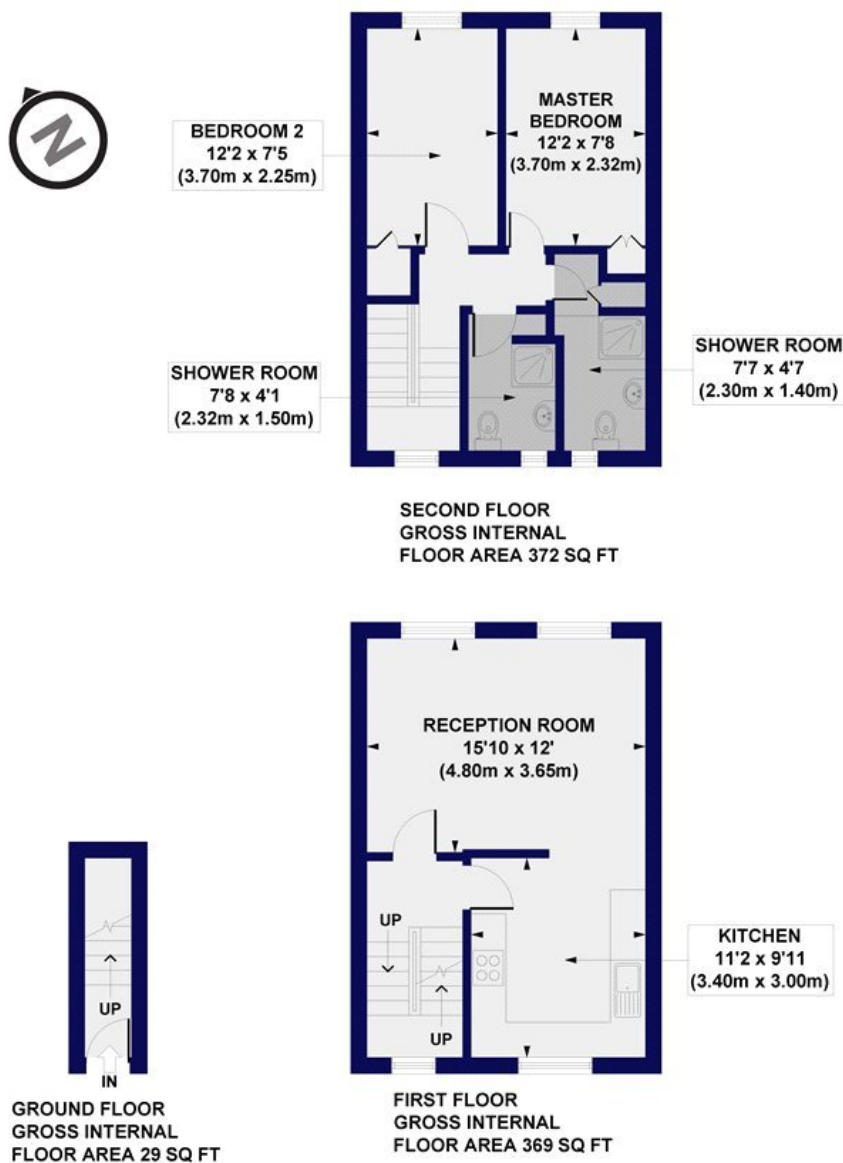

All measurements of walls, doors, windows, fittings and appliances, including their size and location, are shown as standard sizes and do not constitute any warranty or representation by the seller, their agent or CP Creative. Any intending purchaser must satisfy himself by inspection or otherwise as to the correctness of the information contained in these plans. This plan is for illustrative purposes only and should be used as such by any prospective purchasers.

Winkworth

This floorplan is for illustration purposes only and is not to scale. The position and size of doors, windows, appliances and other features are approximate.

Deposit: 5 weeks' rent

Holding Deposit: 1 week's rent

Council Tax Band: TBC

Where no figures are shown, we have been unable to ascertain the information. All figures that are shown were correct at the time of printing.

Putney | 020 8877 1000 | putney@winkworth.co.uk

Winkworth

for every step...

winkworth.co.uk

Winkworth wishes to inform prospective buyers and tenants that these particulars are a guide and act as information only. All our details are given in good faith and believed to be correct at the time of printing but they don't form part of an offer or contract. No Winkworth employee has authority to make or give any representation or warranty in relation to this property. All fixtures and fittings, whether fitted or not are deemed removable by the vendor unless stated otherwise and room sizes are measured between internal wall surfaces, including furnishings.