



**DYMOCK STREET, SW6**  
**£825,000 LEASEHOLD**

**A simply exquisite two double bedroom ground floor flat boasting an incredibly large 27 ft private garden.**

Fulham & Parsons Green | 020 7731 3388 | fulham@winkworth.co.uk

**Winkworth**

for every step...

*winkworth.co.uk*





This beautifully presented garden flat has been cleverly designed to allow a huge amount of natural light to flow throughout. There is an impressive newly-renovated open-plan kitchen and reception area with smart grey tinted wooden flooring. The kitchen has fantastic built-in base and wall units, with an excellent bar styled central Island. The reception area leads out onto an especially large garden, which is excellent for entertaining.

The master bedroom, located at the front of the property, has well-designed deep built-in wardrobes and great floor space. The light and bright second double bedroom also has built-in wardrobes and there are glass doors which lead onto the small, private courtyard. There is a generous sized modern bathroom.

Dymock Street is located the south of Fulham, between Hugon Road and Carnwath Road, parallel to the Wandsworth Bridge Road close to the river and South Park. It is 0.9 miles to Parsons Green underground station and 1.1 miles to Fulham Broadway underground station. Wandsworth Town train station is a few minutes' walk over Wandsworth Bridge.







## DYMOCK STREET, SW6

Approximate gross internal area  
702 sq ft / 65.21 sq m

Key :  
CH - Ceiling Height

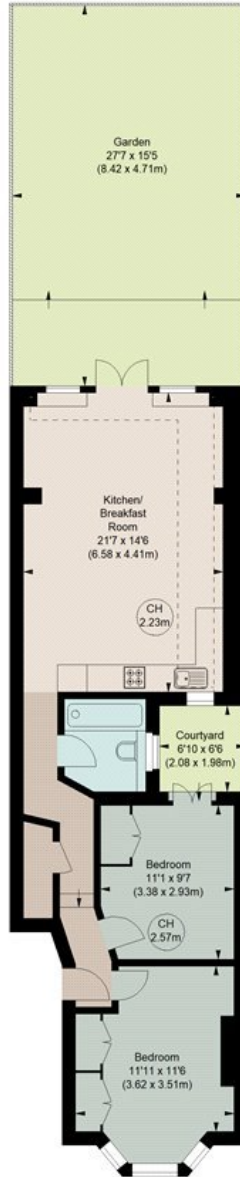

### GROUND FLOOR

The floor plan is not to scale and measurements and areas shown are approximate and therefore should be used for illustrative purposes only. The plan has been prepared in accordance with the RICS code of Measuring Practice and whilst we have confidence in the information produced, it must not be relied on. If there is any aspect of particular importance, you should carry out or commission your own inspection of the property.

This floorplan is for illustration purposes only and is not to scale. The position and size of doors, windows, appliances and other features are approximate.

Fulham & Parsons Green | 020 7731 3388 | fulham@winkworth.co.uk

# Winkworth

for every step...

[winkworth.co.uk](http://winkworth.co.uk)

Winkworth wishes to inform prospective buyers and tenants that these particulars are a guide and act as information only. All our details are given in good faith and believed to be correct at the time of printing but they don't form part of an offer or contract. No Winkworth employee has authority to make or give any representation or warranty in relation to this property. All fixtures and fittings, whether fitted or not are deemed removable by the vendor unless stated otherwise and room sizes are measured between internal wall surfaces, including furnishings.