



ST. MICHAEL'S TERRACE, N22
£375,000 SHARE OF FREEHOLD

DESCRIPTION:

Arranged over the entire first floor of this Victorian building, this one bedroom flat is flooded with light and overlooks the park.

Chain Free. Sole Agents.

Harringay | 020 8800 5151 | harringay@winkworth.co.uk

Winkworth

for every step...

winkworth.co.uk

St. Michael's Terrace, N22
 Approx. Gross Internal Floor Area 457 sq. ft / 42.46 sq. m

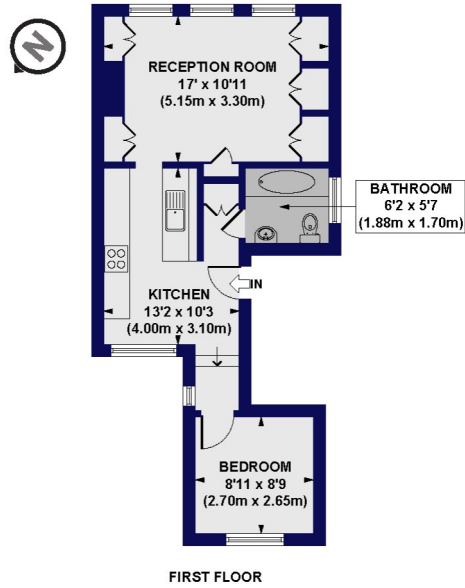

All measurements of walls, doors, windows, fittings and appliances, including their size and location, are shown as standard sizes and do not constitute a warranty or representation by the seller. Care should be taken as to the correct use of the information contained in these plans. Depend on the finished surface and material used in any prospective purchases.



This floorplan is for illustration purposes only and is not to scale. The position and size of doors, windows, appliances and other features are approximate.

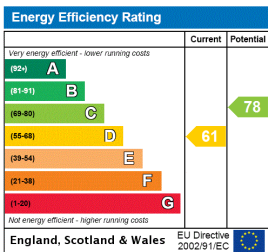

- Tenure:** Share of Freehold
 - Term:** 0 year and 0 months
 - Service Charge:** £0 per annum
 - Ground Rent:** £ 0 Annually (subject to increase)
 - Council Tax Band:** C
- Where no figures are shown, we have been unable to ascertain the information. All figures that are shown were correct at the time of printing.

Harringay | 020 8800 5151 | harringay@winkworth.co.uk



for every step...

winkworth.co.uk

Winkworth wishes to inform prospective buyers and tenants that these particulars are a guide and act as information only. All our details are given in good faith and believed to be correct at the time of printing but they don't form part of an offer or contract. No Winkworth employee has authority to make or give any representation or warranty in relation to this property. All fixtures and fittings, whether fitted or not are deemed removable by the vendor unless stated otherwise and room sizes are measured between internal wall surfaces, including furnishings.