



# Lundy Close

Basingstoke RG24 9AJ

## Description

This spacious three bedroom end terrace house could do with some tidying up but offers a decent size family home with the benefit of a garage to the rear. It is also available with no onward chain.

The ground floor has a living room to the rear with open access through into the dining room and this has sliding patio doors to the back garden. The kitchen has white high gloss finish cupboards with a built-in electric oven and hob, integrated dishwasher and a 1½ bowl stainless steel sink unit.

Heading upstairs there are three good size bedrooms and a bathroom that has a white suite.

Externally, the front garden is a courtyard style and there is a south-west facing rear garden with a garage in one corner.

The house has gas fired warm air heating (not tested).



**Winkworth**

# Accommodation

- Entrance hall
- Living room
- Dining room
- Kitchen
- Utility area
- Three bedrooms
- Bathroom
- Garage
- Gardens

Under the Property Misdescriptions Act 1991, these Particulars are a guide and act as information only. All details are given in good faith and are believed to be correct at time of printing. Winkworth give no representation as to their accuracy and potential purchasers or tenants must satisfy themselves by inspection or otherwise as to their correctness. No employee of Winkworth has authority to make or give any representation or warranty in relation to this property.

Energy Efficiency Rating		Current	Potential
Very energy efficient - lower running costs			
(92-100)	<b>A</b>		
(81-91)	<b>B</b>		
(69-80)	<b>C</b>		
(55-68)	<b>D</b>		
(39-54)	<b>E</b>		
(21-38)	<b>F</b>		
(1-20)	<b>G</b>		
Not energy efficient - higher running costs			
England, Scotland & Wales		EU Directive 2002/91/EC	

GROUND FLOOR  
597 sq.ft. (55.5 sq.m.) approx.

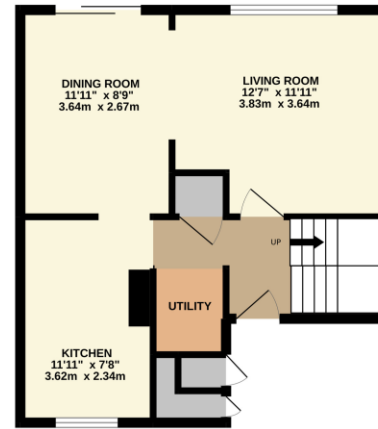

1ST FLOOR  
451 sq.ft. (41.9 sq.m.) approx.

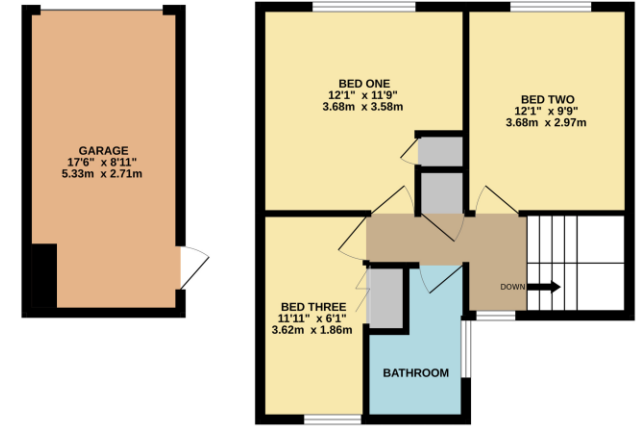

TOTAL FLOOR AREA : 1049 sq.ft. (97.4 sq.m.) approx.

Whilst every attempt has been made to ensure the accuracy of the floorplan contained here, measurements of doors, windows, rooms and any other items are approximate and no responsibility is taken for any error, omission or mis-statement. This plan is for illustrative purposes only and should be used as such by any prospective purchaser. The services, systems and appliances shown have not been tested and no guarantee as to their operability or efficiency can be given.  
Made with Metropix ©2022



## Basingstoke Office

10B Church Street, Basingstoke, Hampshire, RG21 7QE

01256 811730 | basingstoke@winkworth.co.uk

[winkworth.co.uk/Basingstoke](http://winkworth.co.uk/Basingstoke)



See things differently.