



OAKLEY GARDENS, CROUCH END, N8  
£1,150,000 FREEHOLD

5 Bedrooms \* 2 Bathrooms \* 2 Reception Rooms \* Cellar

Fully Fitted Kitchen \* Rear Garden 37 x 17

Crouch End | 020 8342 9999 | [crouchend@winkworth.co.uk](mailto:crouchend@winkworth.co.uk)

**Winkworth**

[winkworth.co.uk](http://winkworth.co.uk)

See things differently



#### DESCRIPTION:

As the owners sole agent we have pleasure in offering for sale this very well maintained 5 bedroom, 2 reception room, 2 bathroom period family house. The property is arranged over 3 levels and retains many fine period features and is conveniently situated within a quarter of a mile from Hornsey BR station and also Crouch End Broadway for a variety of shops, cafes and restaurants. Features include 5 double bedrooms, 2 receptions rooms, fully fitted kitchen 12'5 x 9'7, cellar, 2 bathrooms, utility room and a rear garden 37 x 17.



**Winkworth**



**Winkworth**

# Oakley Gardens, N8

Approx. Gross Internal Floor Area 1752 sq. ft / 162.84 sq. m (Including Restricted Height Area)  
 Approx. Gross Internal Floor Area 1707 sq. ft / 158.65 sq. m (Excluding Restricted Height Area)

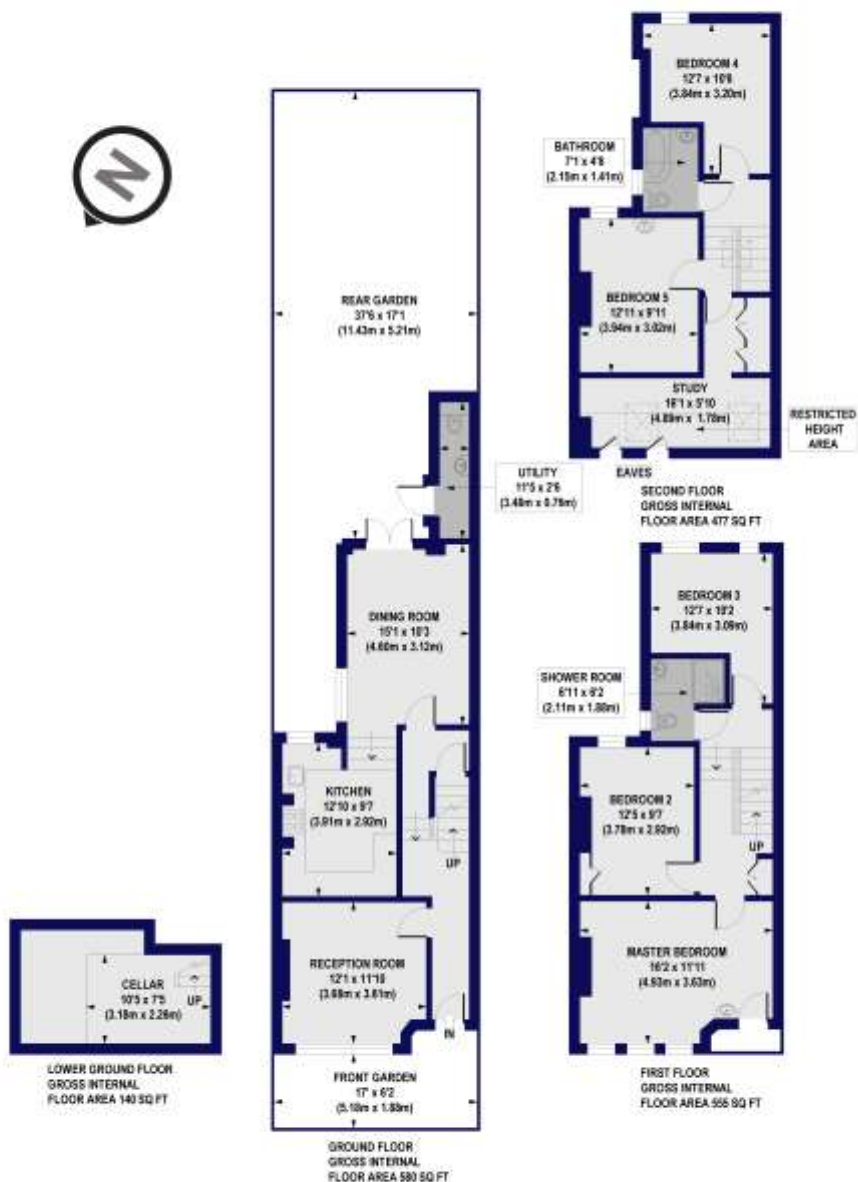

All measurements of walls, doors, windows, fittings and appliances, including their size and location, are shown as standard sizes and do not constitute any warranty or representation by the seller, their agents or CP Creative. Any intending purchaser must satisfy himself by inspection or otherwise as to the correctness of the information contained in these plans. This plan is for illustrative purposes only and should be used as such by any prospective purchasers.



This floorplan is for illustration purposes only and is not to scale. The position and size of doors, windows, appliances and other features are approximate.

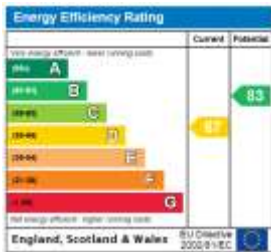

Crouch End | 020 8342 9999 | crouchend@winkworth.co.uk



winkworth.co.uk

See things differently

Winkworth wishes to inform prospective buyers and tenants that these particulars are a guide and act as information only. All our details are given in good faith and believed to be correct at the time of printing but they don't form part of an offer or contract. No Winkworth employee has authority to make or give any representation or warranty in relation to this property. All fixtures and fittings, whether fitted or not are deemed removable by the vendor unless stated otherwise and room sizes are measured between internal wall surfaces, including furnishings.