



KEW ROAD, RICHMOND, SURREY, TW9
£1,150 PER MONTH

Brentford | 020 8560 1125 | brentford@winkworth.co.uk

Winkworth

for every step...

winkworth.co.uk



DESCRIPTION:

Comprising modern kitchen, bathroom with large shower cubicle, spacious living/reception area, neutral decor, and wooden flooring throughout. e. The accommodation comprises of modern open plan living space, fitted kitchen and modern bathroom. Kew Road is well located to benefit from the excellent amenities Richmond has to offer.

ACCOMMODATION

Modern studio

Short walk to Richmond Town Centre

Richmond underground station nearby

Epc Rating D

Excellent location

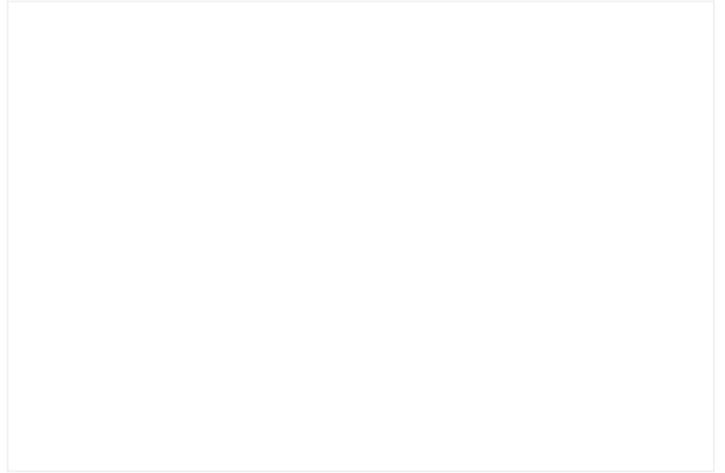

KEW ROAD, TW9

Approx. Gross Internal Floor Area
405 Sq. ft/36.70 Sq. m

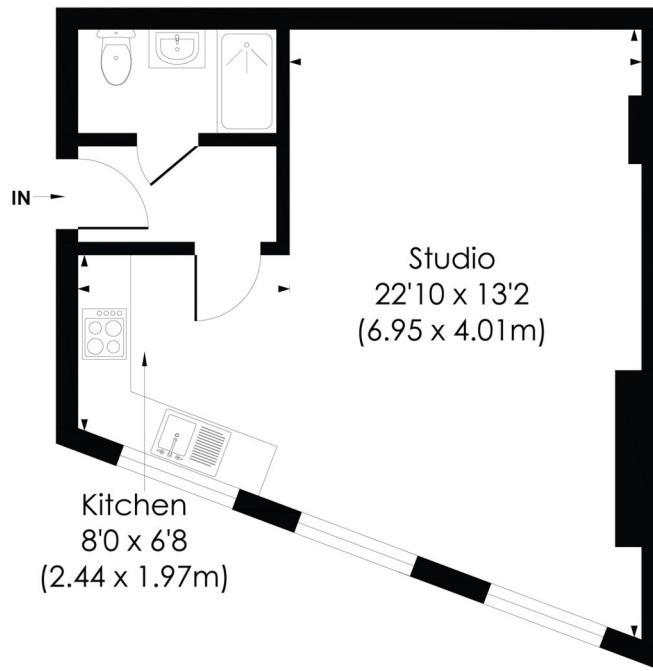

FIRST FLOOR

© Pixangle Property Marketing Ltd. info@pixangle.com Tel: 0208 870 2118



This floor plan has been prepared for the purpose of illustration only in accordance with the latest RICS code of measuring practice and is not to scale. All measurements and areas are approximate and whilst every effort has been made to ensure the accuracy of the plan contained here, no responsibility is taken for any error, omission or misstatement.

This floorplan is for illustration purposes only and is not to scale. The position and size of doors, windows, appliances and other features are approximate.

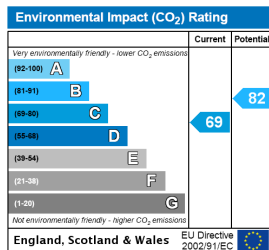
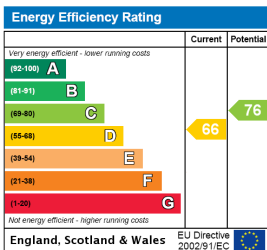

Brentford | 020 8560 1125 | brentford@winkworth.co.uk



for every step...

winkworth.co.uk

Winkworth wishes to inform prospective buyers and tenants that these particulars are a guide and act as information only. All our details are given in good faith and believed to be correct at the time of printing but they don't form part of an offer or contract. No Winkworth employee has authority to make or give any representation or warranty in relation to this property. All fixtures and fittings, whether fitted or not are deemed removable by the vendor unless stated otherwise and room sizes are measured between internal wall surfaces, including furnishings.