



BEEHCROFT AVENUE, NW11
£499,950 LEASEHOLD

A CENTRALLY LOCATED 2 BEDROOM 2 BATHROOM GROUND FLOOR APARTMENT

2 Double Bedrooms/ 2 Bathrooms/ Very Central Location/
Ground Floor/ Chain Free/ Ready to move in Condition/
EPC Rating: C/ Council Tax Band: D



DESCRIPTION:

We are delighted to offer this 2 bedroom, 2 bathroom ground floor apartment in this fabulously located purpose built block adjacent to all amenities on Golders Green Road. The flat is offered chain free and is in good condition having recently been professionally let for several years.

Viewing is strongly recommended.

Lease: 999 years from 24 June 1983

Service Charges

There is currently an ongoing additional service charge (a surcharge) of £3500 pa which will run to 2028. The current annual service charge is £2506 (year ending 28/09/2025) thus a combined annual service charge of £6006...

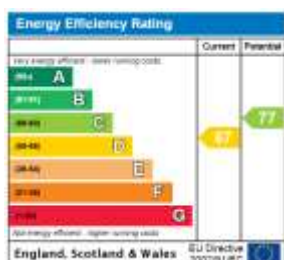



Beechcroft Court, London NW11 8BP

Ground Floor
GROSS INTERNAL FLOOR AREA
APPROX. 64.56 SQ M / 695 SQ FT

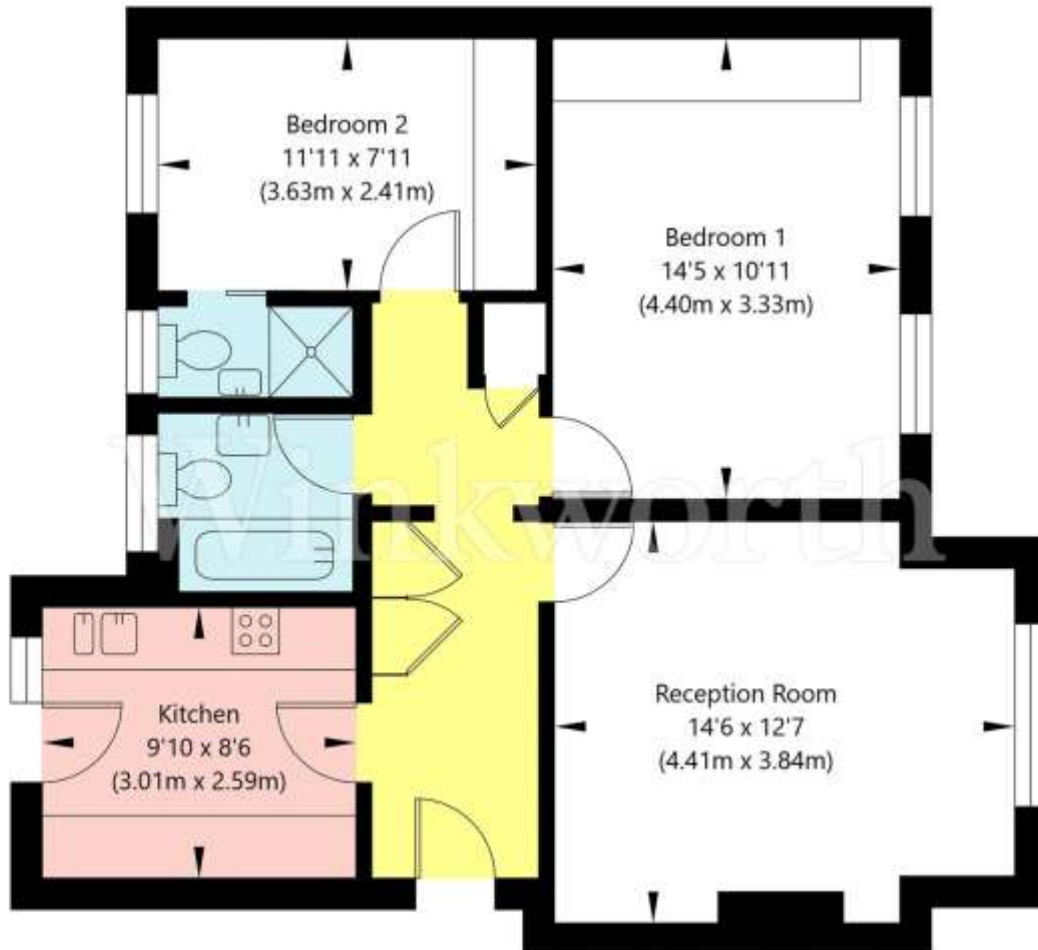

APPROXIMATE GROSS INTERNAL FLOOR AREA 64.56 SQ M / 695 SQ FT
THIS FLOOR PLAN IS FOR ILLUSTRATIVE PURPOSES ONLY AND
SHOULD BE USED FOR THIS PURPOSE BY PROSPECTIVE APPLICANTS AS ITS NOT TO SCALE.

(c) AMBERSHORE PIX LIMITED / PHOTO - VIDEO - FLOOR PLANS / 0800 999 1577 / WWW.AMERSHOREPIX.CO.UK