



75 St. Blaize Road, Romsey, Hampshire SO51 7JY

Winkworth



THREE BEDROOM TERRACED HOME

This lovely family home is located on the outskirts of the market town of Romsey in a quiet residential setting with local shops and amenities. Romsey is a bustling market town with a wide range of facilities, including a train station and local shops including a Waitrose super store, together with a variety of excellent restaurants and public houses. There are good connections to the M27 and M3, giving access to Southampton, Southampton Airport, Salisbury and Winchester with a mainline service to London Waterloo (55 mins). Romsey is only a short drive away from the New Forest famous for its New Forest ponies, excellent equestrian facilities and a huge network of walks and cycle paths.

The accommodation comprises external porch leading to the entrance lobby and cloakroom, leading to a good-sized sitting/dining room with square bay window to the front elevation and French doors leading to the rear garden. There is a fully fitted kitchen with a good range of units and space for washing machine/dishwasher and fridge/freezer. To the first floor there are two double bedrooms and a third single, the family bathroom has a shower over bath.

Outside to the front is a large lawned area, the fully enclosed rear garden benefits from a terrace, the perfect space for al-fresco dining, the rest of the garden is mainly laid to lawn. A single detached garage can be found in a nearby block.

The property is offered with no forward chain.

Council tax rating: C



Winkworth

Address: 75 St. Blaize Road,
Romsey, Hampshire SO51 7JY

Council Tax Band: "C"
Freehold

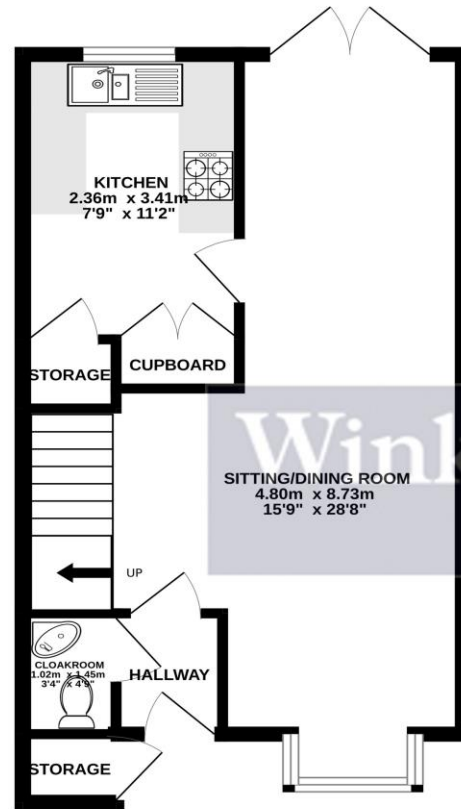

GROUND FLOOR
40.7 sq.m. (438 sq.ft.) approx.

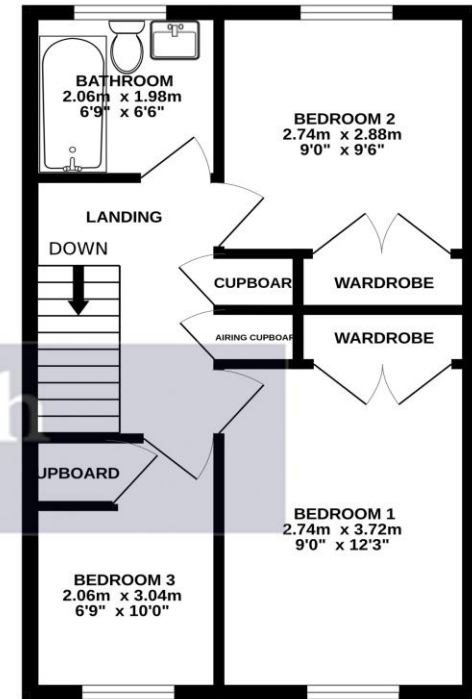

1ST FLOOR
39.0 sq.m. (420 sq.ft.) approx.

TOTAL FLOOR AREA: 79.7 sq.m. (857 sq.ft.) approx.
Produced by Ellis Belk Photography; This information has been prepared as guide only. The vendor and Estate Agents, make no warranties as to its accuracy and all interested parties must rely on their own enquiries.
Made with Metropix ©2023

winkworth.co.uk/romsey

Winkworth Romsey

18 Market Place, Romsey, Hampshire, SO51 8NA
01794 511911 | romsey@winkworth.co.uk

winkworth.co.uk/romsey

Winkworth Winchester

2 Black Swan Buildings, Southgate Street,
Winchester, Hampshire, SO23 9DT
01962 866777 | winchester@winkworth.co.uk

Winkworth Mayfair & Country House Department

11 Berkeley Street, Mayfair, London, W1J 8DS
020 7871 0589 | countryhouse@winkworth.co.uk

Winkworth

See things differently