



Sinclair Road, Brook Green, W14

£875,000 Share of Freehold

An exceptionally spacious and well presented two double bedroom flat on the first floor of a double fronted Victorian house.

Reception Room | Kitchen | 2 Bedrooms | Bathroom | Utility Room | Balcony | 918 Sq Ft / 85 Sq M |
EPC Rating Band C

Winkworth



LOCATION

Situated midway along Sinclair Road, the location is ideal for the numerous amenities on offer in Brook Green, which include a number of excellent pubs and restaurants, whilst a further more comprehensive selection are on offer both in Hammersmith and at Westfield London. The closest Underground stations are Hammersmith and Shepherds Bush, where London Overground services are also available.

DESCRIPTION

The property is offered in good order throughout, with accommodation comprising entrance hall, reception room, kitchen, two double bedrooms and bathroom. Furthermore there is sole access to a utility/laundry room which provides further storage. The apartment is significantly larger than the majority of other flats on the road, as the building is one of the few on the street which is double fronted.





LOCAL AUTHORITY
Hammersmith & Fulham

TENURE
Share of Freehold.

PRICE: £875,000 Share of Freehold

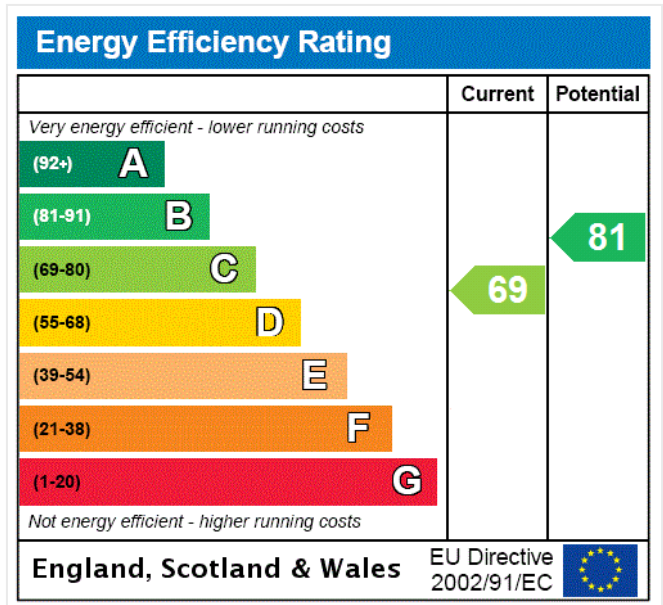

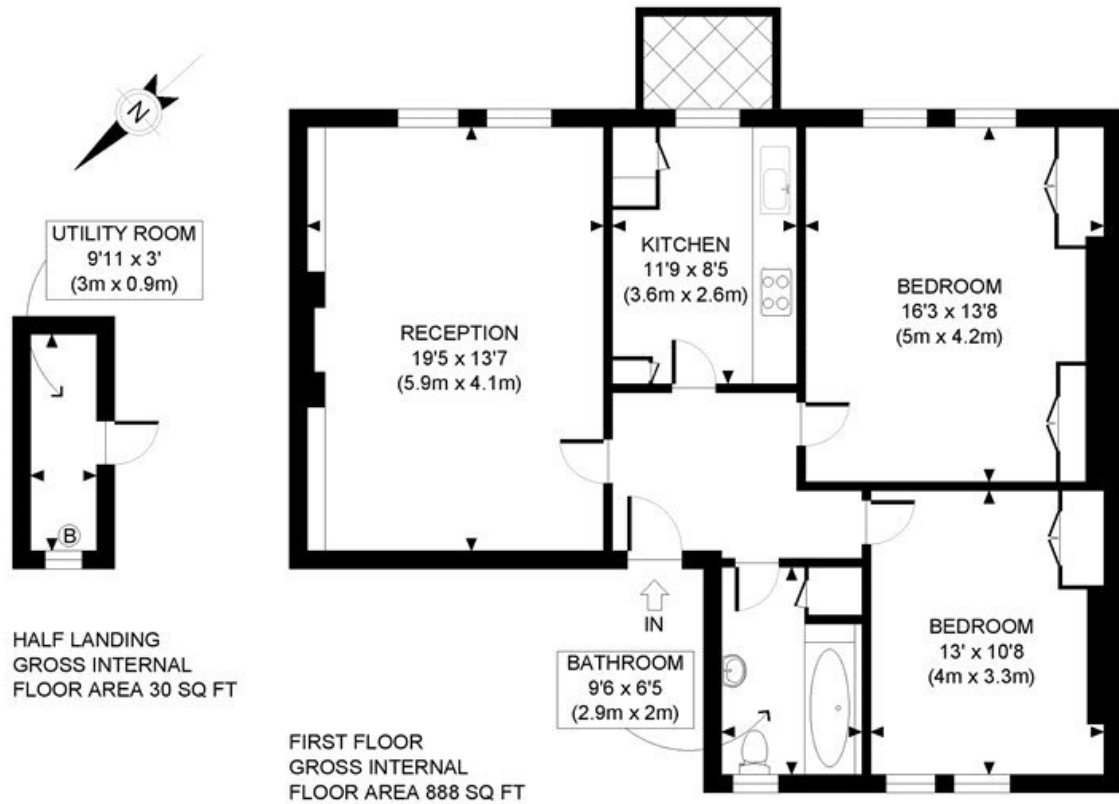

APPROX. GROSS INTERNAL FLOOR AREA: 918 SQ FT/ 85 SQM

Winkworth

This plan is for illustrative purposes only and should be used as such by any prospective client. Whilst every attempt has been made to ensure the accuracy of the Floor Plan contained here, measurements of the doors, windows, rooms and any other items are approximate and no responsibility is taken for any errors, omissions, or misstatement. The services, systems and appliances shown have not been tested and no guarantee as to the operability or efficiency can be given.

PROPERTY PHOTO PLANS COOK
THE TOP END OF PROPERTY MEASURING

The displayed square footage is taken from the floor plans with measurements created using the Royal Institute of Chartered Surveyors' Code of Practice for Measuring. These measurements are approximate and included for illustrative purposes only. Winkworth does not make any representation as to the accuracy of these measurements and you should seek to verify them for yourself. Winkworth accept no liability for any loss you may suffer if you rely on these measurements.

Hammersmith | 0207 371 4466 | hammersmith@winkworth.co.uk

Winkworth

for every step...

Under the Property Misdescriptions Act 1991, these Particulars are a guide and act as information only. All details are given in good faith and are believed to be correct at time of printing. Winkworth give no representation as to their accuracy and potential purchasers or tenants must satisfy themselves by inspection or otherwise as to their correctness. No employee of Winkworth has authority to make or give any representation or warranty in relation to this property.