



**6 Chirk Place, Romsey, Hampshire, SO51 7NP**





## **MODERN APARTMENT CLOSE TO TOWN CENTRE**

**Enviably positioned within a level walk of the town centre of Romsey, rich with an abundance of eateries, boutique shops and steeped with history and charm is this spacious apartment with a large balcony providing outside space. Nearby attractions include the Abbey and Broadlands House. The cathedral city of Winchester is a short drive as is the commercial centre of Southampton with West Quay shopping centre and mainline station to London Waterloo.**

**6 Chirk Place is a particularly light and spacious first floor apartment in a modern block. Offering a well fitted kitchen which is large enough to accommodate a dining table, and provides access to the balcony. The generous sitting room also leads onto the balcony through French doors. The property offers two double bedrooms. The master bedroom features a separate en-suite shower room. Completing the property is a family bathroom. The apartment also benefits from a lift and a parking space. The front door, with entry phone system, leads into a communal hallway.**

**Ground Rent: - £365.00 pa  
Block service charges: - £3,940.00 pa  
Lease: - The lease is for a period of 125 years from 01/01/2002**



# Winkworth

**Address: 6 Chirk Place, Romsey,  
SO51 7NP**  
**Council Tax Band: "D"**  
**EPC 'B' Rating**

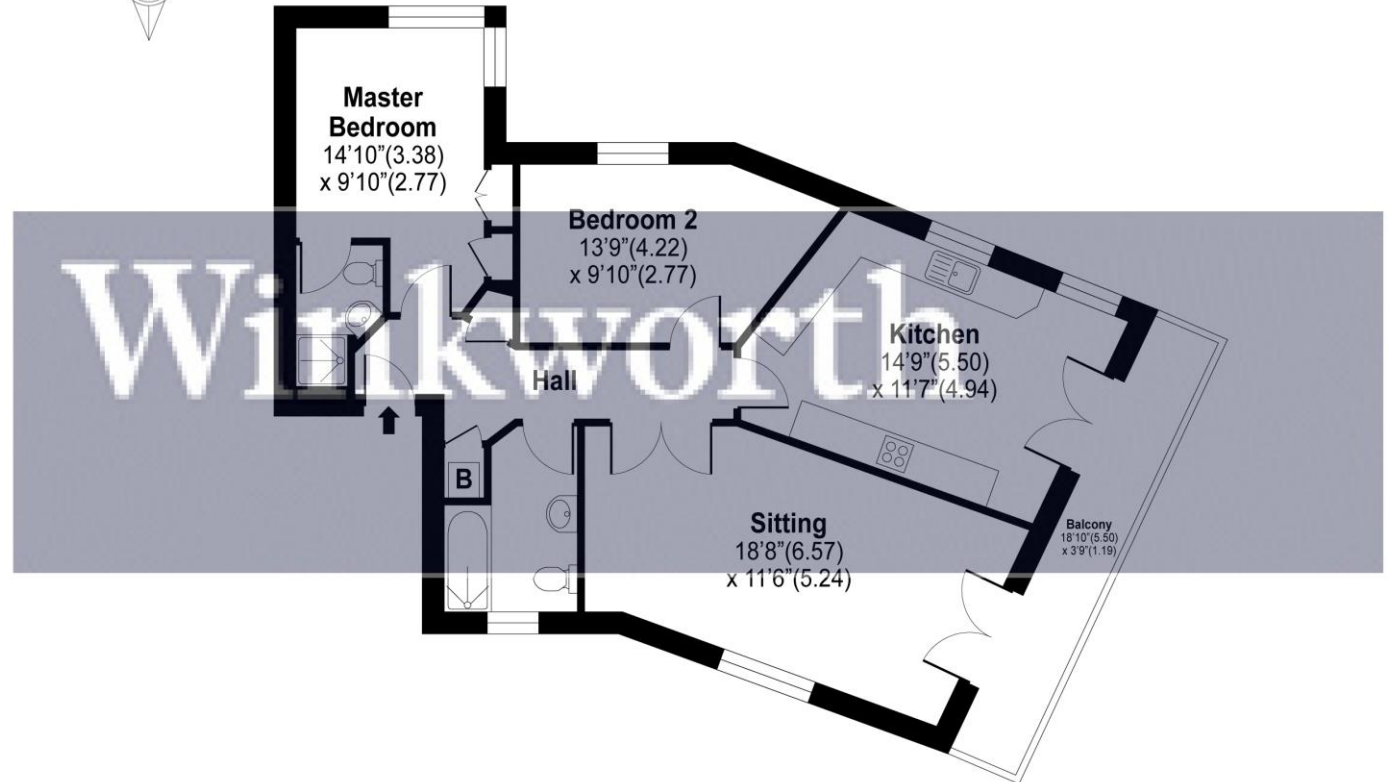

## CHIRK PLACE, ROMSEY

Approximate Area = 839 sq ft / 78 sq m  
For identification only - Not to scale

[winkworth.co.uk/romsey](http://winkworth.co.uk/romsey)

### Winkworth Romsey

18 Market Place, Romsey, Hampshire, SO51 8NA  
01794 511911 | [romsey@winkworth.co.uk](mailto:romsey@winkworth.co.uk)

[winkworth.co.uk/romsey](http://winkworth.co.uk/romsey)

### Winkworth Winchester

2 Black Swan Buildings, Southgate Street,  
Winchester, Hampshire, SO23 9DT  
01962 866777 | [winchester@winkworth.co.uk](mailto:winchester@winkworth.co.uk)

### Winkworth Mayfair & Country House Department

11 Berkeley Street, Mayfair, London, W1J 8DS  
020 7871 0589 | [countryhouse@winkworth.co.uk](mailto:countryhouse@winkworth.co.uk)

# Winkworth

See things differently