



GROVE PARK TERRACE, LONDON, W4  
**£599,950 SHARE OF FREEHOLD**

## TWO BEDROOM MANSION APARTMENT IN GROVE PARK

Chiswick | 020 8994 7096 | [chiswick@winkworth.co.uk](mailto:chiswick@winkworth.co.uk)

**Winkworth**

for every step...

[winkworth.co.uk](http://winkworth.co.uk)



## DESCRIPTION:

Discover this beautifully presented two-bedroom apartment in the desirable Sutton Court Mansions, featuring a lovely balcony for outdoor enjoyment. Ideally located, you'll be just a short walk from Chiswick Train Station and within half a mile of Gunnersbury Tube and Overground stations, making commuting a breeze. Don't miss out on this fantastic opportunity to live in a vibrant community with excellent transport links!

## ACCOMMODATION

Share of Freehold, 2 Bedrooms, 1 Reception Room, 1 Bathroom, Flat/Apartment, Upper Floor without Lift, Balcony, Period, Town/City, Purpose Built, Good decoration



# Sutton Court Mansions

Approximate Gross Internal Area = 65.7 sq m / 706 sq ft

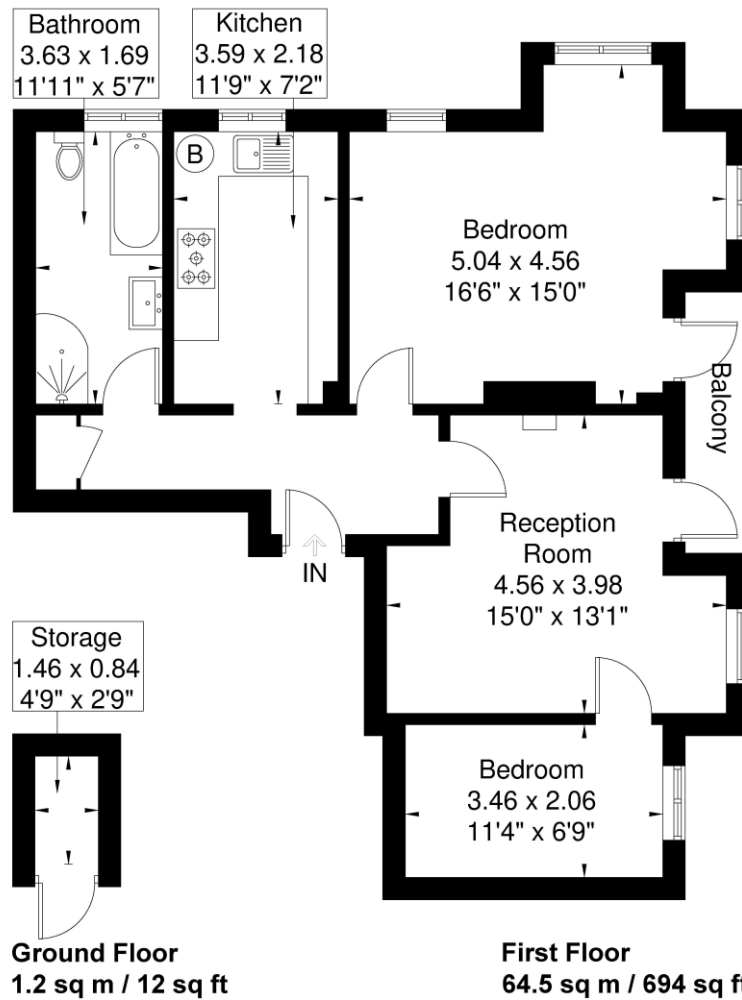

Although every attempt has been made to ensure accuracy, all measurements are approximate. The floorplan is for illustrative purposes only and not to scale.  
© www.perspective.co.uk

This floorplan is for illustration purposes only and is not to scale. The position and size of doors, windows, appliances and other features are approximate.

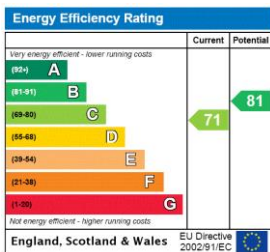

Chiswick | 020 8994 7096 | chiswick@winkworth.co.uk



for every step...

winkworth.co.uk

Winkworth wishes to inform prospective buyers and tenants that these particulars are a guide and act as information only. All our details are given in good faith and believed to be correct at the time of printing but they don't form part of an offer or contract. No Winkworth employee has authority to make or give any representation or warranty in relation to this property. All fixtures and fittings, whether fitted or not are deemed removable by the vendor unless stated otherwise and room sizes are measured between internal wall surfaces, including furnishings.