



Middlebridge Street, Romsey SO51 8HJ

Winkworth



PERIOD PROPERTY IN SUPERB LOCATION

We are delighted to offer this two-bedroom period property in a prized location close to the heart of Romsey Town, located within a few minutes' walk of its extensive amenities. Local Facilities include a range of individual shops, schools, leisure facilities, doctors and dentist surgeries and public transport by way of bus and rail services. The M27 can be accessed at junction 3, about 3 ½ miles distant. The major centres of Salisbury, Southampton, Winchester and Portsmouth are all easily accessed.

This beautifully presented two-bedroom end of terrace property is in the heart of Romsey Town Centre. The property itself is full of charm and has many beautiful features throughout. The accommodation features a spacious sitting room that seamlessly flows into the modern, well-appointed kitchen. From here elegant French doors open out to the rear garden, creating a perfect blend of indoor and outdoor living. The kitchen is equipped with a wide range of eye and base level units offering both style and practicality. A sleek and modern shower room is conveniently situated on the ground floor. Upstairs boasts two bedrooms with the principal bedroom featuring built-in wardrobes for added storage and convenience.

The garden is low maintenance and offers privacy, making it an ideal area for relaxation. It also boasts a patio area, perfect for enjoying al fresco dining and outdoor entertaining.

- Parking is on the street by permit.
- All mains utilities
- Ultrafast broadband available
- Council tax band 'C'



Winkworth

Address: Middlebridge Street,
Romsey, SO51 8HJ
Tenure: Freehold
Council tax band: C 'TVBC'

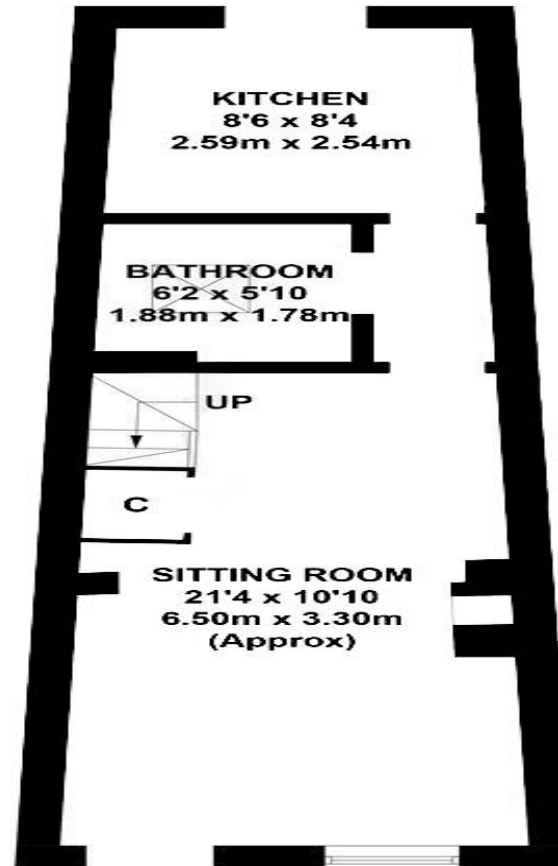

GROUND FLOOR



FIRST FLOOR

APPROXIMATE GROSS INTERNAL AREA
GROUND FLOOR = 351 SQ FT / 32.6 SQ M
FIRST FLOOR = 215 SQ FT / 20.0 SQ M
TOTAL = 566 SQ FT / 52.6 SQ M
Illustration for identification purposes only,
measurements are approximate, not to scale. (ID896845)

winkworth.co.uk/romsey

Winkworth Romsey

18 Market Place, Romsey, Hampshire, SO51 8NA
01794 511911 | romsey@winkworth.co.uk

winkworth.co.uk/romsey

Winkworth Winchester

2 Black Swan Buildings, Southgate Street,
Winchester, Hampshire, SO23 9DT
01962 866777 | winchester@winkworth.co.uk

Winkworth Mayfair & Country House Department

11 Berkeley Street, Mayfair, London, W1J 8DS
020 7871 0589 | countryhouse@winkworth.co.uk

Winkworth

See things differently