



ZENORIA STREET, EAST DULWICH, LONDON, SE22
£1,350,000 FREEHOLD

SITUATED ON ONE OF SE22'S MOST CENTRAL
RESIDENTIAL STREETS, IS THIS FANTASTIC
FIVE DOUBLE BEDROOM FAMILY HOME.

Dulwich | 020 8299 2722 | dulwich@winkworth.co.uk

Tenure Freehold | Council Tax Band D – London Borough of Southwark

Winkworth

winkworth.co.uk

See things differently



DESCRIPTION:

This spacious family home is situated a stones throw from Lordship Lane. The property offers on the ground floor a spacious double reception complete with wood flooring and high ceilings, downstairs cloakroom and an open-plan kitchen-diner to rear. The kitchen boasts wooden work tops, lots of storage and integrated appliances. Bi-fold doors lead out to a private garden to rear. The property boasts the potential to be extended into the side return STPP.

Upstairs are three very good sized double bedrooms and a large family bathroom. The loft has been extended to provide two double bedrooms and a further shower room. It is perfectly positioned to benefit from easy access to the bars, restaurants and shops on Lordship Lane as well as direct transport links into Central London via East Dulwich or Denmark Hill station. School catchments are in abundance with Belham and DVIS for primary or Charter East for secondary. This is a fantastic house in a superb location.

AT A GLANCE

- Five Double Bedrooms
- Double Reception Room
- Open Plan Kitchen/Diner
- Bathroom, Shower Room & A Downstairs Cloakroom
- Bi-Folding Doors leading to a Private Garden
- Air conditioning in three bedrooms
- Within catchment for DVIS and The Belham Schools
- Potential To Extend (STPP)





Zenoria St

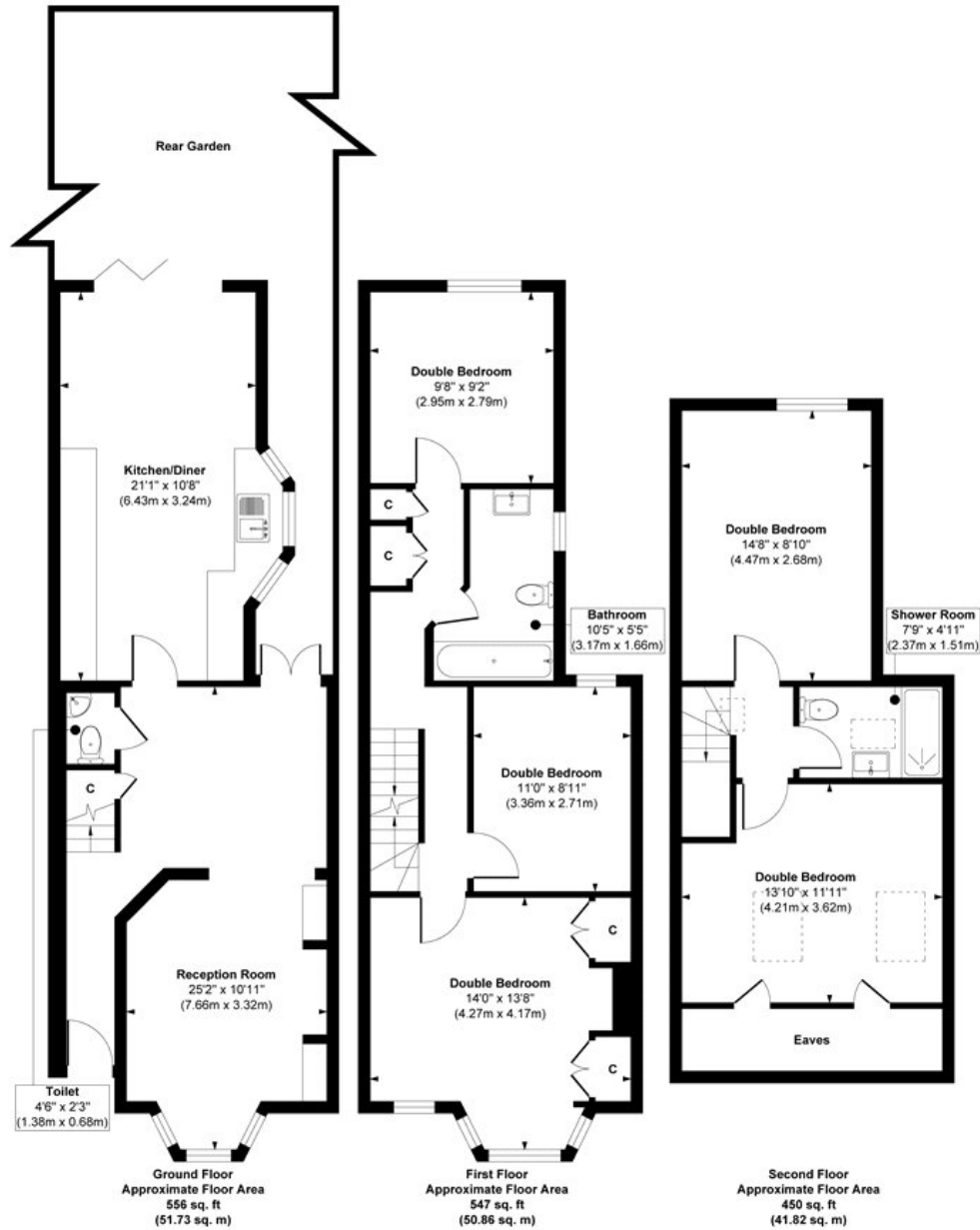

Approx. Gross Internal Floor Area 1553 sq. ft / 144.41 sq. m

Illustration for identification purposes only, measurements are approximate, not to scale.
Produced by Elements Property

This floorplan is for illustration purposes only and is not to scale. The position and size of doors, windows, appliances and other features are approximate.

AWAITING EPC

Dulwich | 020 8299 2722 | dulwich@winkworth.co.uk

Winkworth

winkworth.co.uk

See things differently

Winkworth wishes to inform prospective buyers and tenants that these particulars are a guide and act as information only. All our details are given in good faith and believed to be correct at the time of printing but they don't form part of an offer or contract. No Winkworth employee has authority to make or give any representation or warranty in relation to this property. All fixtures and fittings, whether fitted or not are deemed removable by the vendor unless stated otherwise and room sizes are measured between internal wall surfaces, including furnishings.