



MONTPELIER VALE, BLACKHEATH, SE3 0TJ
GUIDE PRICE £275,000-£300,000 LEASEHOLD

LOCATED IN THE HEART OF BLACKHEATH VILLAGE AND WITH INCREDIBLE VIEWS OVER THE HEATH IS THIS TOP FLOOR STUDIO APARTMENT, SOLD CHAIN FREE.

Blackheath | 0208 8520999 | blackheath@winkworth.co.uk

Winkworth

winkworth.co.uk

See things differently



DESCRIPTION:

Located in the heart of Blackheath Village and with incredible views over the Heath is this top floor studio apartment, sold chain free.

The property is in reasonable decorative order with potential to enhance further and spans 363 sq ft. consisting of a large (18'4x13') reception room in addition to a separate kitchen and bathroom. Additional features include, sash windows, feature fireplace and stunning views over the Heath.

Having been a successful buy to let investment for many years the property would be ideal for an investor, first time buyer or a pierre de terre. Your earliest viewing is highly recommended.

Montpelier Vale is a prestigious and sought after address nestled on the edge and directly facing the heath. It is in the heart of Blackheath Village with its array of boutique shops, restaurants and bars on your doorstep and within the catchment of two "Ofsted Outstanding" schools. Greenwich Park and the Blackheath Duck/Boat Pond are just a short walk. Blackheath Station is just 300 yards away and gives access to London Bridge, Charing Cross and Victoria amongst others.

AT A GLANCE

- studio apartment
- prime Blackheath Village location
- chain free
- second floor





Second Floor

Approx. 33.8 sq. metres (363.8 sq. feet)

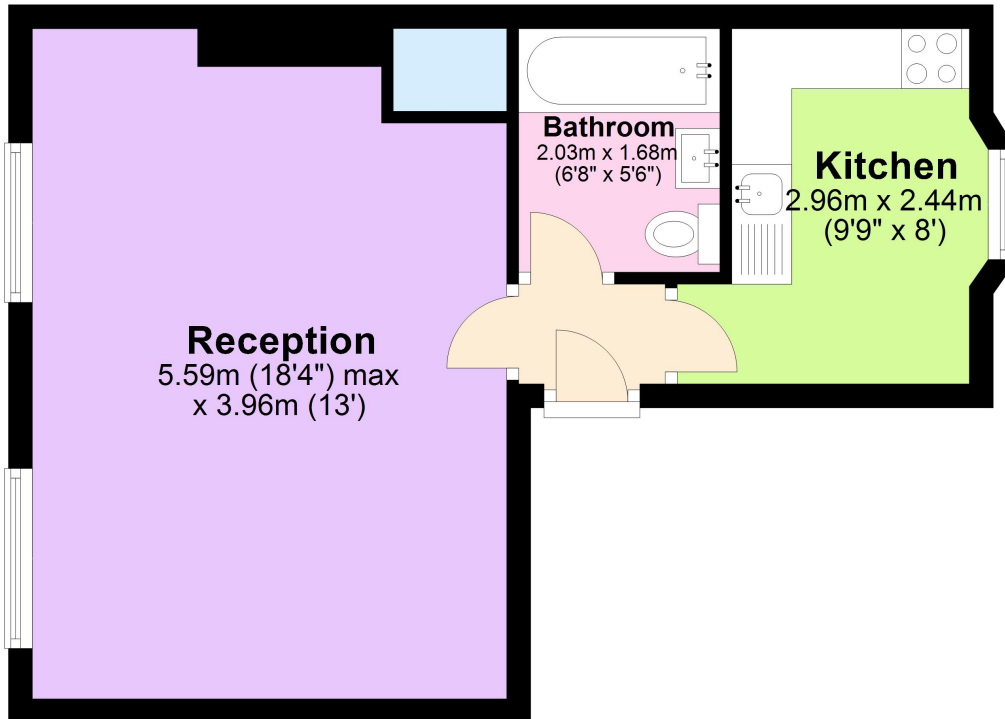

Total area: approx. 33.8 sq. metres (363.8 sq. feet)

This floorplan is for illustration purposes only and is not to scale. The position and size of doors, windows, appliances and other features are approximate. Any lease and service charge details have been provided by the vendor. Any interest party should have these checked by a solicitor as part of the purchase process.

Winkworth

winkworth.co.uk

See things differently

Winkworth wishes to inform prospective buyers and tenants that these particulars are a guide and act as information only. All our details are given in good faith and believed to be correct at the time of printing but they don't form part of an offer or contract. No Winkworth employee has authority to make or give any representation or warranty in relation to this property. All fixtures and fittings, whether fitted or not are deemed removable by the vendor unless stated otherwise and room sizes are measured between internal wall surfaces, including furnishings.