



RUSHCROFT ROAD, SW2
£550,000 FREEHOLD

A BRIGHT AND SPACIOUS THREE DOUBLE BEDROOM VICTORIAN FLAT LOCATED IN BRIXTON

Herne Hill | 0207 501 8950 | hernehill@winkworth.co.uk

Winkworth

for every step...

winkworth.co.uk



DESCRIPTION:

Winkworth proudly presents this exceptional three-bedroom Victorian apartment, occupying the second floor of the pretty exterior building of Granville House. Embraced by the rich cultural tapestry of Brixton and Herne Hill, this property offers a harmonious blend of historic charm and contemporary convenience. With an array of trendy bars, eclectic restaurants, and boutique shops just a leisurely stroll away. The allure of Brockwell Park, with its iconic Lido, adds a touch of tranquillity to the bustling urban landscape. Transportation is a breeze, with Brixton tube station and Herne Hill train station conveniently nearby, ensuring seamless connectivity to the rest of London. The property briefly comprises of three spacious double bedrooms, a semi open-plan reception and kitchen area which is bright and airy and a modern bathroom with a wash hand basin, along with a separate WC, completing the living space.





Granville House, Rushcroft Road, SW2
 Approx. Gross Internal Floor Area 832 sq. ft / 77.25 sq. m

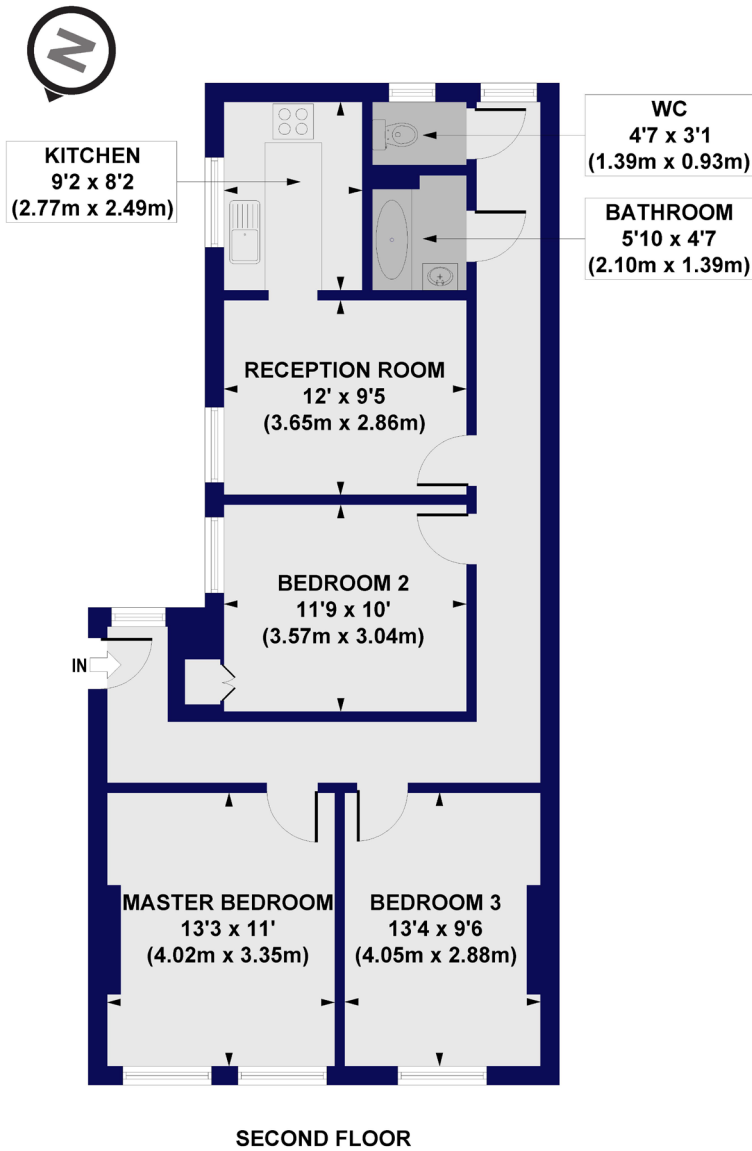

All measurements of walls, doors, windows, fittings and appliances, including their size and location, are shown as standard sizes and do not constitute any warranty or representation by the seller, their agent or CP Creative. Any intending purchaser must satisfy himself by inspection or otherwise as to the correctness of the information contained in these plans. This plan is for illustrative purposes only and should be used as such by any prospective purchasers.

Winkworth

This floorplan is for illustration purposes only and is not to scale. The position and size of doors, windows, appliances and other features are approximate.

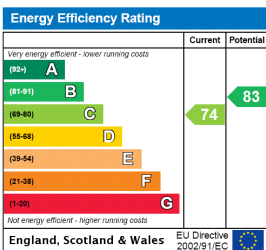

Tenure: Flying Freehold

Council Tax Band: C

Where no figures are shown, we have been unable to ascertain the information. All figures that are shown were correct at the time of printing.

Herne Hill | 0207 501 8950 | hernehill@winkworth.co.uk



for every step...

winkworth.co.uk

Winkworth wishes to inform prospective buyers and tenants that these particulars are a guide and act as information only. All our details are given in good faith and believed to be correct at the time of printing but they don't form part of an offer or contract. No Winkworth employee has authority to make or give any representation or warranty in relation to this property. All fixtures and fittings, whether fitted or not are deemed removable by the vendor unless stated otherwise and room sizes are measured between internal wall surfaces, including furnishings.