



CRESSET STREET, SW4
£400,000 LEASEHOLD

A BRIGHT ONE BEDROOM SECOND FLOOR PURPOSE BUILT FLAT

Tooting | 020 8767 5221 | tooting@winkworth.co.uk

Winkworth

for every step...

winkworth.co.uk



DESCRIPTION:

A well-presented one-bedroom flat located on the second floor of a well-maintained purpose-built building. This bright and spacious property features a large reception room, a kitchen, a bathroom with a walk-in shower, and a double bedroom.

The flat is situated on a popular residential road, conveniently close to Clapham High Street, Clapham Old Town, and Clapham Manor Primary School. The expansive Clapham Common is also nearby. Local transport links include Clapham North Underground Station (Northern Line) and both Wandsworth Road and Clapham High Street Stations (Overground). Excellent local bus services provide quick and easy access to the City, West End, and Canary Wharf.

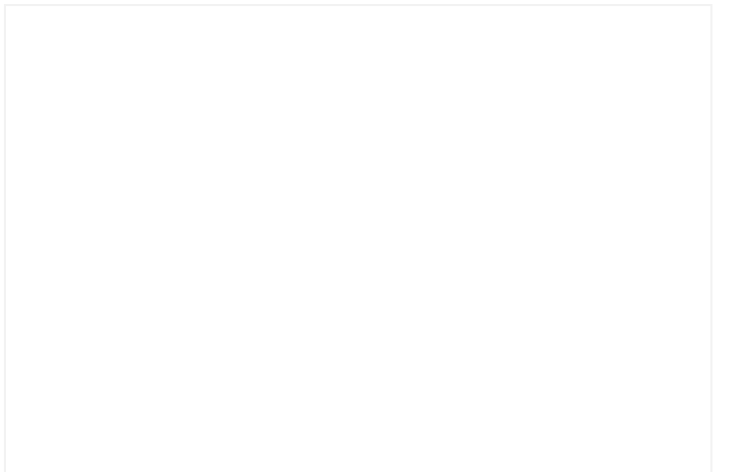
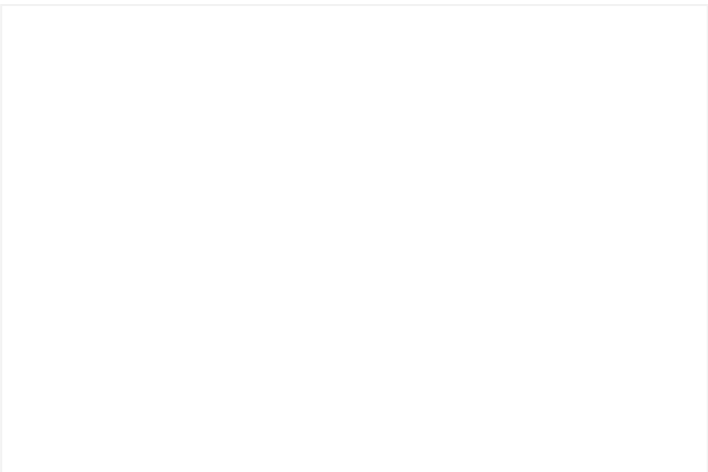
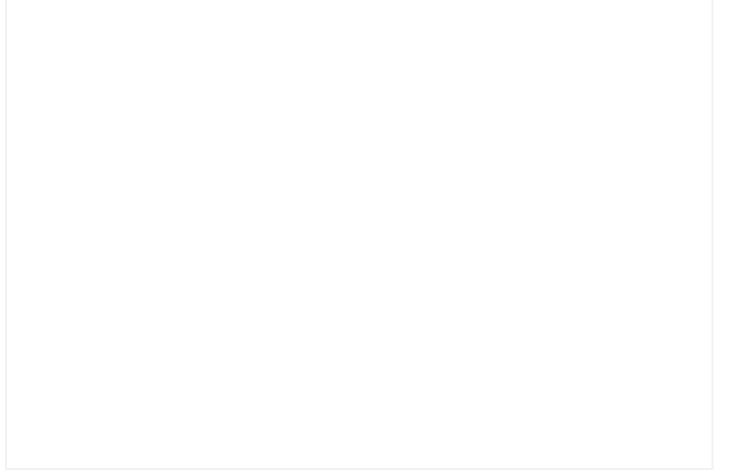
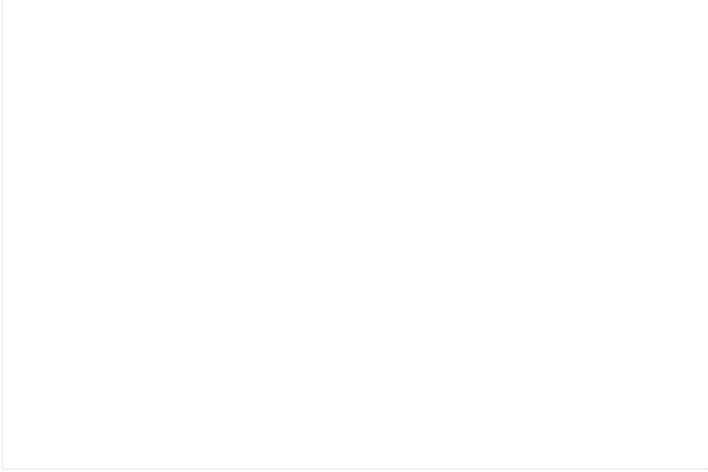

Cresset Street, SW4

Approx. Gross Internal Area *

510 Sq Ft - 47.38 Sq M

Store

6 Sq Ft - 0.56 Sq M

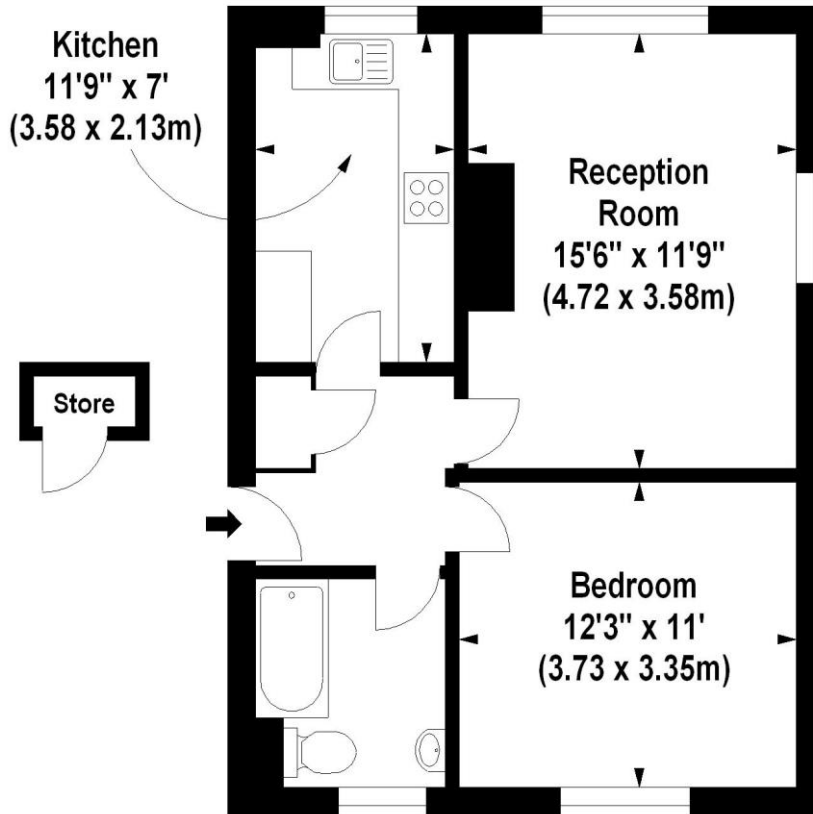
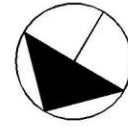

Second Floor

Illustration For Identification Purposes Only. Not To Scale

*Floorplan Drawn According To RICS Guidelines

This floorplan is for illustration purposes only and is not to scale. The position and size of doors, windows, appliances and other features are approximate.

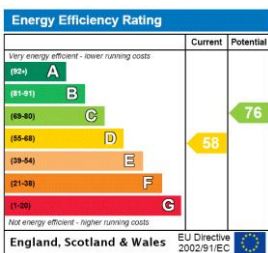

Winkworth

Tooting | 020 8767 5221 | tooting@winkworth.co.uk

for every step...

winkworth.co.uk

Winkworth wishes to inform prospective buyers and tenants that these particulars are a guide and act as information only. All our details are given in good faith and believed to be correct at the time of printing but they don't form part of an offer or contract. No Winkworth employee has authority to make or give any representation or warranty in relation to this property. All fixtures and fittings, whether fitted or not are deemed removable by the vendor unless stated otherwise and room sizes are measured between internal wall surfaces, including furnishings.