

Winkworth

Balvernie Grove, Southfields, SW18 5RP





A fantastic split-level Edwardian maisonette with private Westerly facing garden. The property is located on a popular residential street in Southfields, just moments from the outstanding Sheringdale Primary School. Accommodation includes a beautiful kitchen/dining room with direct access via a balcony area to the well maintained private garden. A separate full-width living room is found to the front of the property with large windows affording plenty of natural light. Three generous double bedrooms are serviced by two modern bathrooms. Share of Freehold.

Balvernie Grove is a popular residential road in Southfields made up of a combination of Edwardian maisonettes and houses. Ideally positioned for easy access to Southfields Village and Southfields Underground Station (District Line).

- Edwardian Maisonette
- Share of Freehold
- Private Garden
- Split-Level
- Three Bedrooms
- Two Bathrooms

# Balvernie Grove, Southfields, SW18 5RP



## Share of Freehold

Internal area

Approximate gross internal area:

**Total 1,184 sq ft / 109.99 sq m**

Council Tax Band : D

# Balvernie Grove, Southfields, SW18 5RP

## Balvernie Grove, SW18

Approx. Gross Internal Area 109.99 sq m / 1184 sq ft (Including Eaves Storage)  
 Approx. Gross Internal Area 97.92 sq m / 1054 sq ft (Excluding Eaves Storage)

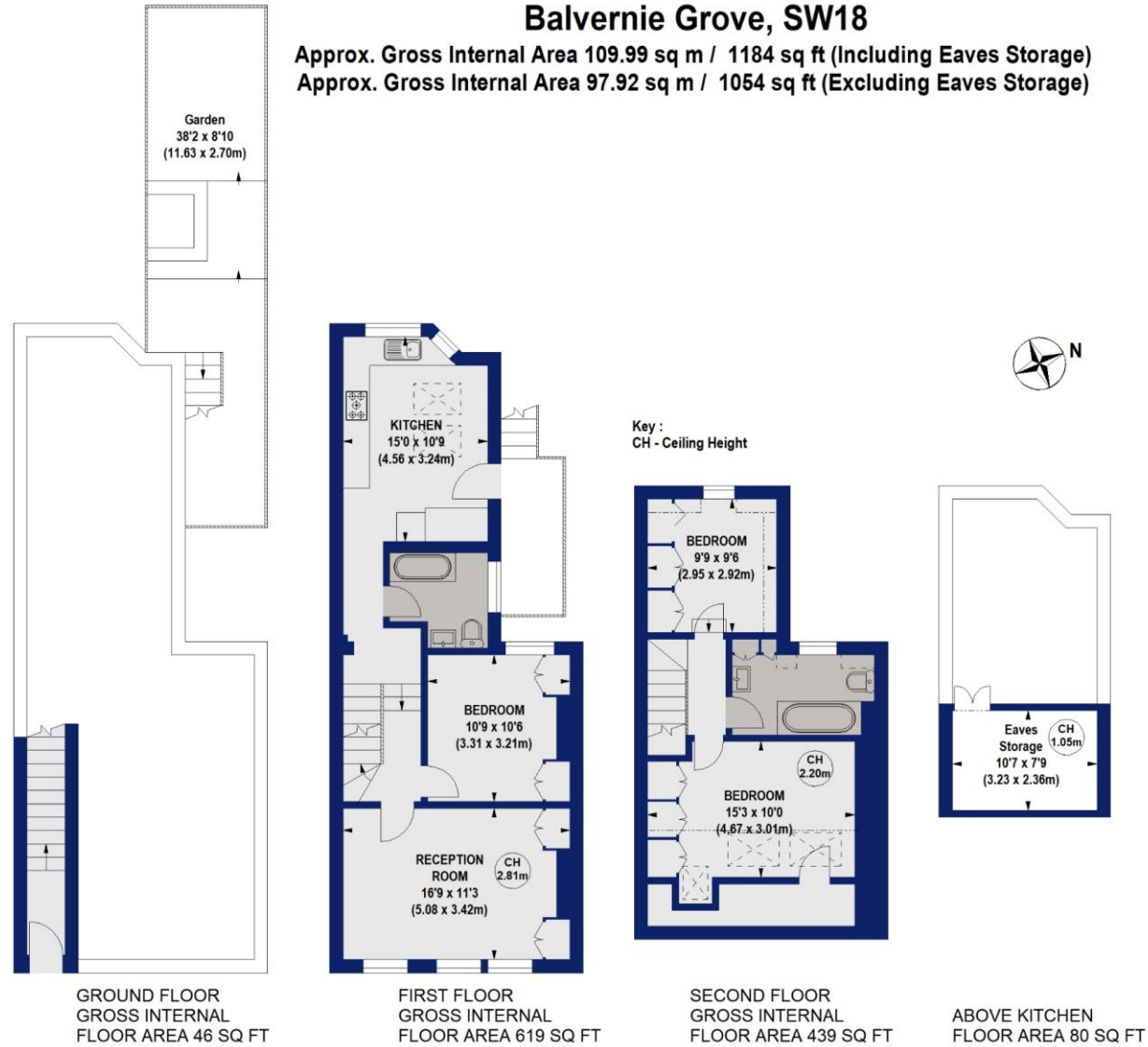

Not to scale, for guidance only and must not be relied upon as a statement of fact.  
 All measurements and areas are approximate only



W621 Ravensworth 01670 713330



Under the Property Misdescriptions Act these particulars are intended as a guide and act as information only. They give a fair overall description for the guidance of potential purchasers or tenants but do not constitute an offer or part of a contract. All details and approximate measurements are given in good faith and are believed to be correct at the time of printing, but any potential purchasers or tenants should not rely on the mis-statements or representations of fact but must satisfy themselves by inspection or otherwise as to their correctness. No employee of Winkworth has authority to make or give any representation or warranty to this property.

Southfields office 241 Wimbledon Park Road, London SW18 5RJ | Tel: 0208 877 1000 | E-mail: Southfields@winkworth.co.uk  
[winkworth.co.uk](http://winkworth.co.uk)