



GILLESPIE ROAD, LONDON, N5
£1,350,000 FREEHOLD

A BRIGHT, THREE BEDROOM, TWO
BATHROOM FREEHOLD HOUSE WITH SOUTH
FACING GARDEN IN HIGHBURY..

Highbury | 0207 989 7000 | highbury@winkworth.co.uk

Winkworth

winkworth.co.uk

See things differently



DESCRIPTION:

A charming, three double bedroom, two bathroom freehold home set moments from the Piccadilly line in Highbury, N5. Positioned on a slightly wider plot than usual, accommodation comprises of a wonderfully bright double reception room, complete with original flooring and attractive bay window. The rear of the building occupies a fully equipped kitchen with ample space for dining, and access to a mature, private south facing garden. Three good sized double bedrooms are found on the first floor, along with a modern shower room and contemporary bathroom. The property is completed with a further downstairs wc and finished to a good standard throughout.

Gillespie Road is perfectly located for a selection of fantastic transport links as well as an excellent selection of local shops. Godfrey's butchers, Bournes Fishmongers, La Fromagerie and Da Mario's deli are amongst a selection of sought-after shops at the nearby Highbury Barn whilst numerous cafes and restaurants are found on Highbury Park and Blackstock road. The property is also very close to 4 outstanding primary schools in the Highbury area. Clissold Park, Finsbury Park and Highbury Fields are all within easy reach and offer wonderfully green outdoor spaces in an incredibly central location.

Transport links are well serviced with Arsenal underground station (Piccadilly line) and Highbury & Finsbury Park station (Victoria and East London lines). Finsbury Park and Drayton Park stations are also a short

Winkworth



Winkworth

Gillespie Road, N5
Approx. Gross Internal Floor Area 1259 sq. ft / 117.00 sq. m

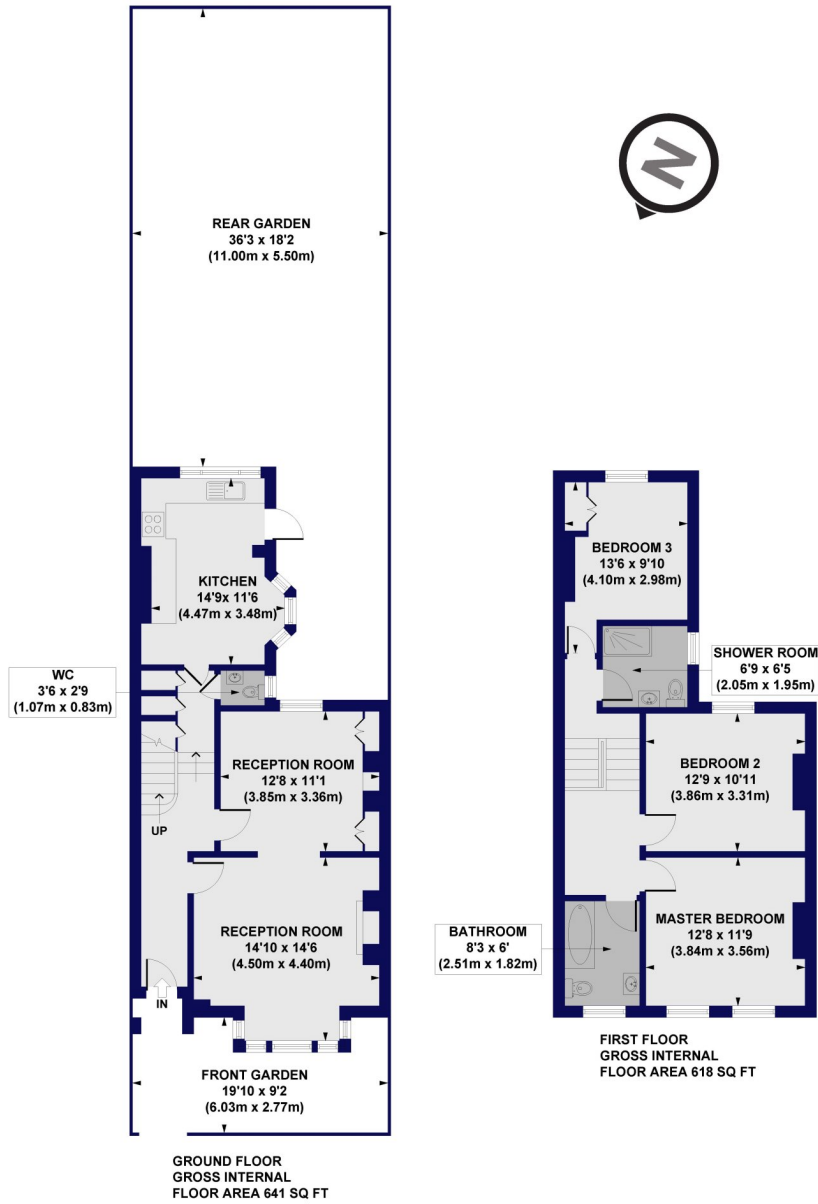

All measurements of walls, doors, windows, fittings and appliances, including their size and location, are shown as standard sizes and do not constitute any warranty or representation by the seller, their agent or CP Creative. Any intending purchaser must satisfy himself by inspection or otherwise as to the correctness of the information contained in these plans. This plan is for illustrative purposes only and should be used as such by any prospective purchasers.

Winkworth

This floorplan is for illustration purposes only and is not to scale. The position and size of doors, windows, appliances and other features are approximate.

Highbury | 0207 989 7000 | highbury@winkworth.co.uk

Winkworth

winkworth.co.uk

See things differently

Winkworth wishes to inform prospective buyers and tenants that these particulars are a guide and act as information only. All our details are given in good faith and believed to be correct at the time of printing but they don't form part of an offer or contract. No Winkworth employee has authority to make or give any representation or warranty in relation to this property. All fixtures and fittings, whether fitted or not are deemed removable by the vendor unless stated otherwise and room sizes are measured between internal wall surfaces, including furnishings.