



Winkworth

for every step...



EPC = To be confirmed

28 WHARNCLIFFE ROAD, BH23 5DE PRICE £735,000 LEASEHOLD

Winkworth

for every step...

Stunning sea views from this stylish penthouse in Highcliffe.

28 Wharncliffe Road, BH23 5DE

Price £735,000 Leasehold

01425 270055

highcliffe@winkworth.co.uk

Situation:

The property is situated in a convenient location with local shops close by. Hinton Admiral main line train station is only a short distance away with a regular service to Bournemouth, Southampton, and London Waterloo.

Within a short walk of the property are some of the area's most beautiful sandy beaches and coastline. The village of Highcliffe offers an array of cafes, restaurants, shops and two supermarkets with more extensive facilities slightly further afield at Christchurch, Bournemouth, or Southampton.

A short journey from the property is the New Forest National Park offering some of the country's most stunning countryside interwoven with ancient woodlands.

The property is also located within the popular Highcliffe School and Highcliffe St Mark's Primary School catchment areas.

Description:

Built in 2022 Azzurra is a landmark development on Wharncliffe Road, offering luxurious coastal living, high specification throughout and offering beautiful sea views.

Number 7 forms part of the top floor of the development, with striking elevations and large windows making the most of the view.

The large open plan kitchen living room offers ample space for dining and living, the kitchen has been well designed with integrated siemens cooking appliances. The focus of the room is the beautiful windows with beautiful sea views and patio doors leading to the private balcony.

There are two double bedrooms, the master suite benefiting from a range of fitted wardrobes and luxurious en-suite shower room.

The family bathroom is also finished to an exacting standard, and the utility room creates an incredibly useful space.

The property benefits from allocated parking, bike store and there is also a visitor's space in the car park.

Summary:

- Upper floor penthouse apartment with lift
- Stunning sea views
- Two double bedrooms
- Two bathrooms
- Open plan kitchen/living room
- Balcony
- Residents parking
- Leasehold 121 years 10 months

Directions:

From the Highcliffe office turn right and continue on the Lymington Road to the traffic lights. Turn right at the lights and continue down Wortley Road, follow the road round to the right and onto Wharncliffe Road where the apartment can be located along on the right hand side.



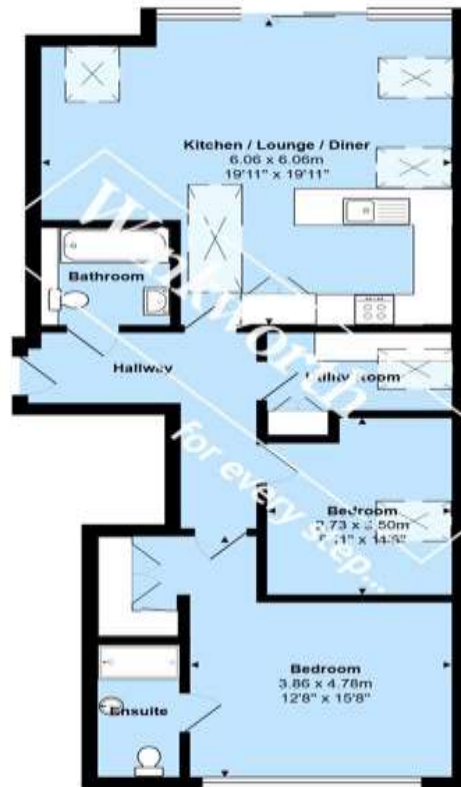

Total Area: 81.0 m² ... 872 ft²
 All measurements are approximate and for display purposes only



Winkworth wishes to inform prospective buyers and tenants that these particulars are a guide and act as information only. All our details are given in good faith and believed to be correct at the time of printing but they don't form part of an offer or contract. No Winkworth employee has authority to make or give any representation or warranty in relation to this property. All fixtures and fittings, whether fitted or not are deemed removable by the vendor unless stated otherwise and room sizes are measured between internal wall surfaces, including furnishings.

Highcliffe | 01425 270055 | highcliffe@winkworth.co.uk



for every step...