

## Bromyard House, Bromyard Avenue, W3

£450,000 Leasehold

A spacious and stylish three bedroom, two bathroom apartment with private underground parking space in this sought after gated private development.

Reception Room | Open Plan Kitchen | 3 Bedrooms | En Suite Bathroom | Shower Room | Balcony |  
872 Sq Ft / 81 Sq M | Council Tax Band F | EPC Rating Band C

**Winkworth**



### LOCATION

Bromyard House is a modern private gated development, built by Berkley Homes. Local amenities include two health and fitness clubs (David Lloyd and Mode Club), a large Tesco Metro, as well as a variety of pubs and restaurants. The closest stations are East Acton, Acton Central and Acton Mainline, with numerous bus routes from The Vale.

### DESCRIPTION

With underground parking, gated entry and concierge the redevelopment of this handsome historic building has been completed to a very high standard. The property comprises entrance hall, open plan kitchen/reception room, three bedrooms and two bathrooms. Further benefits include an underground parking space and communal gardens.





**LOCAL AUTHORITY**  
London Borough of Ealing

**TENURE**  
Leasehold.

**PRICE: £450,000 Leasehold**

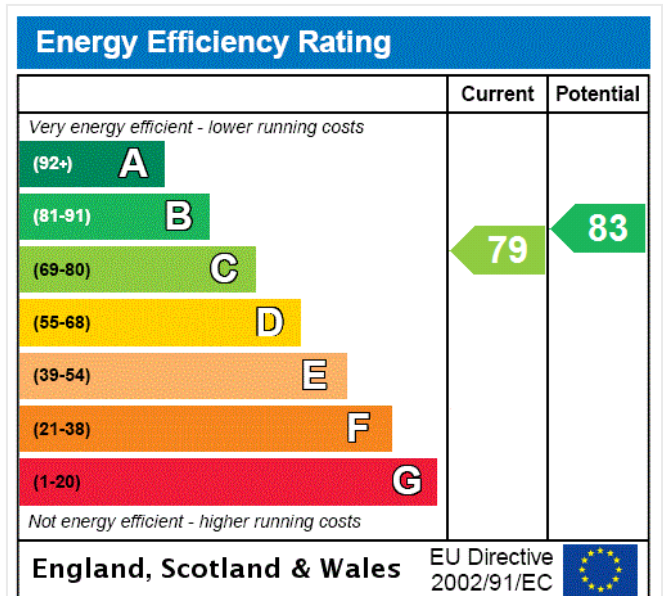

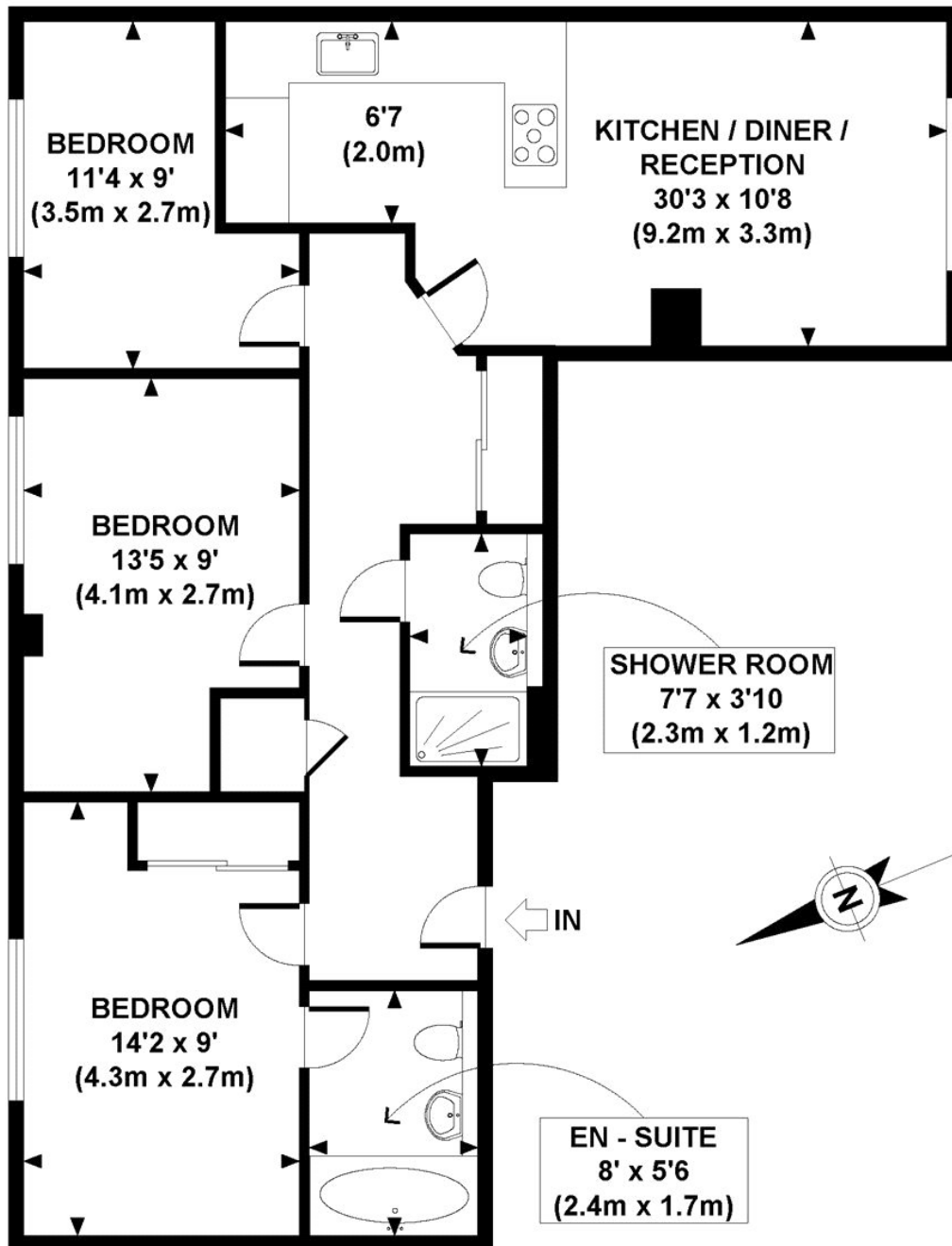

**FOURTH FLOOR  
GROSS INTERNAL  
FLOOR AREA 780 SQ FT**

APPROX. GROSS INTERNAL AREA 872 SQ FT / 81 SQ M

GCWWSB - 140410

Copyright **photoplan.co.uk**

**Floorplans are for identification and guideline purposes only, not to scale.  
Compliant with RICS code of measuring practice.**

The displayed square footage is taken from the floor plans with measurements created using the Royal Institute of Chartered Surveyors' Code of Practice for Measuring. These measurements are approximate and included for illustrative purposes only. Winkworth does not make any representation as to the accuracy of these measurements and you should seek to verify them for yourself. Winkworth accept no liability for any loss you may suffer if you rely on these measurements.

Shepherds Bush | 020 8735 3266 | [shepherdsbush@winkworth.co.uk](mailto:shepherdsbush@winkworth.co.uk)

**Winkworth**

**for every step...**

Under the Property Misdescriptions Act 1991, these Particulars are a guide and act as information only. All details are given in good faith and are believed to be correct at time of printing. Winkworth give no representation as to their accuracy and potential purchasers or tenants must satisfy themselves by inspection or otherwise as to their correctness. No employee of Winkworth has authority to make or give any representation or warranty in relation to this property.