



VERITY CLOSE, W11  
£900,000 FREEHOLD

# A FANTASTIC THREE BEDROOM MID TERRACE HOUSE IN THE HEART OF NOTTING HILL

North Kensington | 020 7792 5000 | northkensington@winkworth.co.uk

**Winkworth**

for every step...

*winkworth.co.uk*



## DESCRIPTION:

Nestled on a tree-lined street in the heart of Notting Hill, this impeccably preserved 1970's terraced house exudes mid-century charm and modern convenience.

Upon entering, you are greeted by an airy living space with good ceiling height. The well-designed kitchen, which is at the rear of the property, has masses of storage, a separate pantry and access to the garden. The kitchen has a cohesive and versatile layout with a large window which bathe the kitchen in natural light and provide views of the garden and space beyond. The first floor of the house includes two spacious bedrooms and family bathroom. The second floor comprises of a large bedroom, WC and large eaves storage, which could be converted into another bedroom. Vaulted ceilings, large windows and creative storage solutions add character and functionality to the rooms upstairs.

Situated in the heart of Notting Hill, this home offers more than just a living space: It provides an unparalleled lifestyle. The neighbourhood's vibrant energy, eclectic boutiques, and cultural treasures are all within walking distance. There are a number of primary and secondary schools close by, as well as an impressive leisure and sports centre. The property also has easy access to public transport and to London with it's vast and diverse range of amenities.

## AT A GLANCE

- Freehold House
- Large Eat-In Kitchen
- Private Garden
- Three Double Bedrooms
- Family Bathroom
- One Extra WC
- Plenty of Storage
- Potential to Extend the Eaves Space and Create Another Bedroom





# Verity Close

Approx. Total Internal Area 1278 Sq Ft - 118.73 Sq M  
(Including Restricted Height Area)

Approx. Gross Internal Area 1196 Sq Ft - 111.11 Sq M  
(Excluding Restricted Height Area)

Approx. External Area Of Garden 413 Sq Ft - 38.37 Sq M

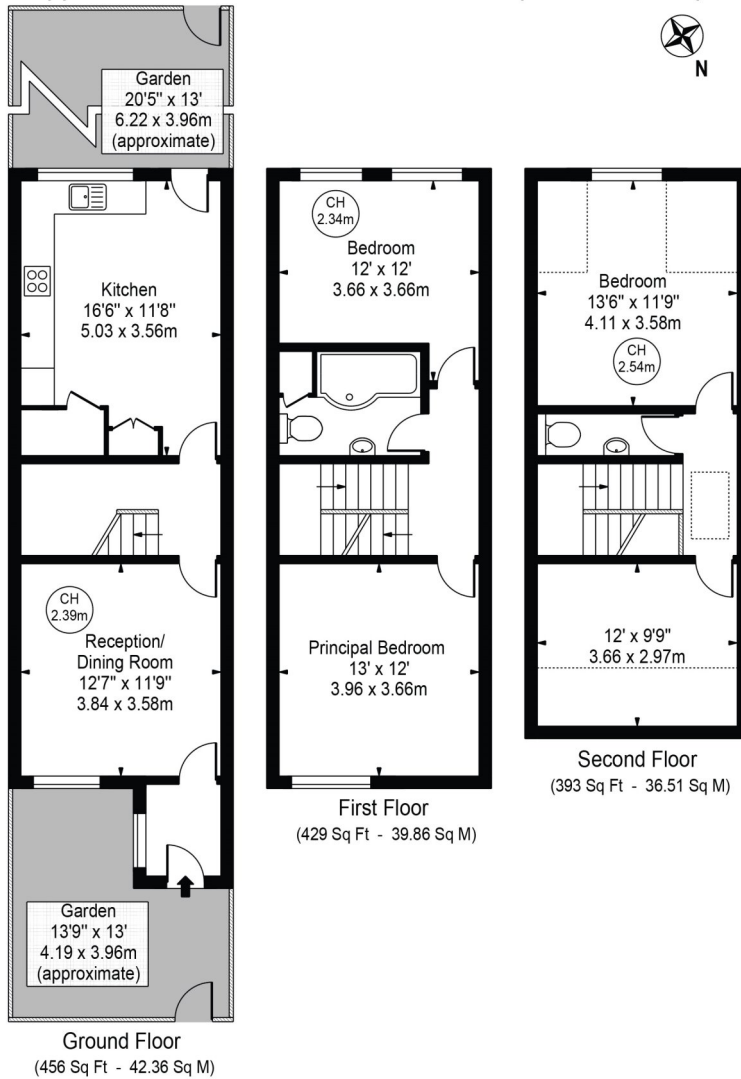

For Illustration Purposes Only - Not To Scale

This floor plan should be used as a general outline for guidance only and does not constitute in whole or in part an offer or contract. Any intending purchaser or lessee should satisfy themselves by inspection, searches, enquiries and full survey as to the correctness of each statement. Any areas, measurements or distances quoted are approximate and should not be used to value a property or be the basis of any sale or let.

Copyright Morriarti Photography & Design LTD

This floorplan is for illustration purposes only and is not to scale. The position and size of doors, windows, appliances and other features are approximate.

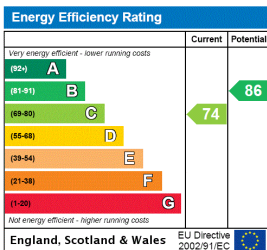

North Kensington | 020 7792 5000 | northkensington@winkworth.co.uk

**Winkworth**

for every step...

winkworth.co.uk

Winkworth wishes to inform prospective buyers and tenants that these particulars are a guide and act as information only. All our details are given in good faith and believed to be correct at the time of printing but they don't form part of an offer or contract. No Winkworth employee has authority to make or give any representation or warranty in relation to this property. All fixtures and fittings, whether fitted or not are deemed removable by the vendor unless stated otherwise and room sizes are measured between internal wall surfaces, including furnishings.