



CLARENCE PLACE, LONDON, E5  
'OFFERS IN EXCESS OF' £800,000 SHARE OF FREEHOLD

AN EXCEPTIONAL TWO DOUBLE BEDROOM WAREHOUSE  
CONVERSION IN THE HEART OF CLAPTON & A SHORT  
WALK TO HACKNEY CENTRAL STATION

Hackney | 020 8986 4216 | [hackney@winkworth.co.uk](mailto:hackney@winkworth.co.uk)

**Winkworth**

[winkworth.co.uk](http://winkworth.co.uk)

See things differently



## DESCRIPTION:

This exceptional and rarely available two double bedroom ground floor warehouse conversion on Clarence Place, E5, boasting approximately 1037 sq ft of contemporary living space. As you step inside, you're greeted by two generously proportioned double bedrooms to the left, a sleek three-piece family bathroom adds convenience and style to the living space. The heart of this residence unfolds into an impressively spacious open plan layout, featuring an expansive fully fitted kitchen with integrated appliances, a versatile reception area, and a designated dining space. The aesthetic appeal is heightened by almost floor-to-ceiling windows, which flood the interior with natural light, creating an inviting and airy ambiance. The extra-high ceilings, reaching approximately 10 ft, contribute to the overall grandeur of the flat, providing a sense of space and sophistication.

Situated in the vibrant locale of Clarence Place, E5, this property is surrounded by an array of local amenities, ensuring a convenient and enjoyable lifestyle. The neighbourhood offers a diverse range of dining options, trendy cafes, and boutique shops, making it an ideal setting for those seeking a dynamic urban experience. For outdoor enthusiasts, nearby parks provide tranquil spaces for relaxation and recreation.

Transportation links are easily accessible, with several bus routes and the local train station in close proximity, facilitating seamless connectivity to the wider city and beyond. Whether you're commuting for work or exploring the cultural richness of London, this well-connected location ensures that you are always well-connected and ready to embrace the best of city living.

**Winkworth**





**Winkworth**

Clarence Place, E5  
 Approx. Gross Internal Floor Area 1037 sq. ft / 96.38 sq. m

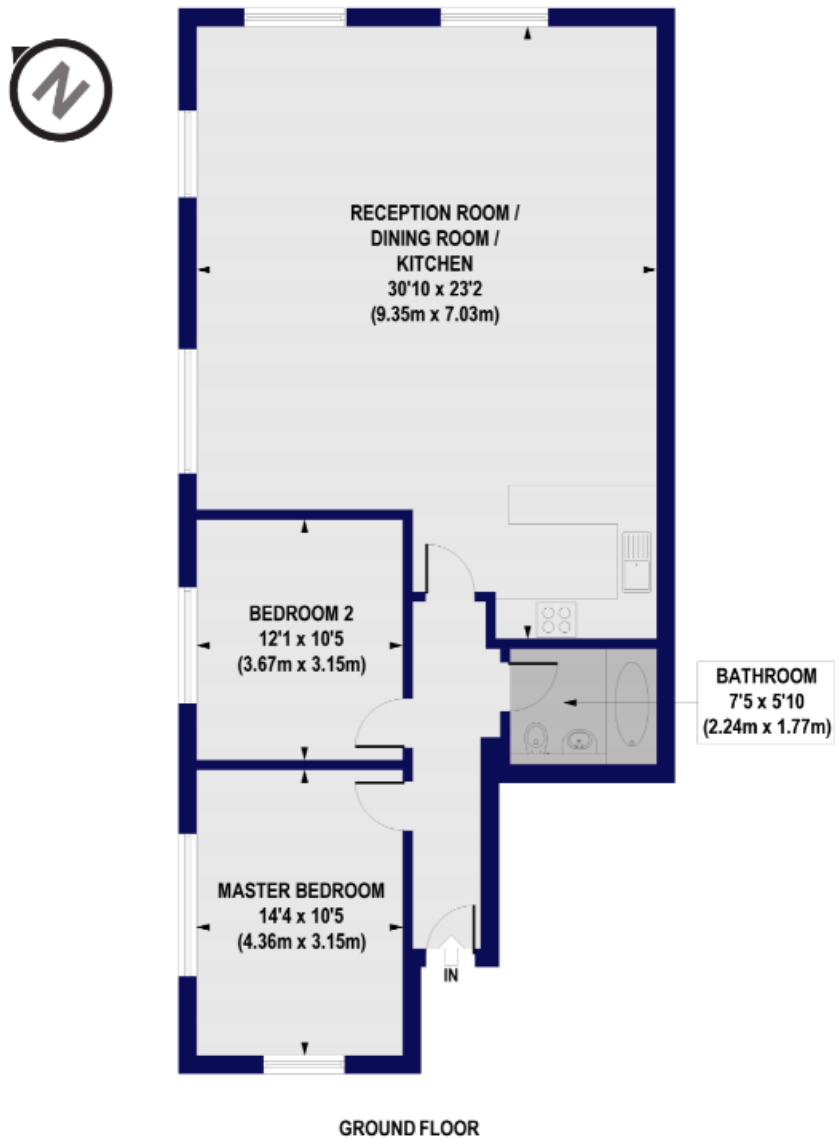

All measurements of walls, doors, windows, fittings and appliances, including their size and location, are shown as standard sizes and do not constitute any warranty or representation by the seller, their agent or CP Creative. Any intending purchaser must satisfy himself by inspection or otherwise as to the correctness of the information contained in these plans. This plan is for illustrative purposes only and should be used as such by any prospective purchasers.

**Winkworth**

This floorplan is for illustration purposes only and is not to scale. The position and size of doors, windows, appliances and other features are approximate.

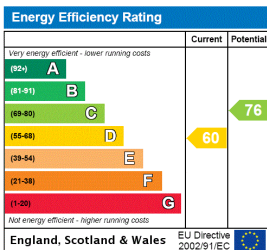

Hackney | 020 8986 4216 | [hackney@winkworth.co.uk](mailto:hackney@winkworth.co.uk)

**Winkworth**

[winkworth.co.uk](http://winkworth.co.uk)

See things differently

Winkworth wishes to inform prospective buyers and tenants that these particulars are a guide and act as information only. All our details are given in good faith and believed to be correct at the time of printing but they don't form part of an offer or contract. No Winkworth employee has authority to make or give any representation or warranty in relation to this property. All fixtures and fittings, whether fitted or not are deemed removable by the vendor unless stated otherwise and room sizes are measured between internal wall surfaces, including furnishings.