



TINNISWOOD CLOSE, LONDON, N5
£350,000 LEASEHOLD

A WONDERFUL ONE BEDROOM GROUND
FLOOR FLAT SET MOMENTS FROM THE TUBE
IN Highbury.

Highbury | 0207 989 7000 | highbury@winkworth.co.uk

Winkworth

winkworth.co.uk

See things differently



DESCRIPTION:

Positioned on the ground floor of this well-maintained purpose built block is this beautifully renovated one bedroom flat. The property boasts well-proportioned rooms throughout and benefits from an abundance of storage. Accommodation includes a generous master bedroom with inbuilt wardrobe, a tastefully decorated family bathroom, kitchen with integrated appliances and a sizeable living room that leads out to a private patio. The property further benefits from a long lease and secure, off-street parking space.

Tinniswood Close is set near to the ever-popular Highbury Fields and Highbury Barn, which boasts an array of award-winning food shops and the Highbury Barn gastro pub. There are also superb transport links with Arsenal (Piccadilly Line), Holloway Road (Piccadilly line) and Drayton Park (into Moorgate) being a very short distance away. Highbury and Islington Station (Victoria Line and Overground) and the high street shops and restaurants on Upper Street are located just across the green open space of Highbury Fields.

Winkworth



Winkworth

Tinniswood Close, N5

Approx. Gross Internal Area 420 Sq Ft - 39.02 Sq M
 Approx. Gross Patio Area 62 Sq Ft - 5.76 Sq M

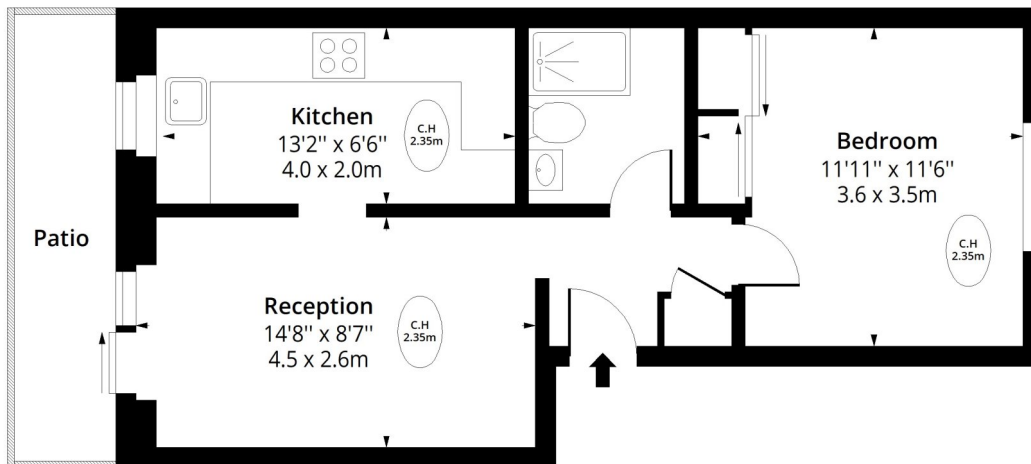

Ground Floor

Floor Area 420 Sq Ft - 39.02 Sq M



Measured according to RICS IPMS2. Floor plan is for illustrative purposes only and is not to scale. Every attempt has been made to ensure the accuracy of the floor plan shown, however all measurements, fixtures, fittings and data shown are an approximate interpretation for illustrative purposes only. 1 sq m = 10.76 sq feet.

lpaplus.com

Date: 26/9/2024

This floorplan is for illustration purposes only and is not to scale. The position and size of doors, windows, appliances and other features are approximate.

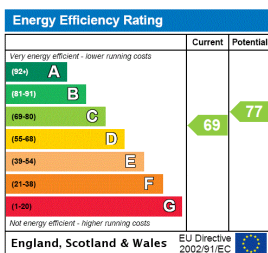

Highbury | 0207 989 7000 | highbury@winkworth.co.uk



winkworth.co.uk

See things differently

Winkworth wishes to inform prospective buyers and tenants that these particulars are a guide and act as information only. All our details are given in good faith and believed to be correct at the time of printing but they don't form part of an offer or contract. No Winkworth employee has authority to make or give any representation or warranty in relation to this property. All fixtures and fittings, whether fitted or not are deemed removable by the vendor unless stated otherwise and room sizes are measured between internal wall surfaces, including furnishings.