



RIVERSDALE ROAD, LONDON, N5
£1,500,000 FREEHOLD

A CHARMING, DOUBLE FRONTED FOUR BEDROOM FAMILY HOME IN HIGHBURY, N5.

Highbury | 0207 989 7000 | highbury@winkworth.co.uk

Winkworth

winkworth.co.uk

See things differently



DESCRIPTION:

A spacious, double fronted, four bedroom freehold house located on the ever popular Riversdale Road, set moments from Clissold Park. Walking through the front door you are greeted with the first large reception room and stairs leading up and down to further living space. Downstairs you'll find a large open plan kitchen/dining area with double doors leading out to a 39ft private garden. The second reception room is dual aspect and creates the perfect entertaining space along side the dining room to the rear. On the same floor is a three piece family bathroom, with the top floor comprises of four generous bedrooms.

Riversdale Road is located moments away from Highbury Barn which offers a selection of sought-after local independents including Godfreys butchers, La Fromagerie, Da Mario's Deli, Bourne's Fishmongers and Highbury Vintners - a magnet for locals, and also drawing those from further afield. The property is a short walk away from the green, open spaces of Highbury Fields and Clissold Park along with a yoga studio and renowned local pub on its doorstep. Easy access to the popular and vibrant Stoke Newington Church Street provides a further variety of great boutiques, restaurants and cafes.

Transport links are well serviced by a selection of excellent bus routes as well as Arsenal underground station (Piccadilly line) within short walking distance along with Highbury & Islington and Finsbury Park underground stations (Victoria line and over ground services) both nearby.

Winkworth



Winkworth

Riversdale Road, N5

Approx. Gross Internal Floor Area 1596 sq. ft / 148.28 sq. m

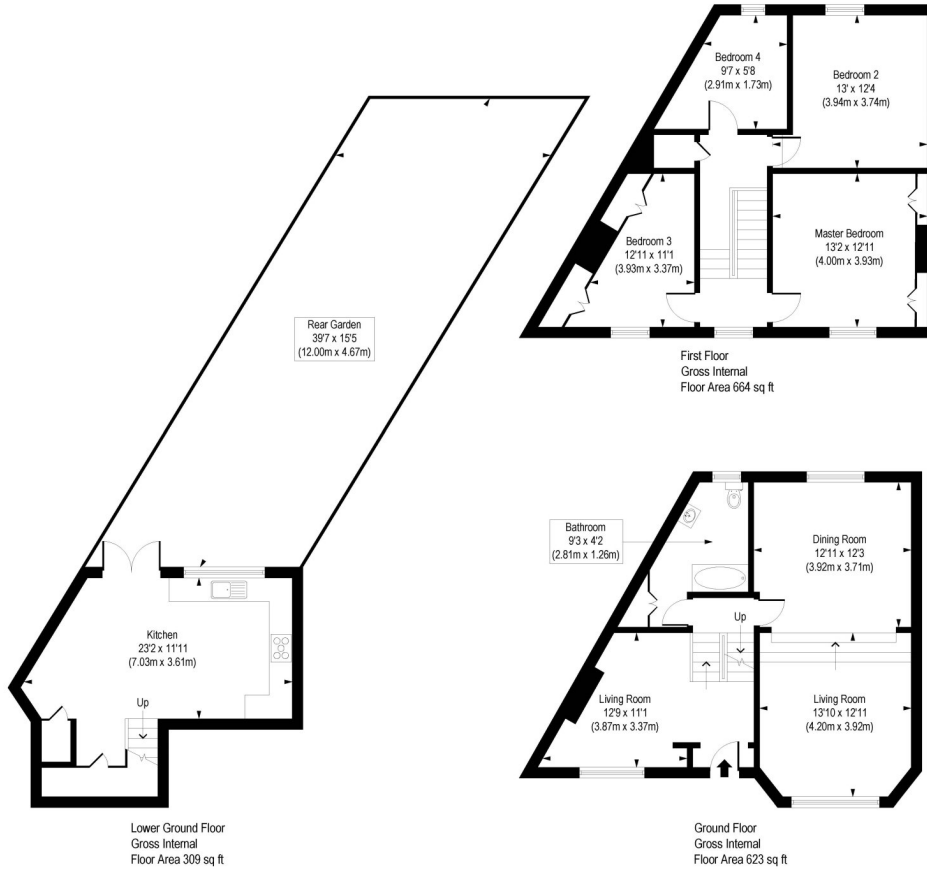
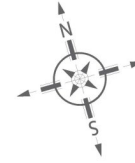

COMPLIANT WITH RICS CODE OF MEASURING PRACTICE. Floorplan is for illustrative purposes only and is not to scale. Every attempt has been made to ensure the accuracy of the floorplan shown, however all measurements, fixtures, fittings and data shown are an approximate interpretation for illustrative purposes only. Liability for errors, omissions or mis-statement through negligence or otherwise is hereby excluded.

This floorplan is for illustration purposes only and is not to scale. The position and size of doors, windows, appliances and other features are approximate.

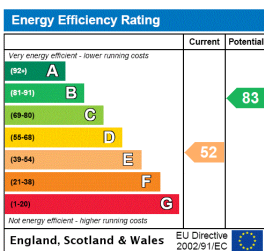

Highbury | 0207 989 7000 | highbury@winkworth.co.uk



winkworth.co.uk

See things differently

Winkworth wishes to inform prospective buyers and tenants that these particulars are a guide and act as information only. All our details are given in good faith and believed to be correct at the time of printing but they don't form part of an offer or contract. No Winkworth employee has authority to make or give any representation or warranty in relation to this property. All fixtures and fittings, whether fitted or not are deemed removable by the vendor unless stated otherwise and room sizes are measured between internal wall surfaces, including furnishings.