



MOORCROFT ROAD, SW16
£1,750 PER MONTH PART FURNISHED

A STYLISHLY PRESENTED TOP FLOOR ONE
DOUBLE BEDROOM VICTORIAN CONVERSION
FLAT CLOSE TO STRETHAM HILL STATION

Streatham | 020 8769 6699 | streatham@winkworth.co.uk

Winkworth

for every step...

winkworth.co.uk



DESCRIPTION:

Exclusively available through Winkworth, this top-floor Victorian conversion flat stands out for its tasteful presentation and spacious living areas, offering a bright and airy atmosphere. The open-plan reception/kitchen, with its wood flooring, eaves storage, two Velux windows, and a window to the side, allows ample natural light. The kitchen area features 'shaker' style fitted wall and base units, equipped with standard appliances. The double bedroom provides a generous size and a scenic view over Streatham. The shower room boasts modern fixtures, including a walk-in shower, heated towel rail, wash hand basin, fitted shelving, and a WC. Moorcroft Road which is a very quiet residential street connecting Norfolk House Road and Mount Ephraim Lane with very little traffic. The house is close to several excellent local schools as well as all the convenience and pubs/bars/restaurants of Streatham Hill and is within a short distance of Balham. Easy to commute into Central London from either Streatham Hill station or Brixton tube is a short bus ride away. At the end of the street there is access to the wide green spaces of Tooting Bec Common with its popular Lido and running track.

AT A GLANCE

- Victorian top-floor flat
- Open-plan reception/kitchen
- Generous double bedroom
- Modern shower room
- Available from 01 March
- Lambeth council tax band: B
- Part-furnished
- Great location – close to Streatham Hill station and amenities





Moorcroft Road, SW16

Approx. Gross Internal Floor Area 648 sq. ft / 60.24 sq. m (Including Restricted Height Area & Eaves)
Approx. Gross Internal Floor Area 550 sq. ft / 51.08 sq. m (Excluding Restricted Height Area & Eaves)

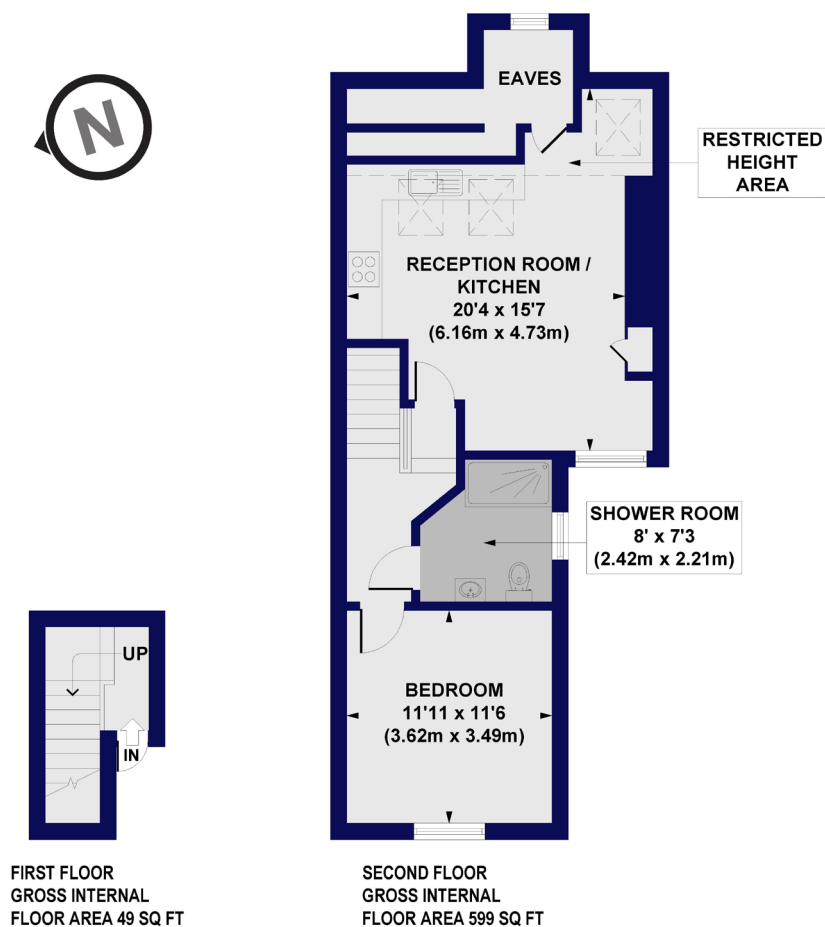

All measurements of walls, doors, windows, fittings and appliances, including their size and location, are shown as standard sizes and do not constitute any warranty or representation by the seller, their agent or CP Creative. Any intending purchaser must satisfy himself by inspection or otherwise as to the correctness of the information contained in these plans. This plan is for illustrative purposes only and should be used as such by any prospective purchasers.

Winkworth

This floorplan is for illustration purposes only and is not to scale. The position and size of doors, windows, appliances and other features are approximate.

Streatham | 020 8769 6699 | streatham@winkworth.co.uk

Winkworth

for every step...

winkworth.co.uk

Winkworth wishes to inform prospective buyers and tenants that these particulars are a guide and act as information only. All our details are given in good faith and believed to be correct at the time of printing but they don't form part of an offer or contract. No Winkworth employee has authority to make or give any representation or warranty in relation to this property. All fixtures and fittings, whether fitted or not are deemed removable by the vendor unless stated otherwise and room sizes are measured between internal wall surfaces, including furnishings.