



WELLESLEY TERRACE, LONDON, N1  
£600,000 LEASEHOLD

## A FANTASTIC TWO BEDROOM APARTMENT MOMENTS FROM OLD STREET

Islington | 0207 354 2480 | [islington@winkworth.co.uk](mailto:islington@winkworth.co.uk)

**Winkworth**

[winkworth.co.uk](http://winkworth.co.uk)

See things differently





## DESCRIPTION:

**\*\*EWS1 compliant\*\***

A wonderful two bedroom flat positioned on the second floor of this modern, well-maintained development. The property offers well-proportioned rooms throughout along with an abundance of storage. Accommodation comprises of two double bedrooms, a family bathroom, utility room, and an amazing open plan kitchen/living area making the perfect entertaining space. The property further benefits from access to a communal roof terrace, secure bike storage and is offered to the market chain free.

Wellesley Terrace is situated just off City road amongst the nest of recent award winning developments surrounding The Silicon roundabout. Old Street station offers the closest underground links on the Northern line whilst Angel underground and the shops, bars and restaurants on Upper Street are also close by. A variety of bus routes are at hand for easy access across London and international links are facilitated from St Pancras.

**Winkworth**



**Winkworth**



# Wellesley Terrace, N1

Approx. Gross Internal Floor Area 723 sq. ft / 67.21 sq. m

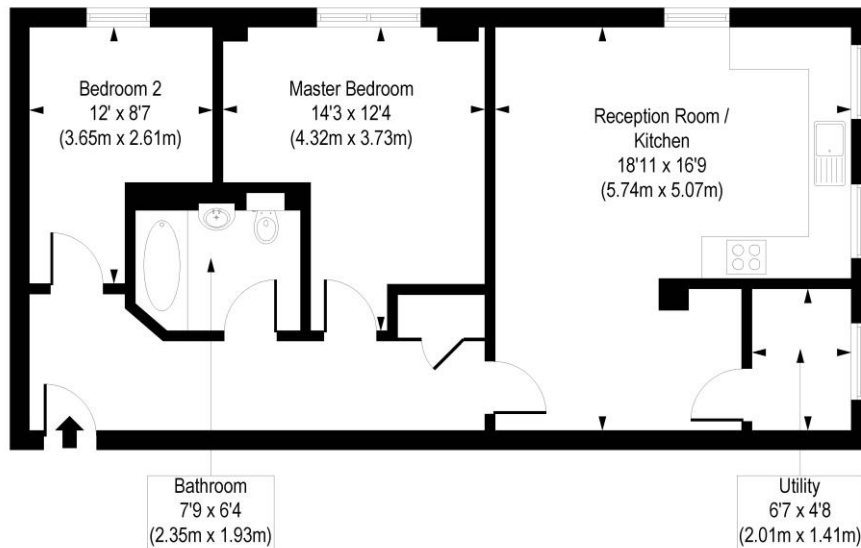
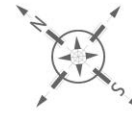

Second Floor

COMPLIANT WITH RICS CODE OF MEASURING PRACTICE. Floorplan is for illustrative purposes only and is not to scale. Every attempt has been made to ensure the accuracy of the floorplan shown, however all measurements, fixtures, fittings and data shown are an approximate interpretation for illustrative purposes only. Liability for errors, omissions or mis-statement through negligence or otherwise is hereby excluded.

This floorplan is for illustration purposes only and is not to scale. The position and size of doors, windows, appliances and other features are approximate.

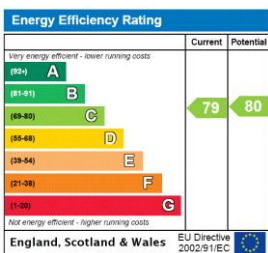

Islington | 0207 354 2480 | islington@winkworth.co.uk



winkworth.co.uk

See things differently

Winkworth wishes to inform prospective buyers and tenants that these particulars are a guide and act as information only. All our details are given in good faith and believed to be correct at the time of printing but they don't form part of an offer or contract. No Winkworth employee has authority to make or give any representation or warranty in relation to this property. All fixtures and fittings, whether fitted or not are deemed removable by the vendor unless stated otherwise and room sizes are measured between internal wall surfaces, including furnishings.