



28 Codrington Hill, London, United Kingdom, SE23 1LW

£875,000

Beautifully refurbished to a high specification throughout, three bedroom Victorian property packed with period features. Within 5 minutes of Honor Oak Park and within walking distance of Forest Hill. Good sized double reception, top of the range kitchen and private south facing garden.

Forest Hill | | foresthill@winkworth.co.uk

Winkworth



DESCRIPTION

Lovingly refurbished to an unusually high specification throughout, is this three-bedroom period property in the heart of Honor Oak Park.

The ground floor has solid wood flooring throughout and consists of formal reception and separate dining room. The space benefits from feature fireplaces, bespoke double glazed sash windows, period style radiators and quality fixtures and fittings throughout. To the rear is a well-appointed family kitchen, with sleek cabinetry, granite work tops and contemporary metro tiles. Double doors lead out to a newly paved patio with steps leading up to a pretty, private, south facing lawned garden.

The first floor consists of a spacious 14 x 13 ft master has smart fitted wardrobes, plentiful storage, three windows flooding the room in light and featuring tongue in groove detail on one wall. Two further bedrooms, one of which is a good sized double and a well-appointed family bathroom. Another great benefit of this stunning home is the opportunity to extend into the loft for an extra 1 or 2 bedrooms, demonstrable by terraced neighbours & within permitted development.

AT A GLANCE

Three Bedroom Family Home
Beautifully Presented South Facing Garden
Modern Kitchen and Bathroom Suite
Close to Transport Links
Great School Catchment Area
Potential to Extend
Close to Blythe Hill Fields
Period Features



LOCATION

Location: Codrington Hill is situated within 5 minutes of Honor Oak Park, offering a selection of amenities including restaurants, cafe's, boutique gift shops and gastro pubs. Forest Hill is also within walking distance and Honor Oak Park station offers fast and frequent connections to Canada Water with easy transfer onto the Jubilee line for West, East and Central London. Crofton Park overland is also accessible with additional transport links to Victoria and Kings Cross St Pancras. Fantastic range of sought after schools close by, as are the green spaces of Blythe Hill, Ladywell Fields and Peckham Rye Park to name a few and East Dulwich's renowned Lordship Lane with its selection of independent retailers.

CODRINGTON HILL, SE23

Approx. Gross Internal Floor Area
996 Sq. ft/90.04 Sq. m

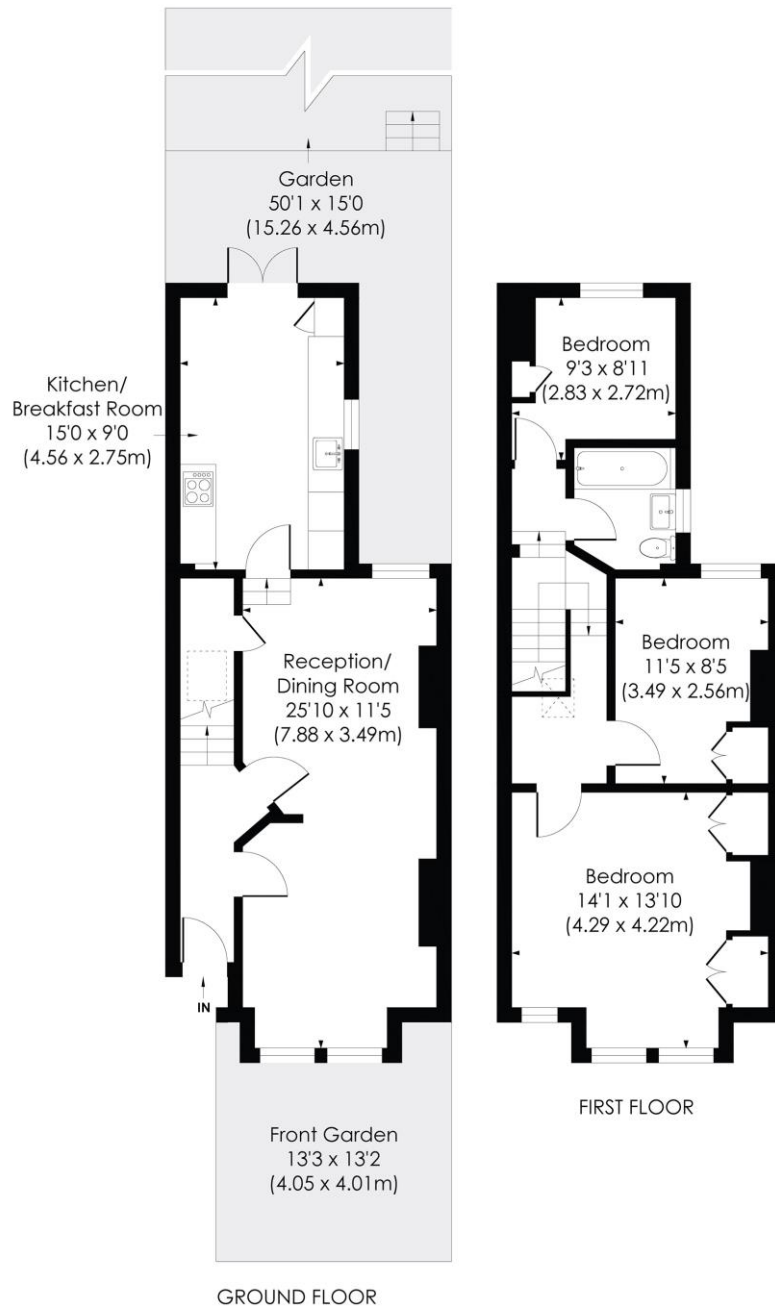

© Pixangle Property Marketing Ltd. info @pixangle.com Tel: 0208 870 2118
This floor plan has been prepared for illustration purposes only, in accordance with the latest RICS code of measuring and is not to scale. All measurements and areas are approximate and whilst every effort has been made to ensure the accuracy of the plan contained here, no responsibility is taken for any error, omission or misstatement.

NOTICE: Whilst every effort has been made to ensure the accuracy of these sales details, they are for guidance purposes only and prospective purchasers are advised to seek their own professional advice as well as to satisfy themselves by inspection or otherwise as to their correctness. No representation or warranty whatsoever is made in relation to this property by Winkworth or its employees nor do such sales details form part of any offer or contract.