



SHOOTERS HILL ROAD, BLACKHEATH, LONDON, SE3 8RN
GUIDE PRICE £500,000-£525,000 SHARE OF FREEHOLD

AN IMPRESSIVE AND VERY LARGE TWO DOUBLE BEDROOM PERIOD CONVERSION FOUND ON THE FIRST FLOOR OF THIS GRAND FOUR STOREY DETACHED VICTORIAN HOUSE WITH A STUDY, OFF STREET PARKING AND A LARGE SOUTH FACING COMMUNAL GARDEN.

Blackheath | 0208 8520999 | blackheath@winkworth.co.uk

Winkworth

winkworth.co.uk

See things differently



DESCRIPTION:

Spanning 860 sq.ft, the accommodation briefly comprises; a superb 17'6" x 15'11" living room with a feature marble fireplace and a separate study. There is a good size modern kitchen and bathroom. The master bedroom measures a generous 14'8" x 12'3" whilst the second dual aspect double bedroom is a large 12'8" x 12'8". To the rear is a large and well-kept communal garden and there is off street parking. The property is in very good decorative order with high ceilings, secondary glazed sash windows, stripped floorboards and gas fired central heating.

This is a fantastic Victorian conversion and sold with a share of the freehold. Your immediate viewing is essential. Video tours can be seen at winkworth.co.uk

The property is located just 0.6 miles from the Heath and 0.75 miles from Blackheath Village with its array of restaurants, bars, boutique shops and farmer's market. The daily conveniences of Blackheath Standard are only a few hundred yards away including an M&S food hall. The fabulous Royal Greenwich Park is just 0.8 miles with Greenwich town centre beyond. Greenwich maintains a quaint rural village feel and is steeped in history with the old Royal Naval hospital, Royal Observatory, National Maritime Museum, and the spectacularly restored Cutty Sark. Greenwich's covered market is one of London's best and attracts people from all over the capital. There are several highly sought-after Independent Schools close by including Blackheath Preparatory School, The Pointer School, Heath House Preparatory School, Blackheath High Junior School, Blackheath High Seniors School, Colfes (1.4 miles) and Eltham College (2.4 miles). There are superb transport links with Blackheath Station giving access to London Bridge, Charing Cross, and Victoria amongst others. The O2 arena is close by with the DLR, bus, riverboat, foot tunnel and cable car all within easy reach; and Canary Wharf, the City and central London are just minutes away via the Jubilee Line at North Greenwich - just one of the reasons why it's increasingly popular with professionals and commuters.

AT A GLANCE

- large period conversion
- first floor
- two large double bedrooms
- study
- high ceilings
- share of freehold
- communal garden
- off street parking





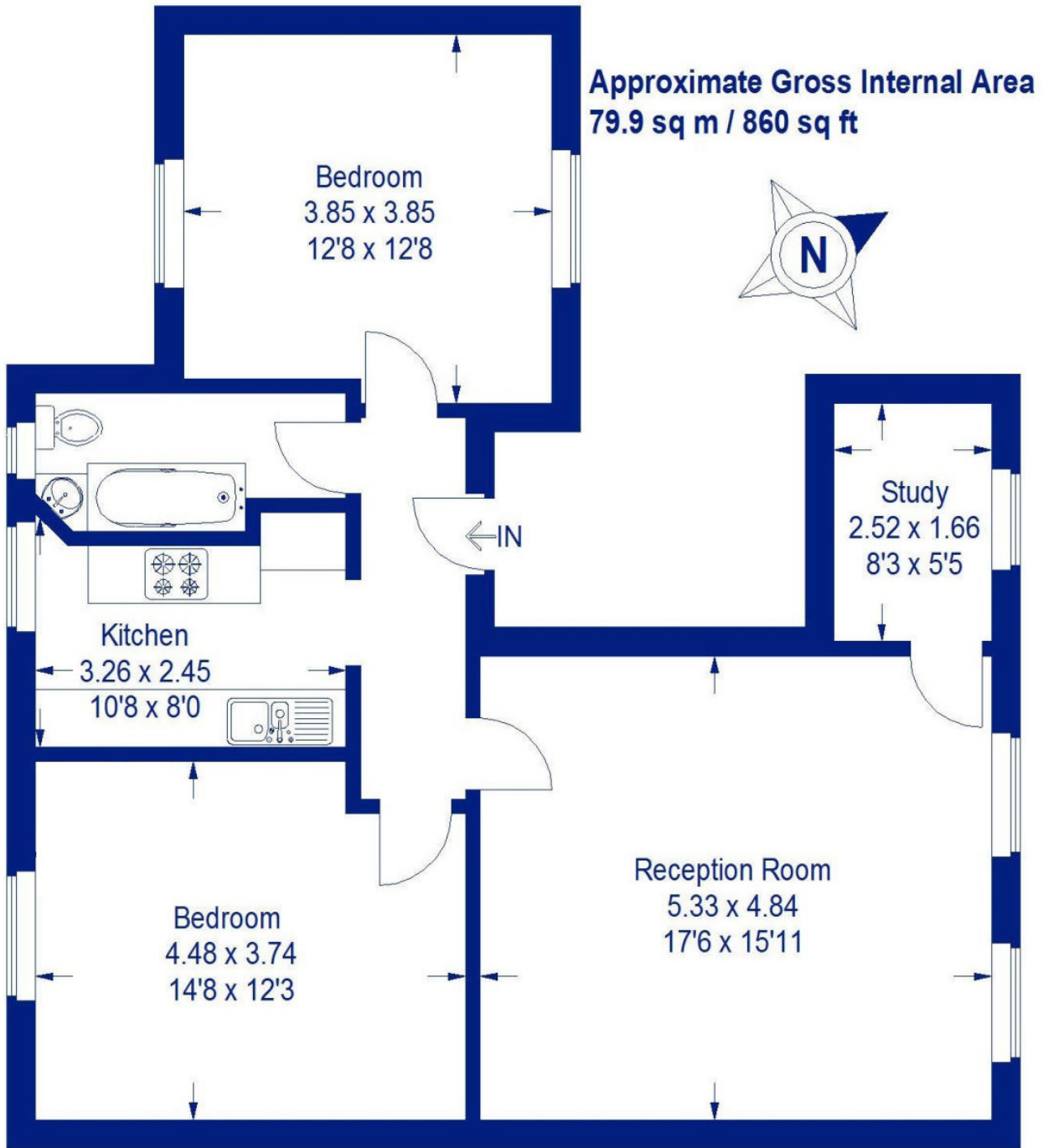

First Floor

This floorplan is for illustration purposes only and is not to scale. The position and size of doors, windows, appliances and other features are approximate. Any lease and service charge details have been provided by the vendor. Any interest party should have these checked by a solicitor as part of the purchase process.

Blackheath | 0208 8520999 | blackheath@winkworth.co.uk

Winkworth

winkworth.co.uk

See things differently

Winkworth wishes to inform prospective buyers and tenants that these particulars are a guide and act as information only. All our details are given in good faith and believed to be correct at the time of printing but they don't form part of an offer or contract. No Winkworth employee has authority to make or give any representation or warranty in relation to this property. All fixtures and fittings, whether fitted or not are deemed removable by the vendor unless stated otherwise and room sizes are measured between internal wall surfaces, including furnishings.