



HAYDON COURT, TWYFORD, READING, RG10 9EP
£900 PER MONTH UNFURNISHED

ONE BEDROOM FIRST FLOOR RETIREMENT APARTMENT LOCATED IN CENTRAL TWYFORD. AVAILABLE NOW.

Reading | 0118 4022 300 | reading@winkworth.co.uk



for every step...

winkworth.co.uk



DESCRIPTION:

One bedroom first floor retirement apartment located within a popular development in Twyford. The property is in good order throughout and benefits from new carpets. Accommodation comprises living room, separate kitchen, double bedroom with built in wardrobes and a three piece bathroom. Further benefits include communal residents lounge, lift access and residents parking (non-allocated). Available now. Unfurnished.

AT A GLANCE

- One bedroom apartment
- First floor with lift access
- Central Twyford location
- Residents parking (non-allocated)
- Council tax band C
- Available now
- Unfurnished
- ONLY AVAILABLE TO OVER 55's



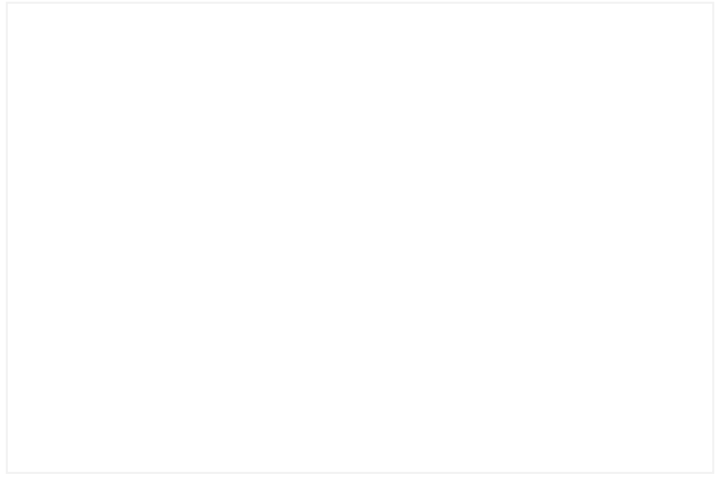

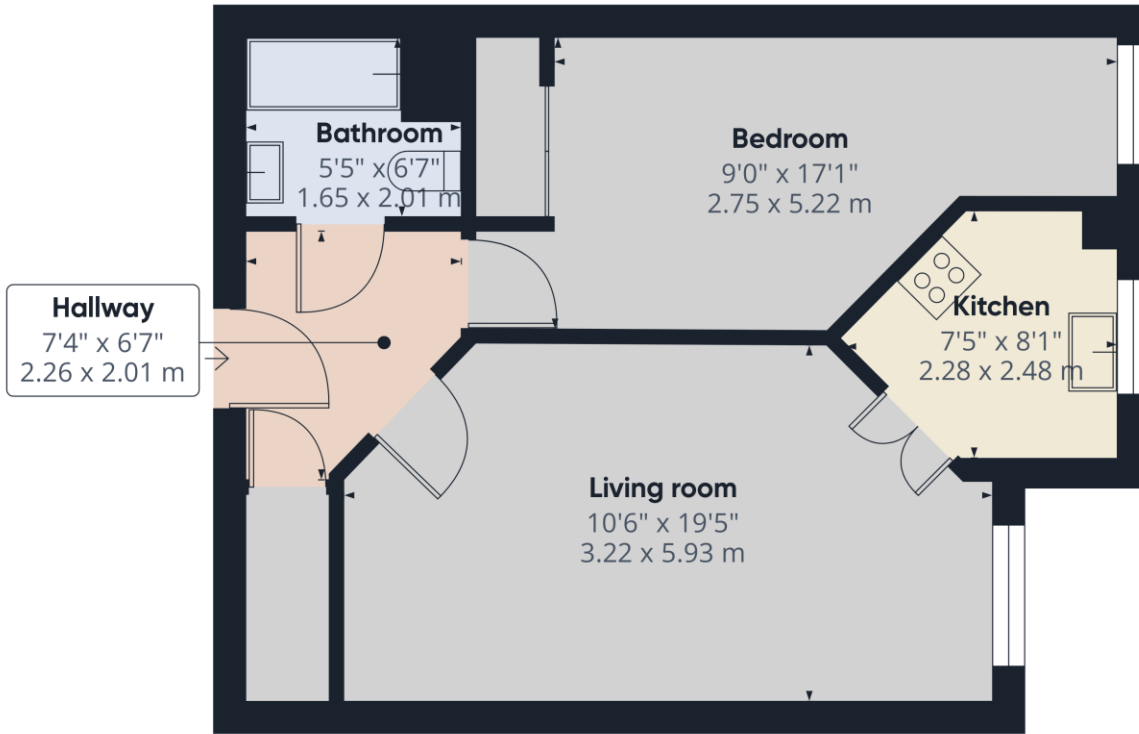

Approximate total area⁽¹⁾
 475.22 ft²
 44.15 m²

(1) Excluding balconies and terraces

While every attempt has been made to ensure accuracy, all measurements are approximate, not to scale. This floor plan is for illustrative purposes only.
 Calculations are based on RICS IPMS 3C standard.

GIRAFFE360

This floorplan is for illustration purposes only and is not to scale. The position and size of doors, windows, appliances and other features are approximate.

Deposit: £1,038.46

Holding Deposit: £207.69

Council Tax Band: C

Where no figures are shown, we have been unable to ascertain the information. All figures that are shown were correct at the time of printing.

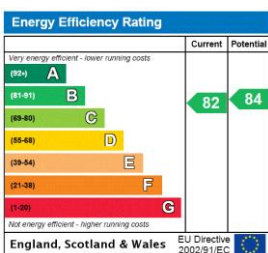

Reading | 0118 4022 300 | reading@winkworth.co.uk

Winkworth

for every step...

winkworth.co.uk

Winkworth wishes to inform prospective buyers and tenants that these particulars are a guide and act as information only. All our details are given in good faith and believed to be correct at the time of printing but they don't form part of an offer or contract. No Winkworth employee has authority to make or give any representation or warranty in relation to this property. All fixtures and fittings, whether fitted or not are deemed removable by the vendor unless stated otherwise and room sizes are measured between internal wall surfaces, including furnishings.