



FRASER HOUSE, WOOLWICH, LONDON, SE18
£330,000 LEASEHOLD

A BEAUTIFULLY PRESENTED TWO BEDROOM GROUND FLOOR FLAT, THAT IS QUIETLY LOCATED JUST OFF WOOLWICH TOWN CENTRE, IS MOMENTS FROM CROSSRAIL AND DLR, AND MEASURE CIRCA 638 SQ FT.

Greenwich | 02030533033 | greenwich@winkworth.co.uk

Winkworth

for every step...

winkworth.co.uk



DESCRIPTION:

A beautifully presented two bedroom ground floor flat, that is quietly located just off Woolwich Town centre, is moments from Crossrail and DLR, and measure circa 638 sq ft.

In excellent order throughout the property benefits from a lovely and bright reception room that leads via sliding doors onto a large private balcony. There are two double bedrooms, modern kitchen and a stunning shower room. Added benefits include storage space, double glazing, gas central heating and communal grounds.

Kingsman Street is located just to the west of Woolwich Town Centre, meaning its very close to a wide array of shops and restaurants. As mentioned, Crossrail and DLR are approx. 10 minutes walk away, within The Royal Arsenal.

AT A GLANCE

- two bedroom flat
- ground floor
- circa 638 sq ft
- lovely condition
- modern shower room
- quiet location
- moments from town centre
- short walk to Crossrail and DLR
- private balcony





Ground Floor

Approx. 59.3 sq. metres (638.0 sq. feet)

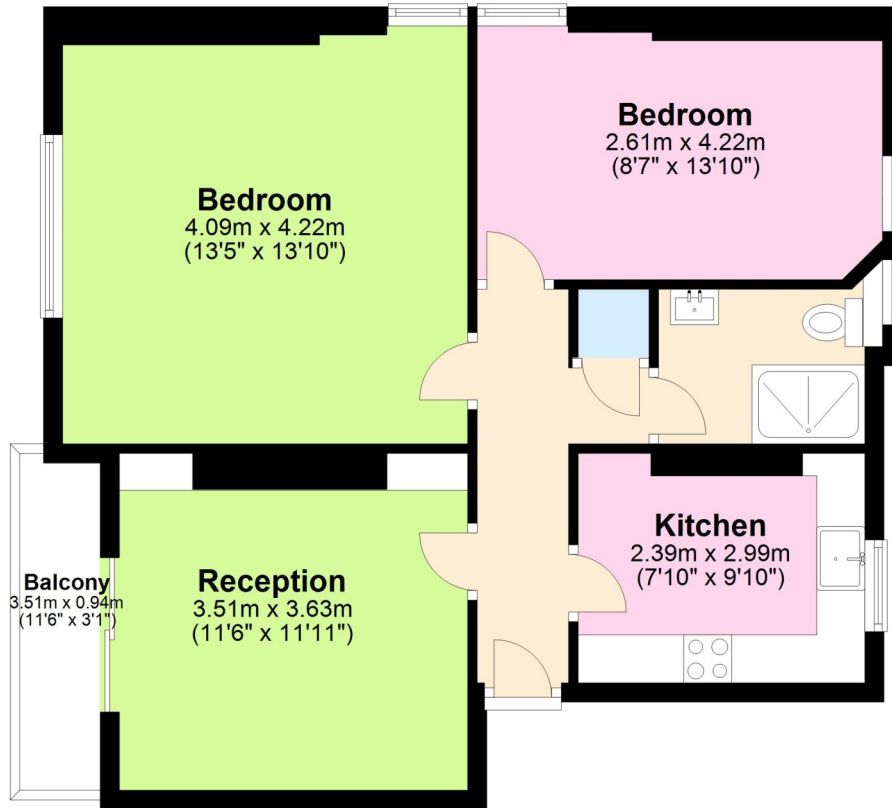

Total area: approx. 59.3 sq. metres (638.0 sq. feet)

This floorplan is for illustration purposes only and is not to scale. The position and size of doors, windows, appliances and other features are approximate.

Energy Efficiency Rating		Current	Potential
Very energy efficient - lower running costs			
(92)	A		
(81-91)	B		
(69-80)	C	77	81
(55-68)	D		
(39-54)	E		
(21-59)	F		
(1-20)	G		
Not energy efficient - higher running costs			
England, Scotland & Wales		EU Directive 2002/91/EC	

Tenure: Leasehold

Term: 114 year and 0 months

Service Charge: £1400 per annum

Ground Rent: £ 10 Annually (subject to increase)

Council Tax Band:

Where no figures are shown, we have been unable to ascertain the information. All figures that are shown were correct at the time of printing.

Greenwich | 02030533033 | greenwich@winkworth.co.uk

Winkworth

for every step...

winkworth.co.uk

Winkworth wishes to inform prospective buyers and tenants that these particulars are a guide and act as information only. All our details are given in good faith and believed to be correct at the time of printing but they don't form part of an offer or contract. No Winkworth employee has authority to make or give any representation or warranty in relation to this property. All fixtures and fittings, whether fitted or not are deemed removable by the vendor unless stated otherwise and room sizes are measured between internal wall surfaces, including furnishings.