



IVY COURT, 109 LEE ROAD, BLACKHEATH, SE3 9EA
GUIDE PRICE £300,000-£315,000 SHARE OF FREEHOLD

LOCATED JUST 0.43 MILES FROM BLACKHEATH VILLAGE, IS THIS NICELY PROPORTIONED, ONE BEDROOM FLAT FOUND ON THE GROUND FLOOR OF THIS SMALL MODERN BLOCK WITH A GARAGE, ELECTRONIC SECURITY GATES AND PLEASANT COMMUNAL GARDENS WHICH EXTEND BEYOND THE GARAGES, AND SOLD CHAIN FREE.

Blackheath | 0208 8520999 | blackheath@winkworth.co.uk

Winkworth

winkworth.co.uk

See things differently



DESCRIPTION:

The accommodation comprises, a spacious 13'9 x 12'0 living room with separate modern kitchen, an 11'11 x 9'10 double bedroom and modern bathroom with tiled surround. The property is in good decorative order with wood, double glazing and gas fired central heating.

The property has the additional benefit of an allocated parking space, garage, large communal gardens and is sold with a share of the freehold and chain free.

This is a great apartment and ideal for first time buyers, buy to let investors or as a pied de terre.

Ivy Court is a small modern block set back from Lee Road and located very close to Blackheath village (0.43 miles) which offers an array of boutique shops, bars, restaurants and farmers market, giving a genuine feeling of village life inside London. Trains from Blackheath to London Bridge take approximately 10 minutes, and approximately 25 minutes to Victoria similarly convenient for Lee Green Station (0.47 miles) and amenities. The popular open spaces of Blackheath Common, Greenwich Park and Manor House gardens are all within a short walk.

AT A GLANCE

- modern apartment
- one double bedroom
- ground floor
- separate kitchen
- off street parking
- garage
- communal gardens
- share of freehold
- chain free
- close to Blackheath Village





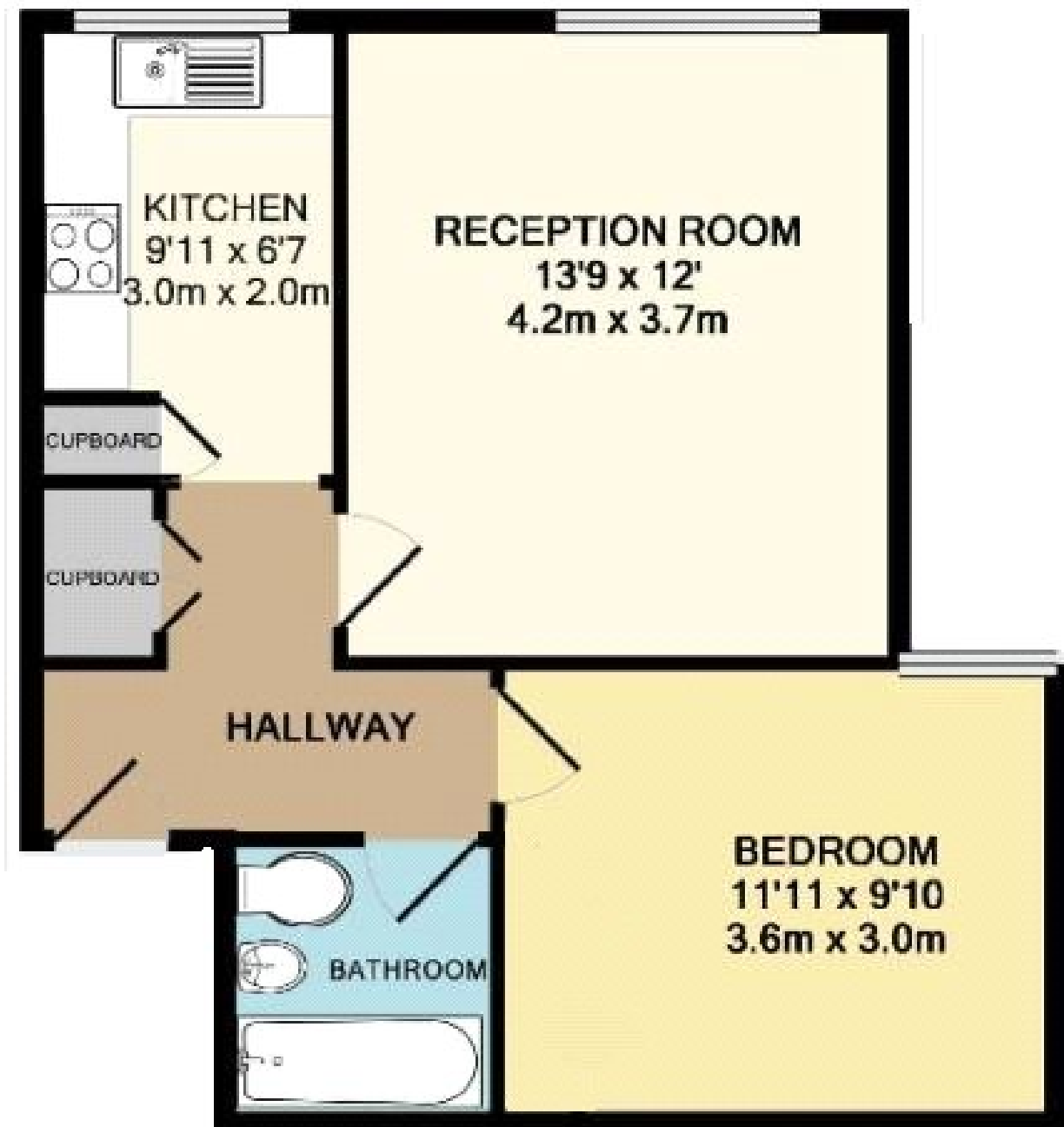

This floorplan is for illustration purposes only and is not to scale. The position and size of doors, windows, appliances and other features are approximate. Any lease and service charge details have been provided by the vendor. Any interest party should have these checked by a solicitor as part of the purchase process.

