



DAVOCH LODGE, LIVERPOOL ROAD, LONDON, N1  
£400,000 LEASEHOLD

## A SUPERB ONE BED SECOND FLOOR FLAT IN THIS PURPOSE BUILT BUILDING IN BARNSBURY

Islington | 0207 354 2480 | [islington@winkworth.co.uk](mailto:islington@winkworth.co.uk)

**Winkworth**



## DESCRIPTION:

This fantastic second floor one bedroom flat is set in the heart of Barnsbury and offers convenient living in a well-kept purpose-built block which comprises of only four flats. The property is in good condition and offers well-proportioned, light filled rooms throughout. Spanning over 500sqft, the flat consists of a bright and airy reception room, well-appointed dining kitchen with plenty of worktop and storage space, a bathroom and sizable double bedroom. The flat further benefits from an allocated shed to the rear and is offered to the market chain free.

Davoch Lodge is extremely well connected, just moments from Highbury & Islington Station (Victoria line, Overground and National Rail) and within easy reach of Caledonian Road Station (Piccadilly line) alongside several great bus routes taking you into the City and West End. The restaurants, bars and boutiques shops on Upper Street are all only a short distance away as are open spaces of Highbury Fields.

**Winkworth**



**Winkworth**

# Davoch Lodge, Liverpool Road, N1

Approx. Gross Internal Floor Area 504 sq. ft / 46.82 sq. m

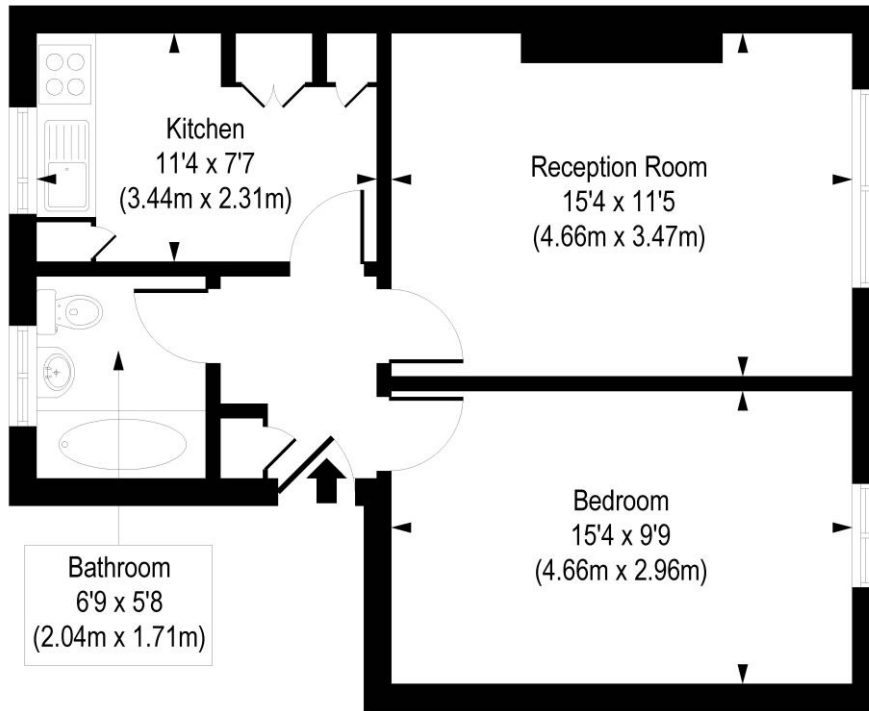
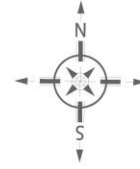

Third Floor

COMPLIANT WITH RICS CODE OF MEASURING PRACTICE. Floorplan is for illustrative purposes only and is not to scale. Every attempt has been made to ensure the accuracy of the floorplan shown, however all measurements, fixtures, fittings and data shown are an approximate interpretation for illustrative purposes only. Liability for errors, omissions or mis-statement through negligence or otherwise is hereby excluded.

This floorplan is for illustration purposes only and is not to scale. The position and size of doors, windows, appliances and other features are approximate.

Islington | 0207 354 2480 | [islington@winkworth.co.uk](mailto:islington@winkworth.co.uk)

**Winkworth**

[winkworth.co.uk](http://winkworth.co.uk)

See things differently

Winkworth wishes to inform prospective buyers and tenants that these particulars are a guide and act as information only. All our details are given in good faith and believed to be correct at the time of printing but they don't form part of an offer or contract. No Winkworth employee has authority to make or give any representation or warranty in relation to this property. All fixtures and fittings, whether fitted or not are deemed removable by the vendor unless stated otherwise and room sizes are measured between internal wall surfaces, including fumishings.