



PATROL PLACE, LONDON, SE6
£400,000 FREEHOLD

This charming 1-bedroom freehold house is situated in a peaceful residential area of London, SE6.

Winkworth

for every step...

Forest Hill | foresthill@winkworth.co.uk
winkworth.co.uk



DESCRIPTION:

This charming 1-bedroom freehold house offers an ideal opportunity for comfortable, low-maintenance living in a desirable part of London. Perfect for first-time buyers, downsizers, or those seeking a cosy retreat, the property combines practicality with charm. Featuring a private garden, bright interiors, and a convenient location, it provides a peaceful and well-connected living space that's perfect for anyone looking to enjoy a quiet yet connected lifestyle.



Winkworth

for every step...



Winkworth

for every step...



Floor 0

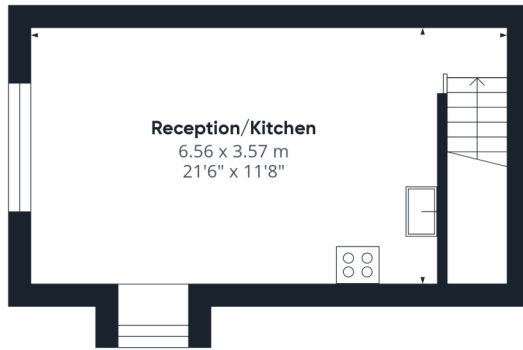

Floor 1

Approximate total area⁽¹⁾

44.65 m²
480.62 ft²

Reduced headroom

0.09 m²
0.92 ft²

(1) Excluding balconies and terraces

Reduced headroom
..... Below 1.5 m/5 ft

While every attempt has been made to ensure accuracy, all measurements are approximate, not to scale. This floor plan is for illustrative purposes only.

Calculations are based on RICS IPMS 3C standard.

GIRAFFE360

This floorplan is for illustration purposes only and is not to scale. The position and size of doors, windows, appliances and other features are approximate.

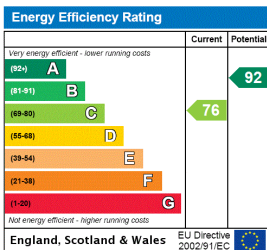

COUNCIL TAX BAND- C

LOCAL AUTHORITY - Lewisham TENURE- Freehold

SERVICES: Mains Electric, Gas, Drainage & Water.

BROADBAND: Ultrafast, Superfast & Standard Broadband Available. Checked on Openreach Nov 2024.

MOBILE SIGNAL: You are likely to have limited voice coverage with some mobile providers, you are likely to have limited data coverage with some providers

HEATING: Gas Central Heating



Forest Hill | foresthill@winkworth.co.uk

for every step...

winkworth.co.uk

Winkworth wishes to inform prospective buyers and tenants that these particulars are a guide and act as information only. All our details are given in good faith and believed to be correct at the time of printing but they don't form part of an offer or contract. No Winkworth employee has authority to make or give any representation or warranty in relation to this property. All fixtures and fittings, whether fitted or not are deemed removable by the vendor unless stated otherwise and room sizes are measured between internal wall surfaces, including furnishings.