



POINT HILL, GREENWICH, LONDON, SE10
£635,000 FREEHOLD

A TWO BEDROOM MODERN HOUSE THAT IS PERFECTLY LOCATED IN THIS QUIET SPOT JUST OFF THE OPEN HEATH AND MOMENTS FROM THE POINT! MEASURING CIRCA 619 SQ FT AND REQUIRING COMPLETE MODERNISATION. NO CHAIN!

Greenwich | 02030533033 | greenwich@winkworth.co.uk





DESCRIPTION:

A two bedroom modern house that is perfectly located in this quiet spot just off the open heath and moments from The Point! Measuring circa 619 sq ft and requiring complete modernisation. No chain!

The house is end of terrace and briefly comprises a 17 ft reception room that has sliding doors onto the rear garden. There is also a modern kitchen on the ground floor. Upstairs there are two good sized double bedrooms, with the master having fitted wardrobes, and a family bathroom. The rear garden is a good size, paved with garden shed.

Situated on the corner of Point Hill and Maiden stone Hill, this is certainly considered one of the best locations in Greenwich. As mentioned the Heath and The point are just moments away, with The Royal Park, with its Observatory, being a little further. The town centre is also close by, and offers a superb array of shops and restaurants, along with mainline rail, DLR and riverboat service. Your earliest viewing is highly recommended.

AT A GLANCE

- two bedroom house
- modern end of terrace
- requires updating
- circa 619 sq ft
- paved rear garden
- 17ft reception room
- very quiet location
- West Greenwich
- moments from The Point
- close to the Heath and Park
- short walk to town centre





Ground Floor

Approx. 28.3 sq. metres (304.6 sq. feet)

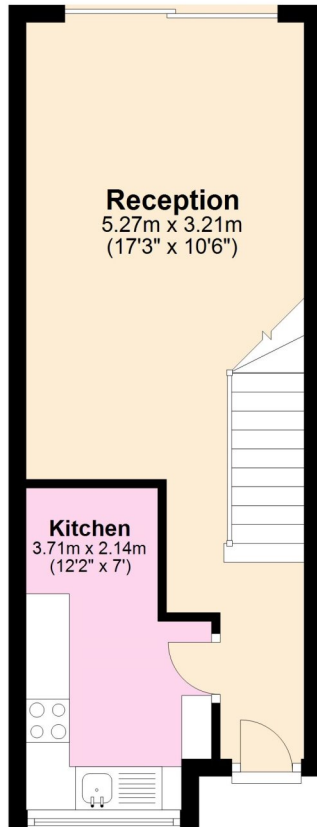

First Floor

Approx. 29.1 sq. metres (313.5 sq. feet)

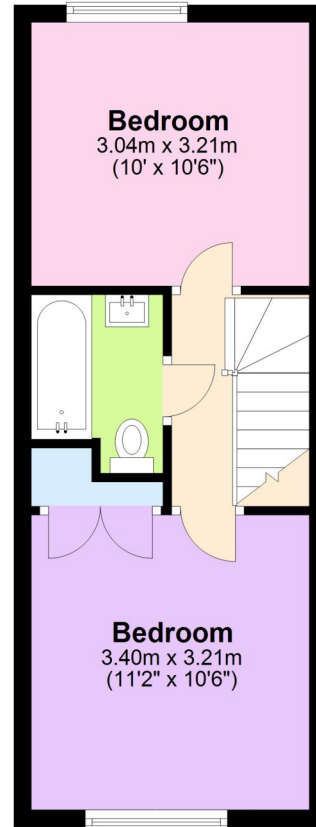

Total area: approx. 57.4 sq. metres (618.1 sq. feet)

This floorplan is for illustration purposes only and is not to scale. The position and size of doors, windows, appliances and other features are approximate.

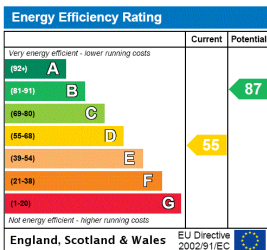

Greenwich | 02030533033 | greenwich@winkworth.co.uk

Winkworth

winkworth.co.uk

See things differently

Winkworth wishes to inform prospective buyers and tenants that these particulars are a guide and act as information only. All our details are given in good faith and believed to be correct at the time of printing but they don't form part of an offer or contract. No Winkworth employee has authority to make or give any representation or warranty in relation to this property. All fixtures and fittings, whether fitted or not are deemed removable by the vendor unless stated otherwise and room sizes are measured between internal wall surfaces, including furnishings.