



Grieg Close

Brighton Hill Basingstoke RG22 4DU

Description

This three bedroom semi-detached family home is offered for sale with no onward chain. It has good sized rooms with a large garden to the rear and has potential for extension (subject to consents).

The ground floor has a kitchen off the entrance hall and a spacious lounge/diner at the back overlooking the garden.

Upstairs there are two double bedrooms (with built-in wardrobes) and one single bedroom. The bathroom has a shower over the bath and there is a separate wc.

The integral garage has power and light with a drive for one car.

The house is located in a cul-de-sac and is conveniently situated within walking distance of schools and local shops.



Winkworth

Accommodation

- Entrance hall
- Kitchen
- Lounge/diner
- Three bedrooms
- Bathroom
- Separate WC
- Garage and driveway
- Gardens
- No onward chain

Under the Property Misdescriptions Act 1991, these Particulars are a guide and act as information only. All details are given in good faith and are believed to be correct at time of printing. Winkworth give no representation as to their accuracy and potential purchasers or tenants must satisfy themselves by inspection or otherwise as to their correctness. No employee of Winkworth has authority to make or give any representation or warranty in relation to this property.

Energy Efficiency Rating		Current	Potential
Very energy efficient - lower running costs			
(92+)	A		
(81-91)	B		81
(69-80)	C		
(55-68)	D	63	
(39-54)	E		
(21-38)	F		
(1-20)	G		
Not energy efficient - higher running costs			
England, Scotland & Wales		EU Directive 2002/91/EC	

GROUND FLOOR
503 sq.ft. (46.8 sq.m.) approx.

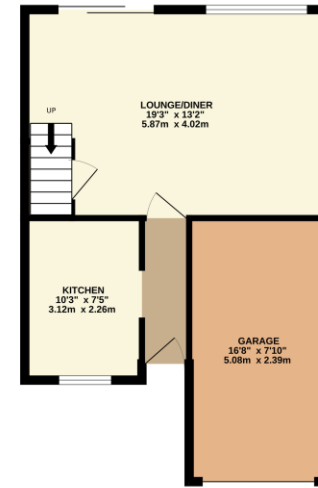

1ST FLOOR
450 sq.ft. (41.8 sq.m.) approx.

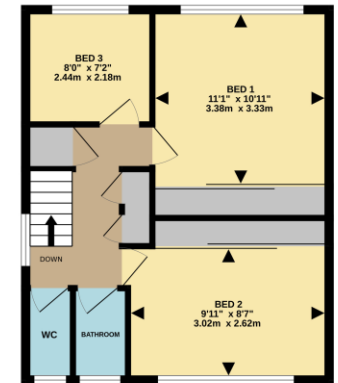

TOTAL FLOOR AREA: 953 sq.ft. (88.5 sq.m.) approx.

Whilst every attempt has been made to ensure the accuracy of the floorplan contained here, measurements of doors, windows, rooms and any other items are approximate and no responsibility is taken for any error, omission or mis-statement. This plan is for illustrative purposes only and should be used as such by any prospective purchaser. The services, systems and appliances shown have not been tested and no guarantee as to their quantity or efficiency can be given. Made with Metropack 02021



Basingstoke Office

10B Church Street, Basingstoke, Hampshire, RG21 7QE

01256 811730 | basingstoke@winkworth.co.uk

winkworth.co.uk/Basingstoke



See things differently.