



Newport Street, Tiverton, EX16 6NL

Situated on Newport Street in Tiverton, this charming two-bedroom period property exudes character, the perfect blend of traditional charm and modern convenience, making it an ideal choice for those seeking a unique and inviting living space in the heart of Tiverton.

Winkworth

Crediton: 01363 773757
crediton@winkworth.co.uk

Exeter: 01392 271177
exeter@winkworth.co.uk

Winkworth.co.uk
Tiverton: 01884 675 675
tiverton@winkworth.co.uk



DESCRIPTION:

Discover the allure of this delightful two-bedroom period property, ideally situated in Newport Street in Tiverton.

This charming home seamlessly blends historic character with modern comforts, offering a unique and inviting living space perfect for couples, or those seeking a peaceful retreat. Featuring original period details, this property exudes timeless elegance and character exposed beams, sash windows, and a beautifully preserved facade.

The welcoming living room is adorned with a cozy fireplace, providing a perfect spot to unwind, while the adjoining dining area offers ample space for entertaining guests and family gatherings.

The well-appointed kitchen combines classic style with contemporary functionality, boasting sleek countertops, ample storage, and modern appliances to cater to all your culinary needs.

Upstairs, you'll find two generously sized bedrooms, each filled with natural light and offering plenty of space for relaxation and personalization. The stylishly updated bathroom retains period charm while providing modern fixtures and a relaxing ambiance.

Nestled on Newport Street, this property enjoys the best of Tiverton's amenities, with charming local shops, cafes, and parks just a short stroll away. Excellent transport links provide easy access to nearby towns and cities.

This two-bedroom period property on Newport Street is a rare find, combining historic beauty with modern convenience. Don't miss the opportunity to make this enchanting home your own. Contact us today to arrange a viewing and experience the charm of this exceptional property firsthand

OUTSIDE:

Step outside to a serene private garden, an ideal space for outdoor dining, gardening, or simply enjoying a quiet moment.

Although there is no parking with the property, you can park on street nearby and permits are available.

Council Tax: Band A - Mid Devon

Services: Mains water, Mains electric and Main Gas

Broadband: Super-Fast Broadband Available Within This Postcode, Fibre to the Cabinet.

Mobile Signal: You are likely to get good coverage.

Tenure: Freehold

Directions:-

Using the what3words app, search:-



AT A GLANCE:

Period Property
Two Double Bedrooms
Character Features
Two Open Fireplaces
Located Close to Town
No Onward Chain
Ideal for First Time Buyers

PROPERTY INFORMATION:

Freehold
Council tax Band: A
Mains electric, gas, water and drainage.

Newport Street, Tiverton, Devon, EX16

Approximate Area = 937 sq ft / 87 sq m

For identification only - Not to scale

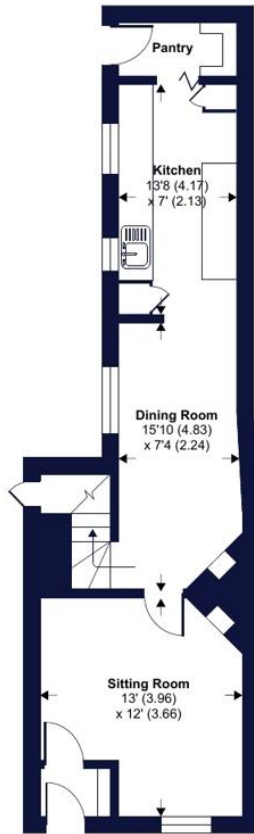

GROUND FLOOR

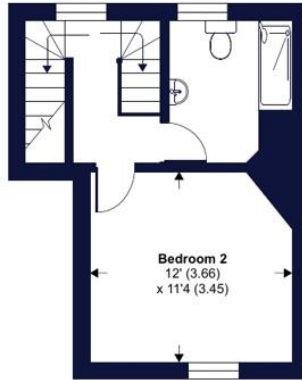

FIRST FLOOR

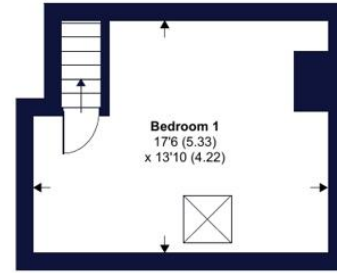

SECOND FLOOR



Certified Property Measurer

Floor plan produced in accordance with RICS Property Measurement Standards incorporating International Property Measurement Standards (IPMS2 Residential). © nichecom 2021. Produced for Winkworth. REF: 1165622

Winkworth

Energy Efficiency Rating	
	Potential
Very energy efficient - lower running costs	
(92+) A	
(81-91) B	
(69-80) C	77
(55-68) D	
(39-54) E	47
(21-38) F	
(1-20) G	
Not energy efficient - higher running costs	
England, Scotland & Wales	EU Directive 2002/91/EC

NOTICE: Whilst every effort has been made to ensure the accuracy of these sales details, they are for guidance purposes only and prospective purchasers are advised to seek their own professional advice as well as to satisfy themselves by inspection or otherwise as to their correctness. No representation or warranty whatsoever is made in relation to this property by Winkworth or its employees nor do such sales details form part of any offer or contract.

Winkworth

Crediton: 01363 773757
crediton@winkworth.co.uk

Exeter: 01392 271177
exeter@winkworth.co.uk

Tiverton: 01884 675 675
tiverton@winkworth.co.uk