



LECONFIELD ROAD, HIGHBURY, N5
£925,000 FREEHOLD

A WONDERFUL OPPORTUNITY TO PURCHASE
A FOUR BEDROOM, FREEHOLD HOUSE IN
NEED OF MODERNISATION.

Highbury | 0207 989 7000 | highbury@winkworth.co.uk

Winkworth

winkworth.co.uk

See things differently



DESCRIPTION:

Cash buyers preferred.

A fantastic opportunity to purchase a completely unmodernised, four-bedroom, freehold house on a quiet street in N5. Comprised over three floors, the property offers the perfect blend of retaining many of the original period features while being able to put your own stamp on a property. On entering at the raised ground floor, you are welcomed into an open plan living/dining space stretching over the whole floor. Four double bedrooms, two on the lower ground floor and two on the first floor, offer the opportunity for any family to grow. The property is completed by a good sized bathroom on the half landing and the kitchen on the lower ground floor leading out to a mature, private garden reaching almost 30 ft is east facing. The property is offered to the market on a chain free basis.

Leconfield Road is located within a short distance of the open green spaces of Highbury Fields and the prestigious Highbury Barn. Clissold Park is found at the end of Petherton Road, with a lido, small zoo and playground it has something for everyone. It is also just moments from the fantastic restaurants, pubs and shops of the vibrant Stoke Newington Church Street. The property is not far from Canonbury Overground, taking you straight into the City, west, east and south London. Highbury and Islington tube (Victoria Line) and Arsenal tube (Piccadilly Line) are both close to the property as are numerous bus routes taking you to the City, London Bridge and Angel.

Winkworth



Winkworth

Leconfield Road, N5

Approx. Gross Internal Floor Area 1263 sq. ft / 117.35 sq. m (Including Restricted Height Area)

Approx. Gross Internal Floor Area 1243 sq. ft / 115.50 sq. m (Excluding Restricted Height Area)

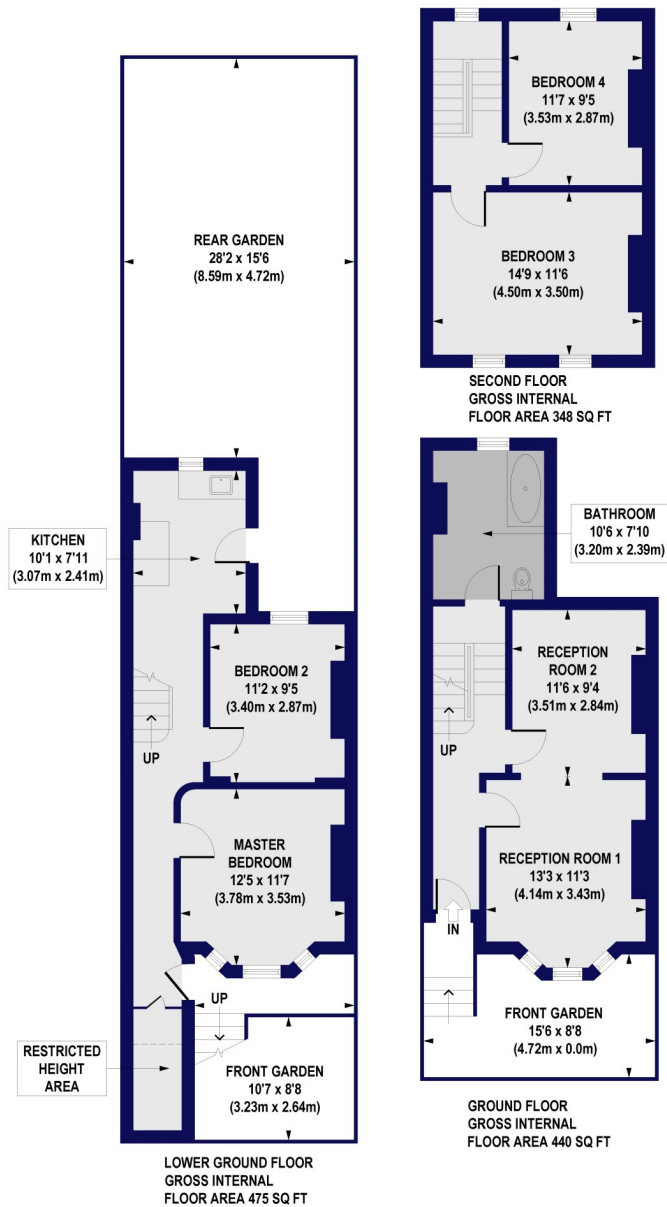

All measurements of walls, doors, windows, fittings and appliances, including their size and location, are shown as standard sizes and do not constitute any warranty or representation by the seller, their agent or CP Creative. Any intending purchaser must satisfy himself by inspection or otherwise as to the correctness of the information contained in these plans. This plan is for illustrative purposes only and should be used as such by any prospective purchasers.



This floorplan is for illustration purposes only and is not to scale. The position and size of doors, windows, appliances and other features are approximate.

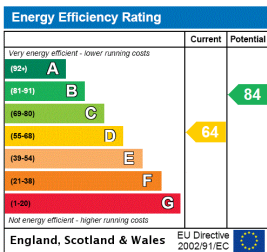

Highbury | 0207 989 7000 | highbury@winkworth.co.uk



winkworth.co.uk

See things differently

Winkworth wishes to inform prospective buyers and tenants that these particulars are a guide and act as information only. All our details are given in good faith and believed to be correct at the time of printing but they don't form part of an offer or contract. No Winkworth employee has authority to make or give any representation or warranty in relation to this property. All fixtures and fittings, whether fitted or not are deemed removable by the vendor unless stated otherwise and room sizes are measured between internal wall surfaces, including furnishings.