



RUSTON ROAD, SE18
£235,000 LEASEHOLD

WE ARE PLEASED TO OFFER THIS TWO BEDROOM ,2ND FLOOR, MODERN APARTMENT THAT MEASURES CIRCA 551 SQ FT AND WOULD MAKE A PERFECT BUY TO LET INVESTMENT. ALSO LOCATED MOMENTS FROM THE RIVER AND MAINLINE RAIL!

Greenwich | 02030533033 | greenwich@winkworth.co.uk

Winkworth

winkworth.co.uk

See things differently

DESCRIPTION:

We are pleased to offer this two bedroom ,2nd floor, modern apartment that measures circa 551 sq ft and would make a perfect BUY TO LET investment. Also located moments from the river and mainline rail!

Whilst in good decorative order, it's worth mentioning that the property would benefit from an update. We have also priced it, taking into account that there is a short lease. The accommodation comprises a wide entrance hallway and a 14ft reception room. There are two double bedrooms, family bathroom and a modern kitchen. Added benefits include electric heating, an unallocated parking spot and communal grounds. Not just a great BUY TO LET investment, but also a perfect first time buy. Ruston Road is well located on the cusp of Charlton and Woolwich, plus is just a short walk away from the river. Woolwich Dockyards mainline rail is just a short walk away, as is the local retail park, which has a large Sainsbury and M&S. Crossrail at the Woolwich Arsenal is also close by! NO CHAIN!

Second Floor

Approx. 51.3 sq. metres (551.8 sq. feet)

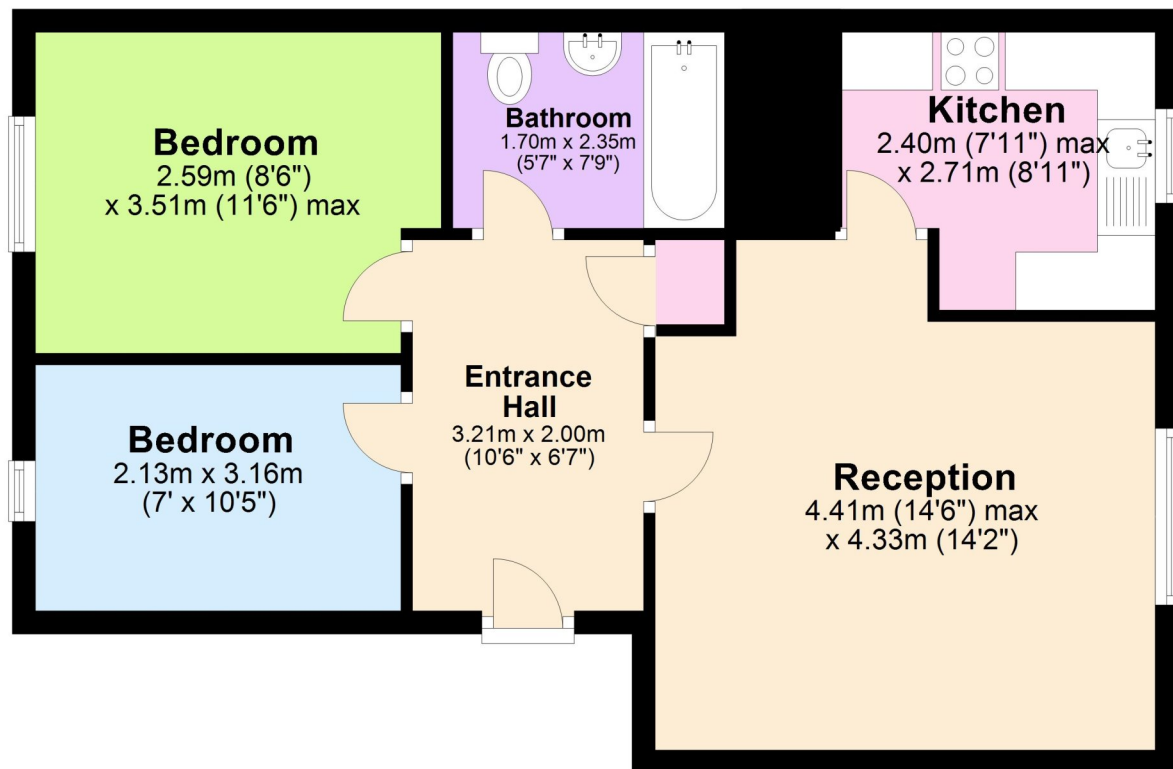

Total area: approx. 51.3 sq. metres (551.8 sq. feet)

This floorplan is for illustration purposes only and is not to scale. The position and size of doors, windows, appliances and other features are approximate.

