



SONIA GARDENS, LONDON, N12
£410,000 LEASEHOLD

A WELL-PRESENTED TWO BEDROOM GROUND FLOOR MAISONETTE

Finchley | 020 8349 3388 | finchley@winkworth.co.uk

Winkworth

for every step...

winkworth.co.uk



Winkworth

DESCRIPTION:

STAMP DUTY FREE FOR FIRST TIME BUYERS

We are pleased to offer this well-presented two bedroom ground floor maisonette set in a quiet residential turning within a stone's throw off Woodside Park underground station and North Finchley amenities. The property comprises of a spacious reception room, fully fitted kitchen, two double bedrooms, bathroom and ample storage throughout. Further benefits include a long lease, garage and residents' parking. Offered on a chain free basis.

AT A GLANCE

- GROUND FLOOR
- SPACIOUS RECEPTION ROOM
- TWO DOUBLE BEDROOMS
- FITTED KITCHEN & BATHROOM
- PARKING & GARAGE
- IDEAL LOCATION FOR TRANSPORT & AMENITIES
- OFFERED CHAIN FREE



Winkworth



Winkworth



Winkworth



Winkworth



Winkworth



Winkworth



Winkworth

Aldwick Court, Sonia Gardens, N12
 Approx. Gross Internal Floor Area 757 sq. ft / 70.34 sq. m (Excluding Garage)

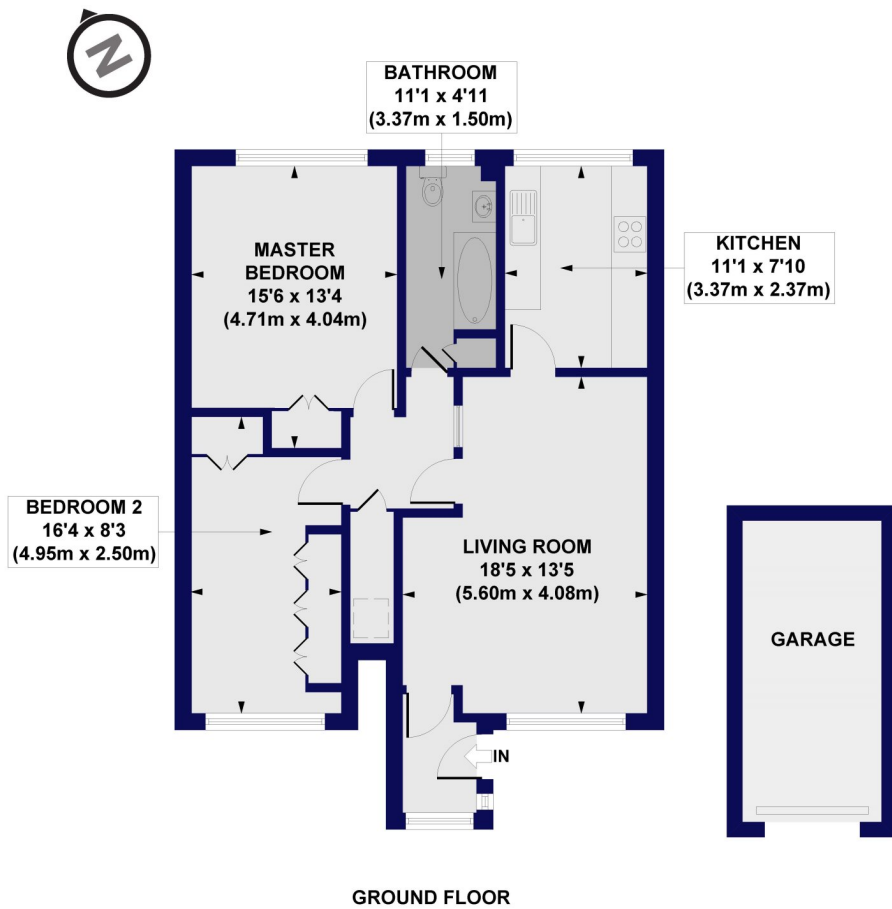

All measurements of walls, doors, windows, fittings and appliances, including their size and location, are shown as standard sizes and do not constitute any warranty or representation by the seller, their agent or CP Creative. Any intending purchaser must satisfy himself by inspection or otherwise as to the correctness of the information contained in these plans. This plan is for illustrative purposes only and should be used as such by any prospective purchasers.

Winkworth

This floorplan is for illustration purposes only and is not to scale. The position and size of doors, windows, appliances and other features are approximate.

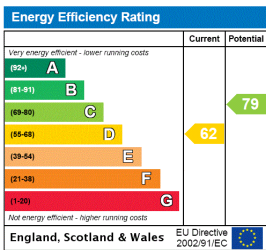

Finchley | 020 8349 3388 | finchley@winkworth.co.uk

Winkworth

for every step...

winkworth.co.uk

Winkworth wishes to inform prospective buyers and tenants that these particulars are a guide and act as information only. All our details are given in good faith and believed to be correct at the time of printing but they don't form part of an offer or contract. No Winkworth employee has authority to make or give any representation or warranty in relation to this property. All fixtures and fittings, whether fitted or not are deemed removable by the vendor unless stated otherwise and room sizes are measured between internal wall surfaces, including furnishings.