



RAILTON ROAD, SE24
£1,350 PER MONTH UNFURNISHED

**A ONE BEDROOM UPPER FLOOR FLAT WITH
STUNNING VIEWS OVER BROCKWELL PARK
IN HERNE HILL**

Herne Hill | 0207 501 8950 | hernehill@winkworth.co.uk

Winkworth

for every step...

winkworth.co.uk



DESCRIPTION:

Available exclusively through Winkworth, this property is located in central Herne Hill and gives you views of the lovely Brockwell Park with its iconic Lido. The property briefly comprises of: a good size hallway with a large walk-in storage cupboard. There is a large and bright reception diner which has a square bay with built-in window seats. There is a separate fitted kitchen equipped with the usual appliances, a bathroom with a shower over the bath and WC and a good size double bedroom with fitted wardrobes. The apartment also benefits from double glazing throughout. Herne Hill House is set in the heart of Herne Hill with a popular range of restaurants and shopping amenities on your doorstep, the vast expanse of Brockwell Park with its' iconic Lido, together with the Herne Hill railway station which gives you speedy connections via the Victoria, Blackfriars, Thameslink line. The property is offered unfurnished and is available now. Communal heating & hot water included in the rent.

AT A GLANCE

- 11th Floor Purpose Built (with Lift)
- Reception/Diner
- Separate Fitted Kitchen
- Bedroom
- Bathroom
- Storage
- Lovely Views
- Unfurnished
- Available Now





Herne Hill House, SE24

Approximate Floor Area = 55.1 sq m / 593 sq ft
Including Limited Use Area (1.6 sq m / 17 sq ft)

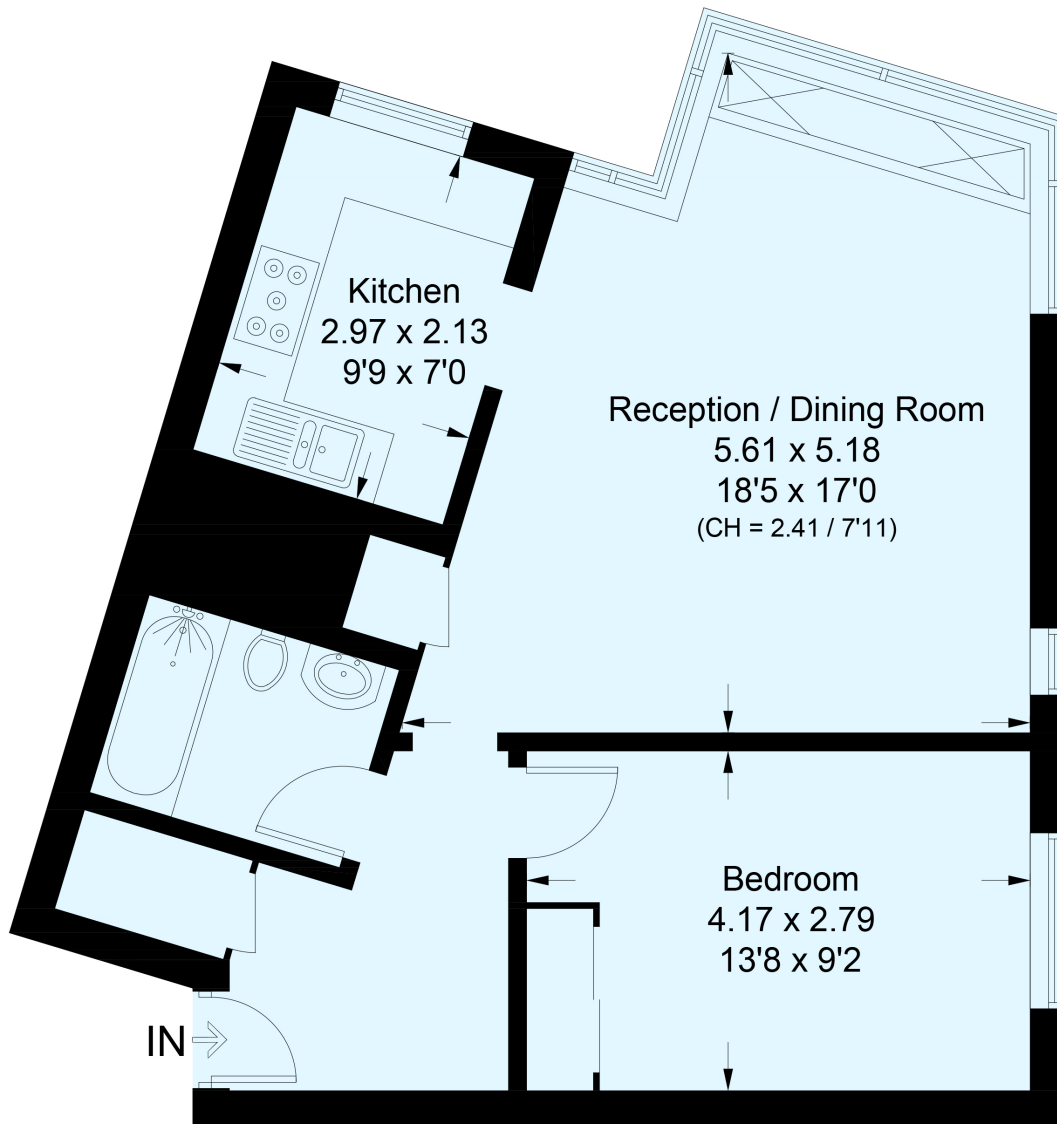

Eleventh Floor

This plan is for layout guidance only. Not drawn to scale unless stated. Windows and door openings are approximate. Whilst every care is taken in the preparation of this plan, please check all dimensions, shapes and compass bearings before making any decisions reliant upon them. (ID931963)

This floorplan is for illustration purposes only and is not to scale. The position and size of doors, windows, appliances and other features are approximate.

Herne Hill | 0207 501 8950 | hernehill@winkworth.co.uk

Winkworth

for every step...

winkworth.co.uk

Winkworth wishes to inform prospective buyers and tenants that these particulars are a guide and act as information only. All our details are given in good faith and believed to be correct at the time of printing but they don't form part of an offer or contract. No Winkworth employee has authority to make or give any representation or warranty in relation to this property. All fixtures and fittings, whether fitted or not are deemed removable by the vendor unless stated otherwise and room sizes are measured between internal wall surfaces, including furnishings.