



**NEW BRIGHT STREET, BERKSHIRE, RG1 6QQ**  
**£1,500 PER MONTH UNFURNISHED**

**MODERN TWO BEDROOM SPLIT LEVEL THIRD FLOOR APARTMENT LOCATED IN THE POPULAR HOLYBROOK DEVELOPMENT**

Reading | 0118 4022 300 | [reading@winkworth.co.uk](mailto:reading@winkworth.co.uk)

**Winkworth**

for every step...

[winkworth.co.uk](http://winkworth.co.uk)



## DESCRIPTION:

Modern two bedroom split level second floor apartment located in the popular Holybrook development in the heart of Reading Town Centre, next to the Oracle. The property has been redecorated throughout and comprises; spacious open plan living/dining area, separate kitchen, two bedrooms with fitted wardrobes, en suite shower room to the master bedroom and a further three piece bathroom. Benefits include residents parking for one car, double glazing and a security intercom system. Available now. Unfurnished.

## AT A GLANCE

- Split level town centre apartment
- Two bedrooms
- Two bathrooms
- Residents parking
- Council tax band C
- Available now
- Unfurnished



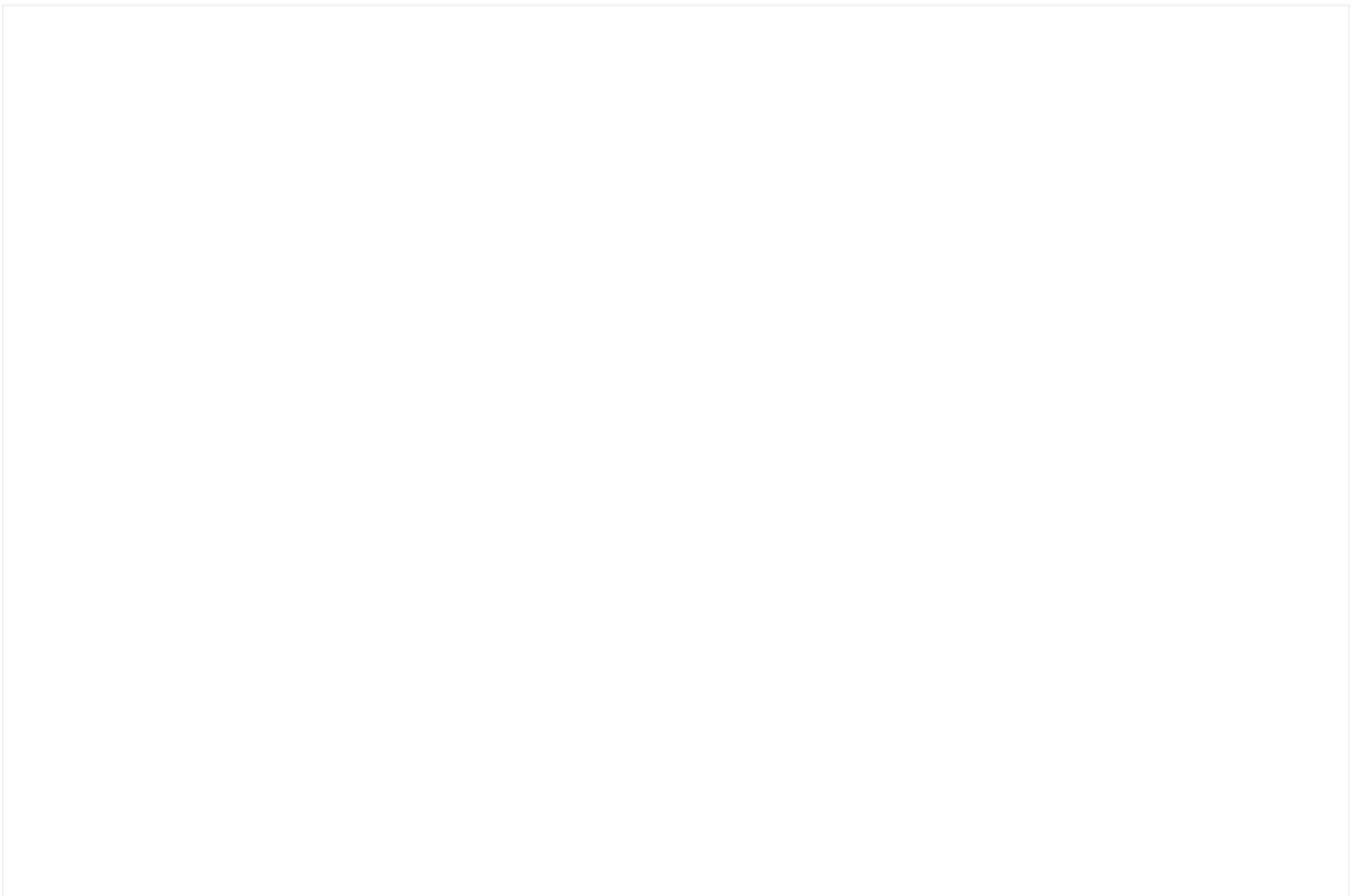
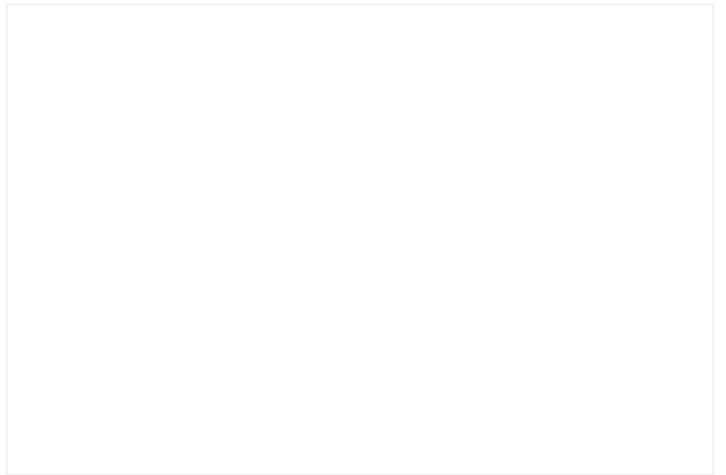

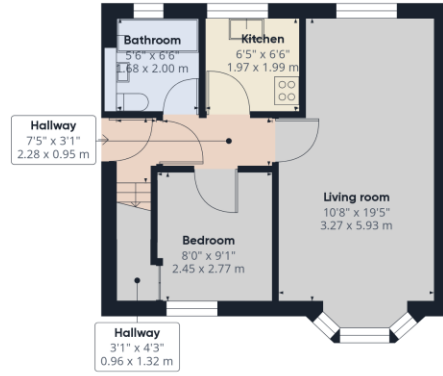

Ground Floor



Floor 1

Approximate total area<sup>(1)</sup>  
604.92 ft<sup>2</sup>  
56.2 m<sup>2</sup>

(1) Excluding balconies and terraces

While every attempt has been made to ensure accuracy, all measurements are approximate, not to scale. This floor plan is for illustrative purposes only.  
Calculations are based on RICS IPMS 3C standard.

GIRAFFE360

This floorplan is for illustration purposes only and is not to scale. The position and size of doors, windows, appliances and other features are approximate.

Deposit: £1,730.77

Holding Deposit: £346.15

Council Tax Band: C

Where no figures are shown, we have been unable to ascertain the information. All figures that are shown were correct at the time of printing.

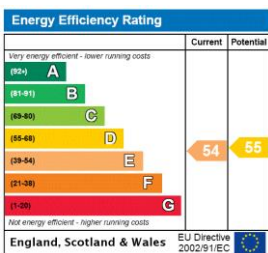

Reading | 0118 4022 300 | reading@winkworth.co.uk

**Winkworth**

for every step...

winkworth.co.uk

Winkworth wishes to inform prospective buyers and tenants that these particulars are a guide and act as information only. All our details are given in good faith and believed to be correct at the time of printing but they don't form part of an offer or contract. No Winkworth employee has authority to make or give any representation or warranty in relation to this property. All fixtures and fittings, whether fitted or not are deemed removable by the vendor unless stated otherwise and room sizes are measured between internal wall surfaces, including furnishings.