



BROWNLOW ROAD, N11
£650,000 FREEHOLD

**A STUNNING TWO BEDROOM HOUSE IDEALLY
LOCATED FOR THOSE LOOKING FOR ACCESS INTO
THE CITY AND THE WEST END.**

Palmers Green | 020 8920 9900 | palmersgreen@winkworth.co.uk

Winkworth

for every step...

winkworth.co.uk



DESCRIPTION:

An exceptional mews-style house enviably located a short stroll to Bounds Green tube station (Piccadilly line) and within easy reach of Bowes Park mainline BR station (to Moorgate). Offered for sale with no onward chain, this stunning property boasts a modern architect-designed interior created to maximise light and space.

The ground floor features an impressive 26'7X14'6 open-plan space showcasing a reception room with patio doors that lead to a decked area and a wired ceiling-mounted speaker system, plus an attractive kitchen with contemporary handleless units, a breakfast bar, and integrated appliances. Both rooms benefit from oakwood flooring with underfloor heating. There is also a cleverly concealed utility cupboard at one end of the reception room and a convenient guest WC off the entrance hall. On the first floor are two spacious double bedrooms, each with high-pitched ceilings and en-suites. The rear bedroom enjoys a wide sliding window with a glass Juliette balcony overlooking the rear garden. The room is also equipped with a remote-controlled skylight, in addition to one over the landing, enhancing the brightness and airflow on the level. Moving outside, you will find a well-maintained 48'6 long rear garden with a brick-built studio/office at one end, as well as a useful shed, whilst at the front of the property is a block-paved patio garden.

SUMMARY:

- Terraced Mews-Style House
- Constructed in 2018
- No Onward Chain
- Located Close to Public Transport Links and Shopping Amenities
- Modern Architect-Designed Interior
- Superb Open-Plan Reception Room and Kitchen
- Two Double Bedrooms with En-suites
- Ground Floor WC
- Well-Maintained Rear Garden with a Studio/Office
- Council Tax: London Borough of Haringey - Band E



Brownlow Road, N11

Approx. Gross Internal Floor Area 978 sq. ft / 90.90 sq. m (Including Studio)

Approx. Gross Internal Floor Area 921 sq. ft / 85.60 sq. m (Excluding Studio)

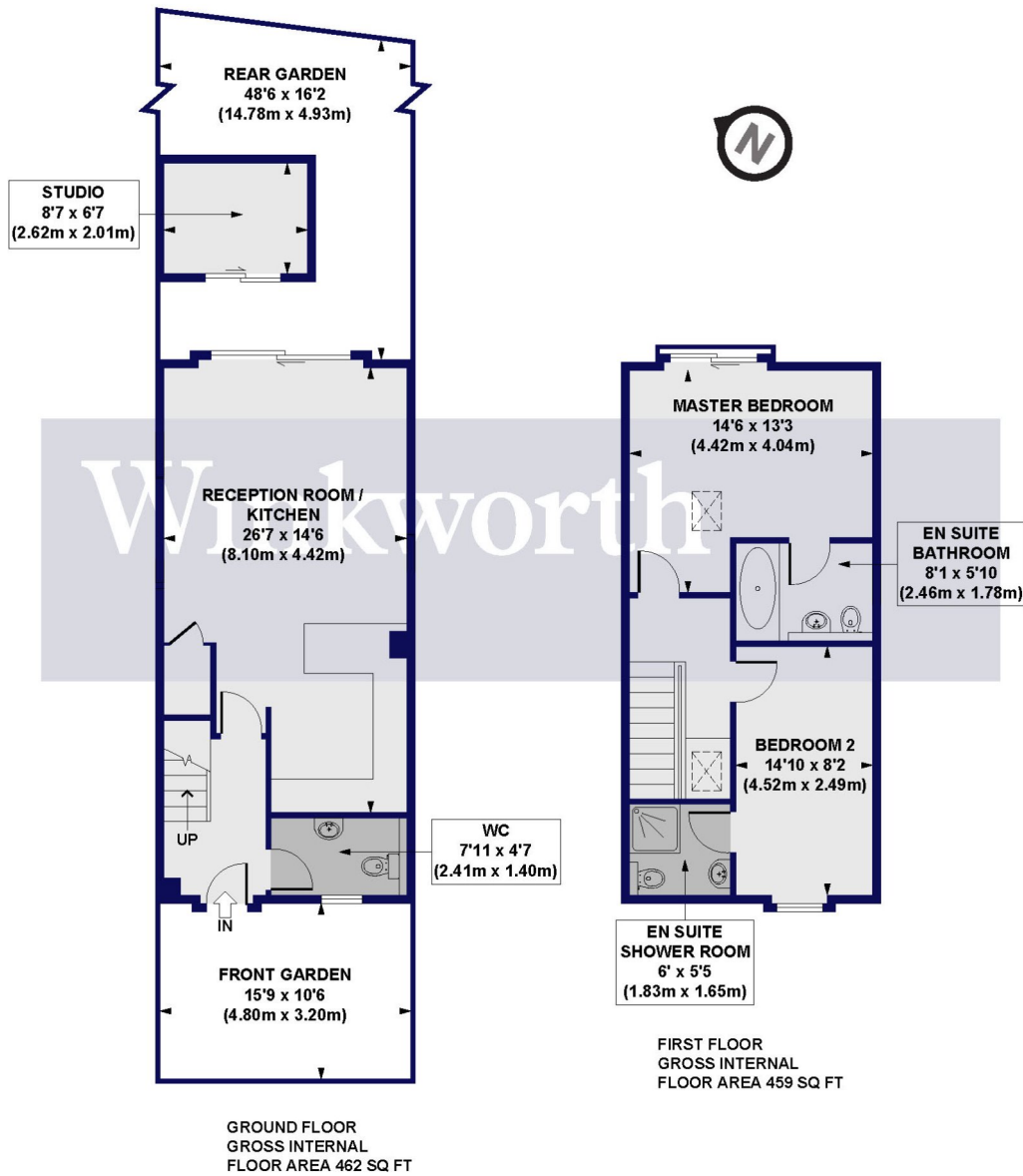

All measurements of walls, doors, windows, fittings and appliances, including their size and location, are shown as standard sizes and do not constitute any warranty or representation by the seller, their agent or CP Creative. Any intending purchaser must satisfy himself by inspection or otherwise as to the correctness of the information contained in these plans.

This floorplan is for illustration purposes only and is not to scale. The position and size of doors, windows, appliances and other features are approximate.

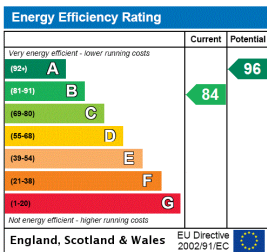

Palmer's Green | 020 8920 9900 | palmer'sgreen@winkworth.co.uk

for every step...

winkworth.co.uk

Winkworth wishes to inform prospective buyers and tenants that these particulars are a guide and act as information only. All our details are given in good faith and believed to be correct at the time of printing but they don't form part of an offer or contract. No Winkworth employee has authority to make or give any representation or warranty in relation to this property. All fixtures and fittings, whether fitted or not are deemed removable by the vendor unless stated otherwise and room sizes are measured between internal wall surfaces, including furnishings.