



MILL CRESCENT, DARTMOUTH
£219,000 FREEHOLD

AN EXCELLENT FIRST HOME OPPORTUNITY.

Dartmouth | 01803 832288 | dartmouth@winkworth.co.uk 3a Market Street, Dartmouth, TQ6 9QE

Winkworth

for every step...

winkworth.co.uk



SUMMARY: A two bedroomed home close to all the amenities.

DIRECTIONS: From the town centre proceed up College Way, passing the Britannia Royal Naval College on your right-hand side. Carry on up College Way with Victoria Road on your left. Then take the next turning right into Old Mill Lane, take the next turning right into Archway Drive. Carry on down and Mill Crescent will be on your left.

DESCRIPTION: Excellent First Home Opportunity! Located at the top of town within walking distance to schools, shops, bus and service station. Pride of ownership is reflected throughout.

- - Beautifully presented
- - Lovely woodland outlook
- - 2 bedrooms
- - Feature gas fireplace in sitting room
- - Rear patio, private suntrap
- - Secure shed with electricity for utilities
- - Low maintenance garden
- - Designated parking space
- - No onward chain, just move on in!

POSTCODE: TQ6 9TA

EPC RATING: C

COUNCIL TAX BAND: C

SERVICES - All mains services are connected.

N.B - This property must be a main residence.





Ground Floor

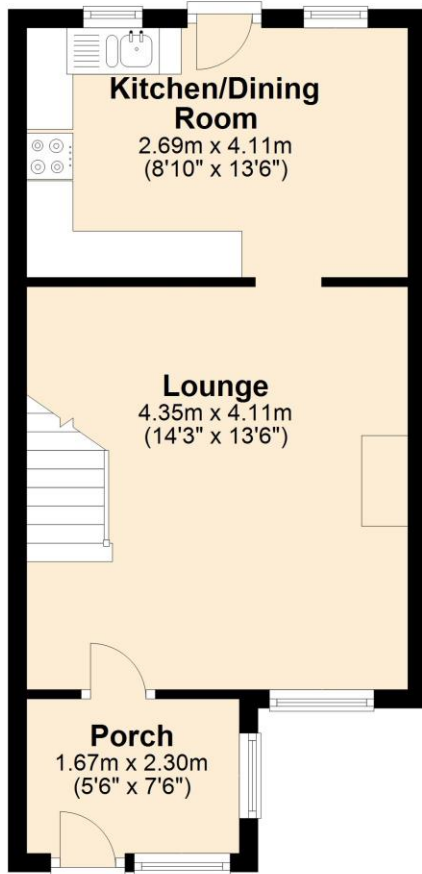

First Floor

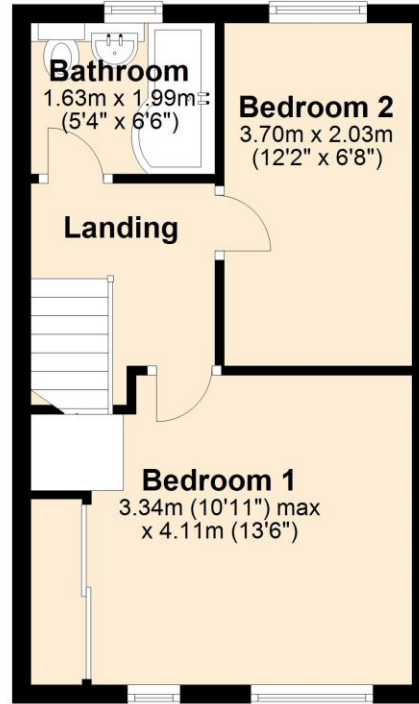

This floorplan is for illustration purposes only and is not to scale. The position and size of doors, windows, appliances and other features are approximate.

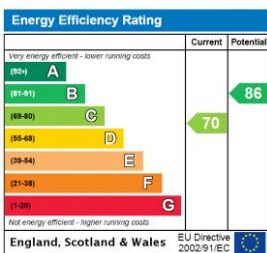

Tenure: Freehold

Council Tax Band: C

Where no figures are shown, we have been unable to ascertain the information. All figures that are shown were correct at the time of printing.

Dartmouth | 01803 832288 | dartmouth@winkworth.co.uk
3a Market Street, Dartmouth, TQ6 9QE

Winkworth

for every step...

winkworth.co.uk

Winkworth wishes to inform prospective buyers and tenants that these particulars are a guide and act as information only. All our details are given in good faith and believed to be correct at the time of printing but they don't form part of an offer or contract. No Winkworth employee has authority to make or give any representation or warranty in relation to this property. All fixtures and fittings, whether fitted or not are deemed removable by the vendor unless stated otherwise and room sizes are measured between internal wall surfaces, including furnishings.